



Eric Adams
Mayor

Ydanis Rodriguez
Commissioner

20240715010007 BAR ITALIA (Roadway)

Please review this application.

DINING OUT NYC

COMMUNITY BOARD RECOMMENDATION FORM

This form is to be used by community boards during the cafe setup review process. Any comments from the community board should be recorded on this form and submitted to NYC DOT. For information pertaining to specific cafe setup design requirements, visit the Dining Out NYC website for program legislation, rules, and Setup Guides.

Business Name: " Bar Italia "

Cafe Setup Address: 768 MADISON AVENUE, NEW YORK, NY, 10065

Application Number: 20240715010007

Recommendation Response Deadline: 9/25/2024

NYCDOT Internal Use Only

Roadway Cafe Setup Comments:

Comments related to the cafe setup's **physical footprint and dimensions**:

Comments related to **pedestrian flow** (i.e., visibility, safety , potential crowding):

Comments related to potential conflicts with **existing curb use** (i.e., planters, bike racks, bus stops):

Overall recommendation for the cafe setup:

Suggested modifications:

Community Board Authorizing Name

Community Board Authorizing Signature

Date



Outdoor Dining Application

Restaurant Details



Food Service Establishment Permit(FSEP)

FSEP#: **41525379** Expiration Date: **09/30/2024**

DOHMH Status: **CURRENT**

Business Legal Name: **768 MAD RESTAURANT LLC**

Assumed Name: **BAR ITALIA**

Business Address: **768 MADISON AVENUE, NEW YORK, NY 10065**

Restaurant Information

Entity Type: **Limited Liability Corporation (LLC)**

Employer Identification Number: **27-2249615**

Phone: **(917) 546-6676**

Email Address: **hello@pb.law**

Emergency Contact Information

First Name: **Hassan**

Last Name: **El Garrahy**

Phone: **(917) 257-6861**

Email Address: **helgarrahy@baritaliamadison.com**

DOS Information

DOS ID#: **3985445**

Process Name: **Bar Italia**

DOS Address: **768 Madison Avenue, New York, New York 10022**

NYS Liquor Authority Information

NYSLA Serial No: **034023137639**

License Type: **On-Premises**

Name of License: **768 Mad Restaurant LLC**

Title of Representative: **Attorney of Record**

Name of Certificate Holder: **768 Mad Restaurant LLC**

User Information

FSEP #

^ [4152537](#)

A

^

[20](#)

Restaurant Details

Food Service Establishment Permit(FSEP)

FSEP#: **41525379** Expiration Date: **09/30/2024**

DOHMH Status: **CURRENT**

Business Legal Name: **768 MAD RESTAURANT LLC**

Assumed Name: **BAR ITALIA**

Business Address: **768 MADISON AVENUE, NEW YORK, NY 10065**

Restaurant Information

Entity Type: **Limited Liability Corporation (LLC)**

Employer Identification Number: **27-2249615**

Phone: **(917) 546-6676**

Email Address: **hello@pb.law**

Emergency Contact Information

First Name: **Hassan**

Last Name: **El Garrahy**

Phone: **(917) 257-6861**

Email Address: **helgarrahy@baritaliamadison.com**

DOS Information

DOS ID#: **3985445**

Process Name: **Bar Italia**

DOS Address: **768 Madison Avenue, New York, New York 10022**

NYS Liquor Authority Information

NYSLA Serial No: **034023137639**

License Type: **On-Premises**

Name of License: **768 Mad Restaurant LLC**

Title of Representative: **Attorney of Record**

Name of Certificate Holder: **768 Mad Restaurant LLC**

User Information

FSEP #

[4152537](#)

A

[20](#)



LUDIVINE

BEAUTÉ 66

ONAVENUE.CO

768
PRIVILEGE





FOR LEASE

We have available space right
located across the street from
Tom Brady
contact us today
0-212-572-3118
tombrady@vcom.com

Douglas
Elliman
REAL ESTATE

ANNE
BARGE

BAR ITALIA

768

BAR ITALIA

770





Grady
0-212-572-3118
Grady@wellsfargo.com

Grady
0-212-572-3118
Grady@wellsfargo.com

768

THIRD FLOOR

FLORA
IN MARCH

ANNE BARGE
NEW YORK

FLAGSHIP RETAIL
OPPORTUNITY

The City of New York
Hudson & York & Lower Hudson
212-405-0121 | www.nyc.gov

No Smoking

LOI
OF PRO

SECTION 1: Site Plan

- This Site Plan form is required to be uploaded in the **“Roadway Site Plan”** field of your online application.
- Refer to the [How to Apply](#) page in the Dining Out NYC website for more information about the application process.

Identify Permitted Parking Location:

- Identify the Parking Sign in front of or around the area where your roadway setup would be located.
 - Roadway cafes can only be placed in:
 1. Parking spaces, which include: metered and non-metered spaces, commercial parking, alternate side parking, angled parking, and seasonally restricted parking.
 2. Loading areas, including loading only, truck loading, hotel loading, and no parking zones.
 3. Floating Parking Lane- a parking lane that is separated from the curb by a protected bicycle lane that is adjacent to the curb.
- P1- Parking Space**

P2- Loading Area

P3- Floating Parking Lane

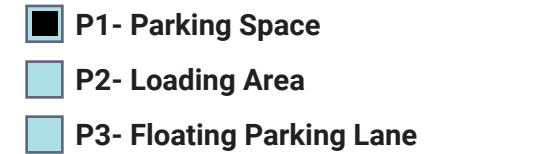

Use the space below to draw or upload your Site Plan representing your cafe perimeters, furniture, and clearances.

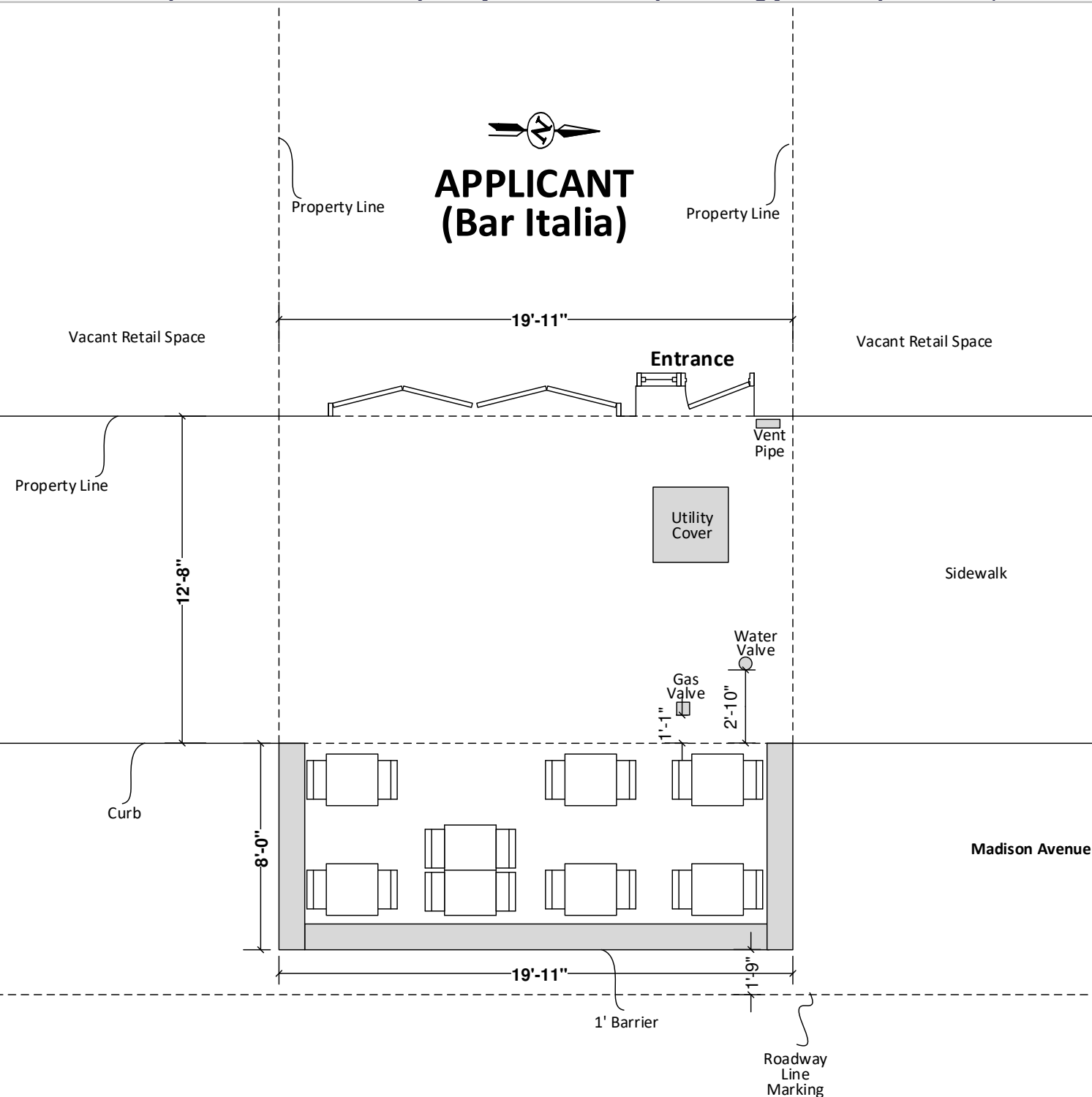

Length of roadway cafe: 19.92 feet

Width of roadway cafe: 8 feet



Roadway Cafe Site Plan Form

Applicant Name: 768 Mad Restaurant LLC

Restaurant Name: Bar Italia

FSEP Number: 41525379

Drawing Requirements

Food service establishment frontage shown by:

- Line representing space occupied in building
- Labels
- Length

Street names:

- Labels on each street

Sidewalk shown as:

- Line representing street curb
- Width measured from building line to curb line

Roadway shown as:

- Lines indicating parking lane
- Width of parking lane

Cafe perimeter shown as:

- Lines indicating perimeter
- Length and width of all three sides

Set-up furniture (tables, chairs, etc.) shown as:

- Lines or symbols at approximate location within setup

Elements or objects shown as:

- Lines or symbols
- Labels
- Distance from cafe perimeter

Utility coverings shown as:

- Symbols representing the approximate shape of the covering within the setup

☐ MANHOLE COVER
☒ UTILITY COVERING

SECTION 2: Required Clearances

- Please provide distances from the following objects.
- Only provide a distance if the listed object is within 15 feet of your proposed setup.
- Leave box blank if not applicable.
- Refer to the [Setup Guides](#) in the Dining Out NYC website for more information regarding clearances.

Elements with minimum 15 feet clearance from roadway cafe:

☐ R01- Subway Stair: Open End

☐ R02- Fire Hydrant

feet

feet

Elements with minimum 10 feet clearance from roadway cafe:

☐ R03- Subway Elevator Entrance

☐ R04- FDNY Curb Cut

☐ R05- MTA Curb Cut

feet

feet

feet

Elements with minimum 5 feet clearance from roadway cafe:

☐ R06- Curb Cut

feet

☐ R11- CitiBike/Bike Share Station

feet

☐ R07- Emergency Exit Hatch

feet

☐ R12- Bike Corral

feet

☐ R08- Subway Stair: Closed End

feet

☐ R13- Micromobility Station

feet

☐ R09- Subway Elevator: Non-Entry

feet

☐ R14- Drainage Infrastructure

feet

☐ R10- Bus Stop Pole:
Non- Approaching Side

feet

Elements with minimum 3 feet clearance from roadway cafe:

☐ R15- Elevated Train Infrastructure

feet

☐ R16- Transformer Vault

feet

Elements with minimum 1 foot and 6 inches clearance from roadway cafe:

☐ R17- Vent Infrastructure

feet

Elements with minimum 6 inches clearance from roadway cafe:

☐ R18- Thermoplastic Marking

feet

Roadway cafe distance from crosswalks:

☐ R19- Adjacent to
non-approaching side of
crosswalk
(min. 8 foot distance)

feet

☒ R20- Adjacent to
approaching (stopping)
side of crosswalk
(min. 20 foot distance)

24

feet

☐ R21- No crosswalk present
(maintain 20 feet from
curb line of intersecting
street)

feet

SECTION 3: Material Requirements

- Please indicate which of the following materials will be part of your roadway cafe by checking the box next to the category. If applicable, please confirm the materials comply with the Dining Out NYC requirements.
- Refer to the [Setup Guides](#) in the Dining Out NYC website for more information regarding materials.

Materials Checklist:

☒ **Barriers**

☒ Maintained on all sides of the cafe except the side fronting the ground floor restaurant.

☒ Not permanently affixed to the roadway.

☒ 30-42 inches tall (excluding planting), and at least 4 inches in width.

☒ Barriers are interconnected with each other.

☒ Any cladding over the barriers is securely fastened or affixed.

☒ Minimum 4 inches wide reflective strip on each barrier on the outward facing side.

☒ Water-filled with a minimum of 150 pounds per linear foot of barrier length.

☐ If your proposed barriers will utilize fill materials other than water please check this box. This may require additional information from the applicant and further review by the Dining Out NYC team, as well as supporting DOT units and City agencies.

☐ **Flooring**

☐ Durable, lightweight, easily removable, mold-resistant, elevated from the ground level to allow for drainage, and removable to allow for cleaning.

☐ Flush with the curb line (except if located on a slope, be flush to the greatest extent feasible), and compliant with applicable accessibility requirements.

☐ Maintains a 6 inch covered channel between curb and base of flooring to allow for drainage.

☐ **Furnishings**

☐ Lightweight and easily movable.

☐ **Vertical Screenings**

☐ Located between the barrier and 6 feet above the cafe base or floor.

☐ Located on the roadway facing side, does not extend the beyond the perimeter of the roadway cafe, and is not affixed to the outward facing side of barriers.

☐ Easily removable, comprised of non-opaque, fire-grade, and wind resistant materials.

☐ If within 50 feet of any regulatory or warning signs, does not exceed 46 inches in height.

☐ **Overhead Coverings/ Umbrellas**

☐ Minimum of 7 feet and maximum of 10 feet from the base or floor of the roadway cafe.

☐ Has a weighted base and any support structures are not affixed to the outward facing side of barriers, are of sufficient size and strength, made of durable materials, and free of defects.

☐ Easily removable, comprised of fire-grade and wind resistant materials.

☐ If within 50 feet of any regulatory or warning signs, does not exceed 46 inches in height.

☐ **Lighting and Electrical Connections**

☐ Any lighting is outdoor rated, properly secured, and lightweight.

☐ At least 14 feet above sidewalk, and 18 feet above roadway.

☐ Not attached to any City property, including street trees.

☐ Electrical work complies with the applicable requirements set forth in the DOT's rules and the New York City Electrical Code.

☐ Please check this box if you are submitting additional documents for review. Documents may include technical drawings prepared by a licensed professional.

2