



Saint Catherine's Park Safety Surface Replacement

Located on First Avenue between East 67th and east 68th Streets,
in the Borough of Manhattan

Community Review 8 Review
June 9, 2020
Christopher M. Crowley, RLA

Total Budget: \$ 590,000
City Council Member. Ben Kallos , District 5 - \$590,000 FY20

Project Size: .5 acres

Parks

Goals

- Replace deteriorated safety surface and asphalt base
- Install a new tot swing to meet current code
- Replace deteriorated spray shower pavement if funding allows



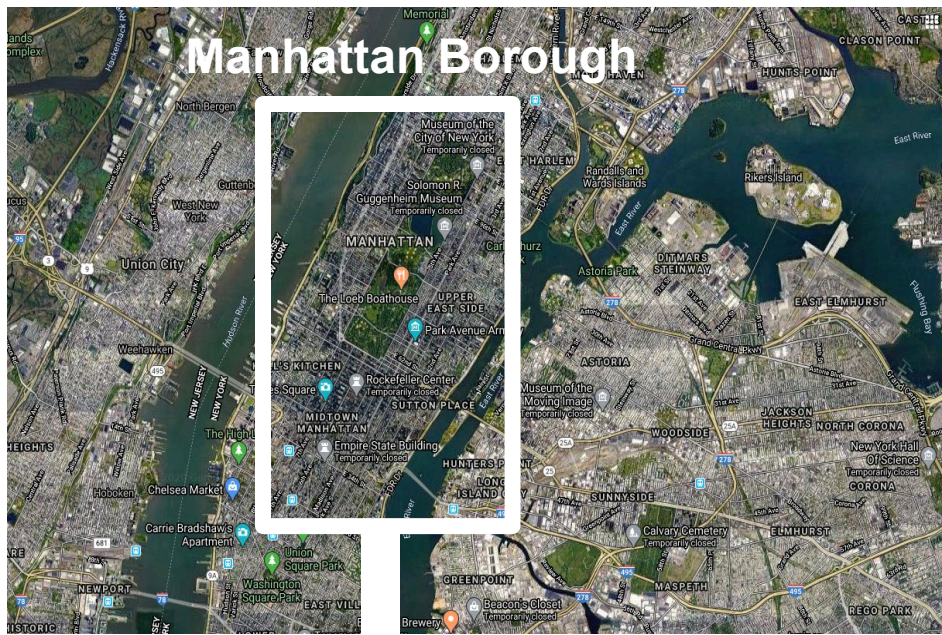

Manhattan Borough

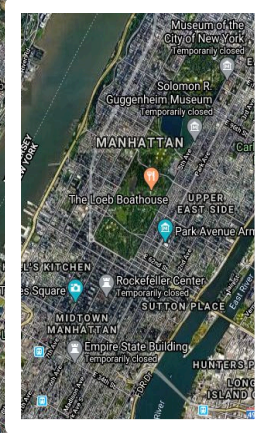

City

NTS



Upper East Side

Neighborhood

NTS



Saint Catherine's Park

Site

NTS



Saint Catherine's Park | Project Location

NYC Parks



Flood Hazard Zones

2015 Preliminary 100-year Floodplain

1% Annual Chance Floodplain (100 Year Floodplain) The area that has a 1% chance of flooding in any given year.

2050s Projected 100-year Floodplain

The potential areas that could be impacted by the 100-Year flood in the 2050s based on projections of the high-estimate 90th percentile sea level rise scenario (NYC Panel on Climate Change (NPCC) 2015 data).



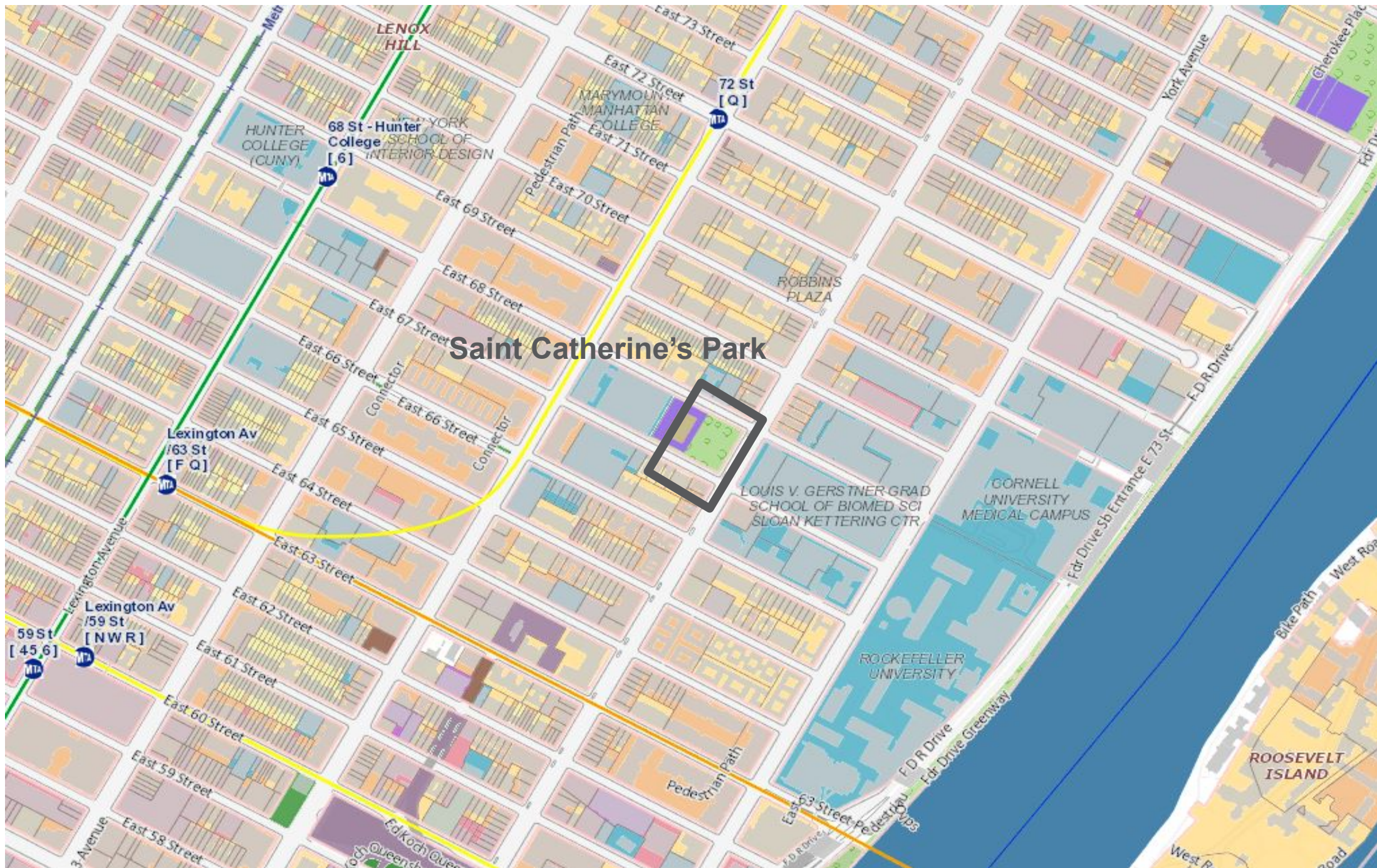

Land Use Categories

- 1 And 2 Family Residential
- Multi-Family Residential
- Mixed Use
- Open Space And Outdoor Recreation
- Commercial
- Institutional
- Industrial
- Parking
- Transportation / Utilities
- Vacant Lots



Saint Catherine's Park | Surrounding Land Use

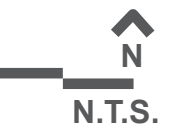

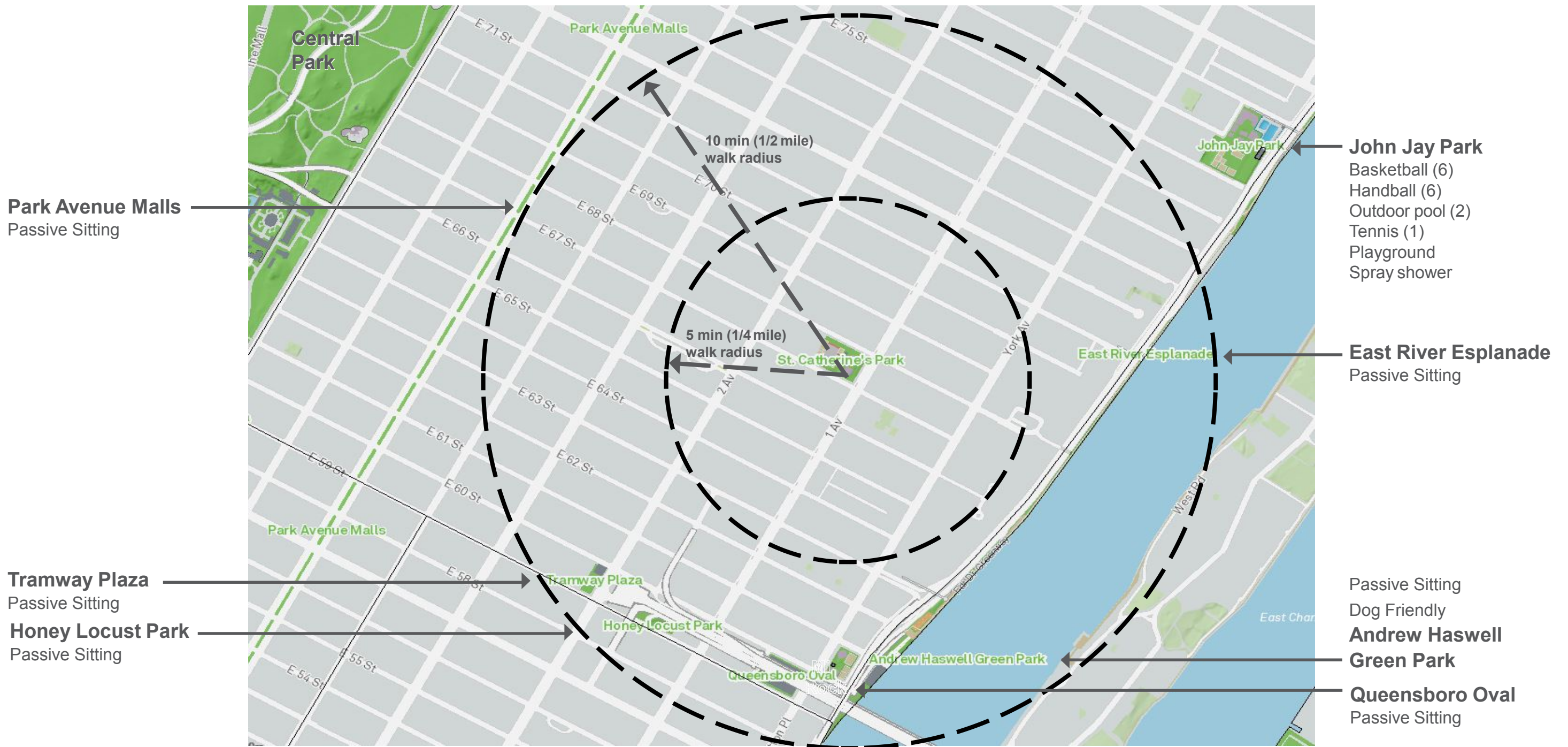

NYC Parks

Saint Catherine's Park | Neighboring Parkland

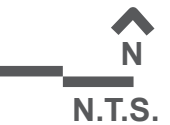



PRIMARY WORK AREA



NYC Parks

Saint Catherine's Park | Full Site Aerial

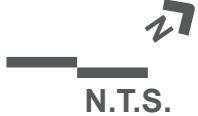

N.T.S.

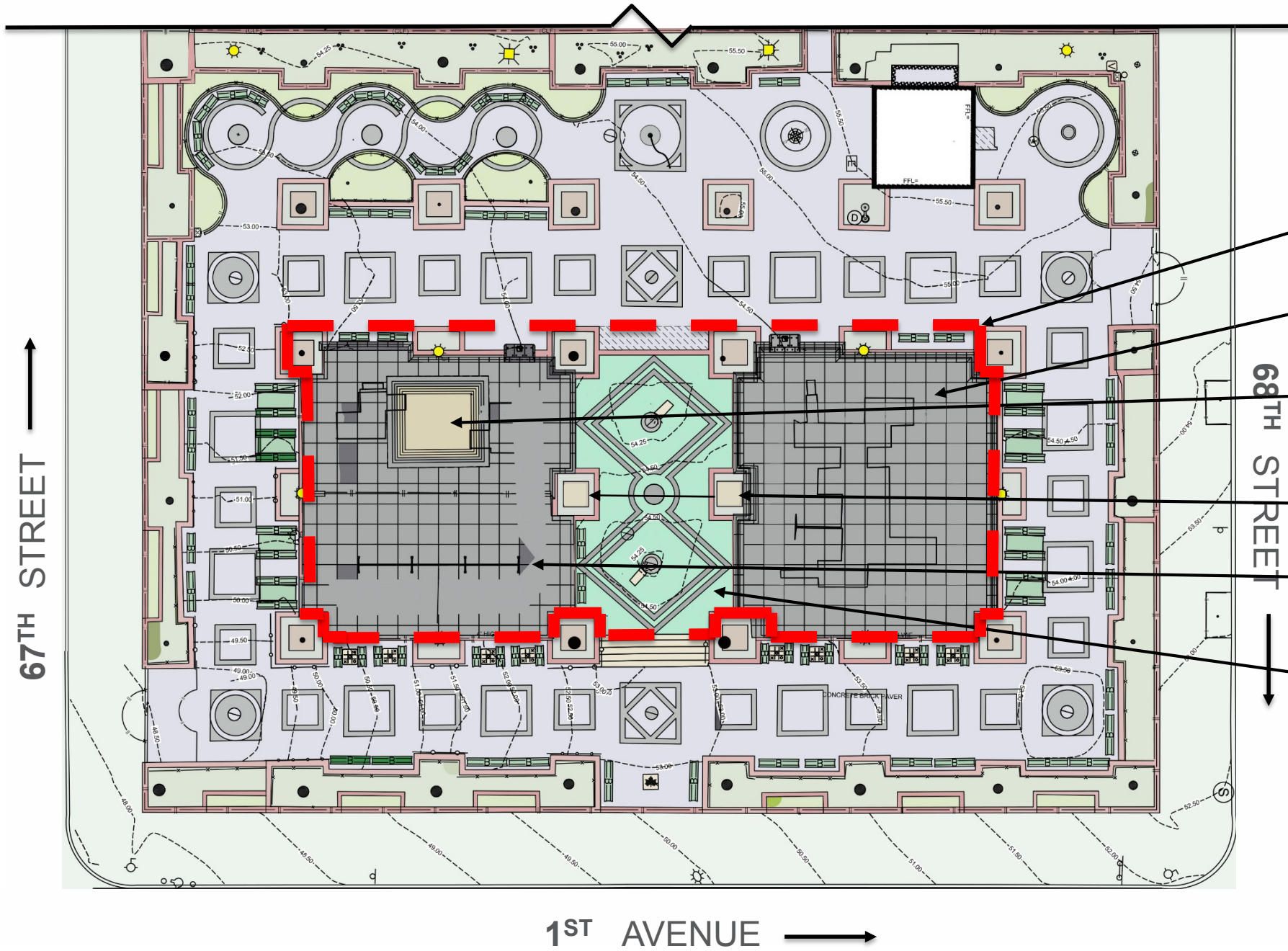

- PRIMARY WORK AREA
- SAFETY SURFACE:
POOR CONDITION
- SAND BOX:
INSUFFICIENT SAND
- TWO MISSING TREES
- 8'-0" TOT SWING:
INSUFFICIENT FALL ZONE
- COLORED CONCRETE SPRAY AREA:
POOR CONDITION





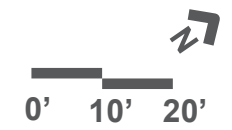

Saint Catherine's Park | Existing Conditions



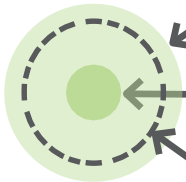

Legend

-  Canopy
-  Structural Root Zone
-  Critical Root Zone
-  Stump Removal
-  Primary Work Area



Saint Catherine's Park | Tree Inventory

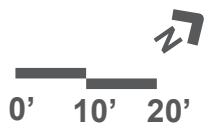



1) 5-12 Year-Old Play Area, Looking North



2) 5-12 Year-Old Play Area, Looking West



NYC Parks

Saint Catherine's Park | Existing Conditions - Photos

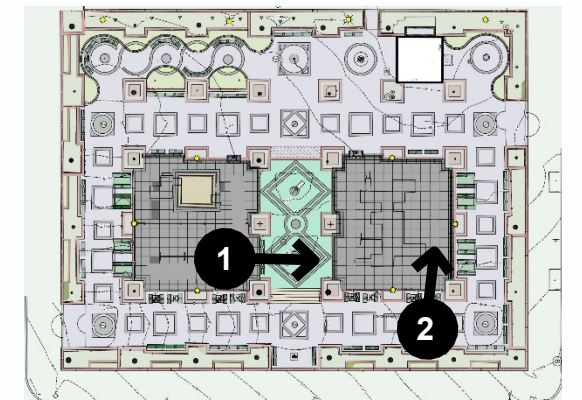



1) 2-5 Year-Old Play Area, Looking North



2) 2-5 Year-Old Play Area Looking West

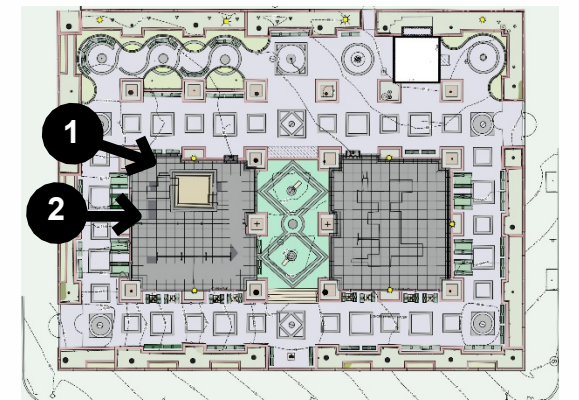



1) Tot Swing



2) Tree Pit in Spray Area

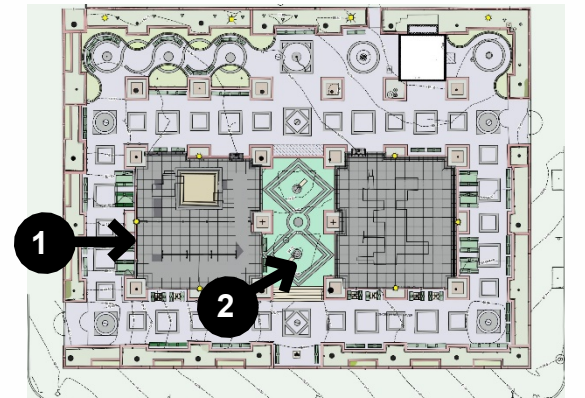

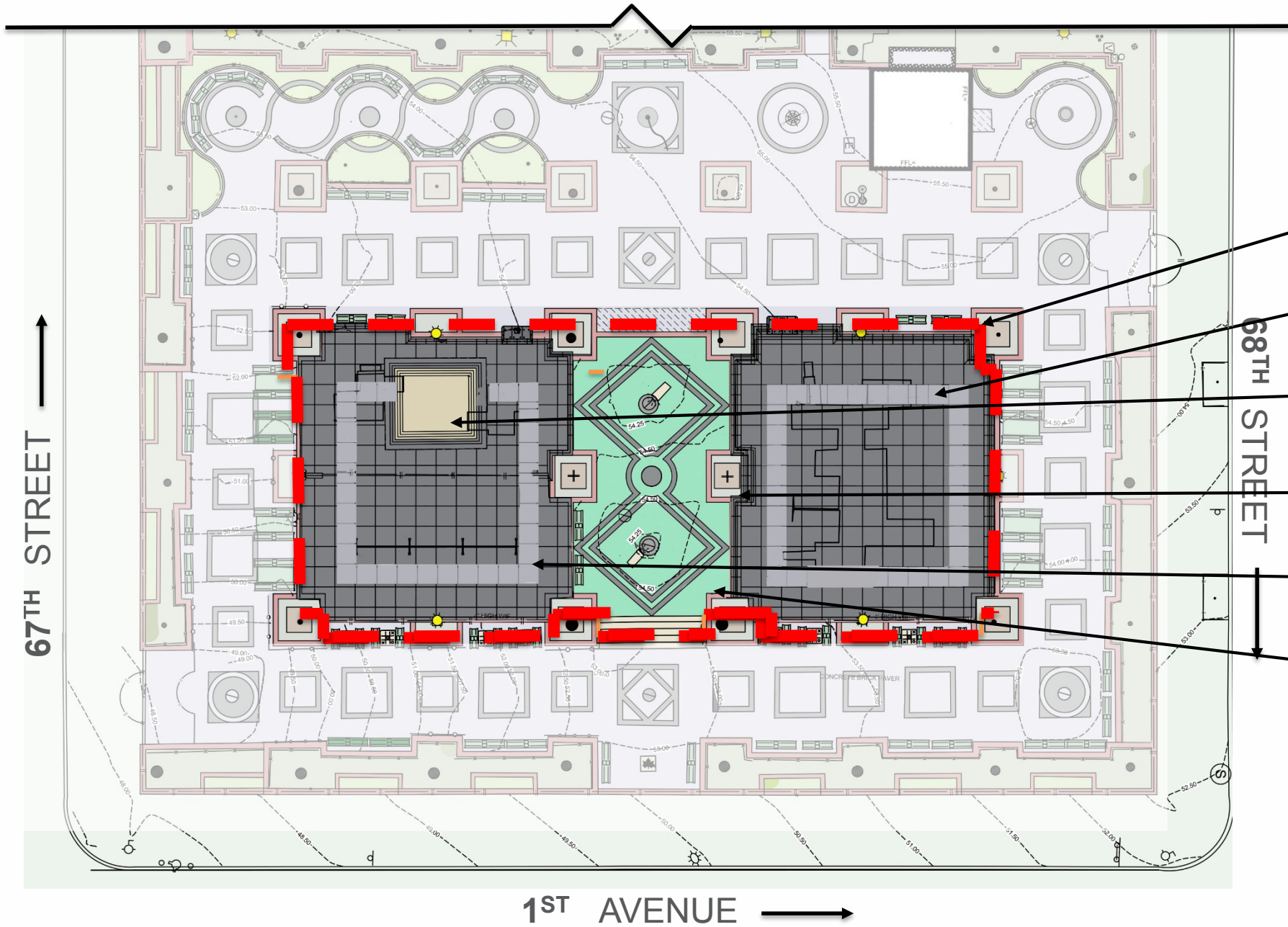

- PRIMARY WORK AREA
- NEW SAFETY SURFACE
- NEW SAND
- NEW TREES (2)
- NEW 7'-0" TOT SWING
- NEW COLORED CONCRETE SPRAY PLAZA (ADD ALT)



Saint Catherine's Park | Schematic Design

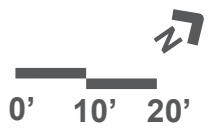



7'-0" Swing Conforming to Existing Play Units





Grey

Black

Safety Surface



Mineral Bronze

Wine Red

Swings (Color to Match Existing Play Units)



Acacia Green

Charcoal Grey

Color Concrete (Add Alt)



Big Belly Trash Receptacles



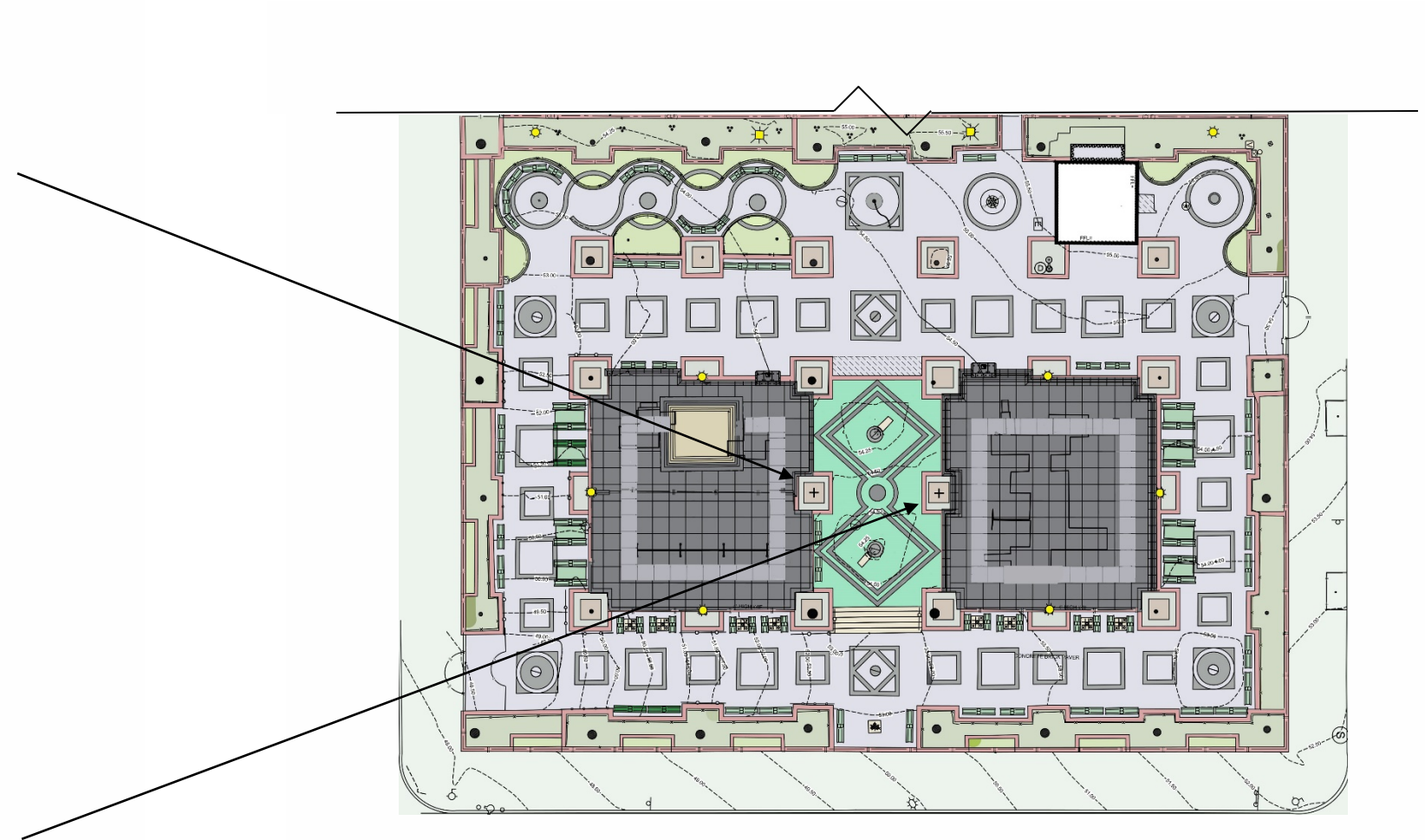

Platanus occidentalis, American Sycamore Tree



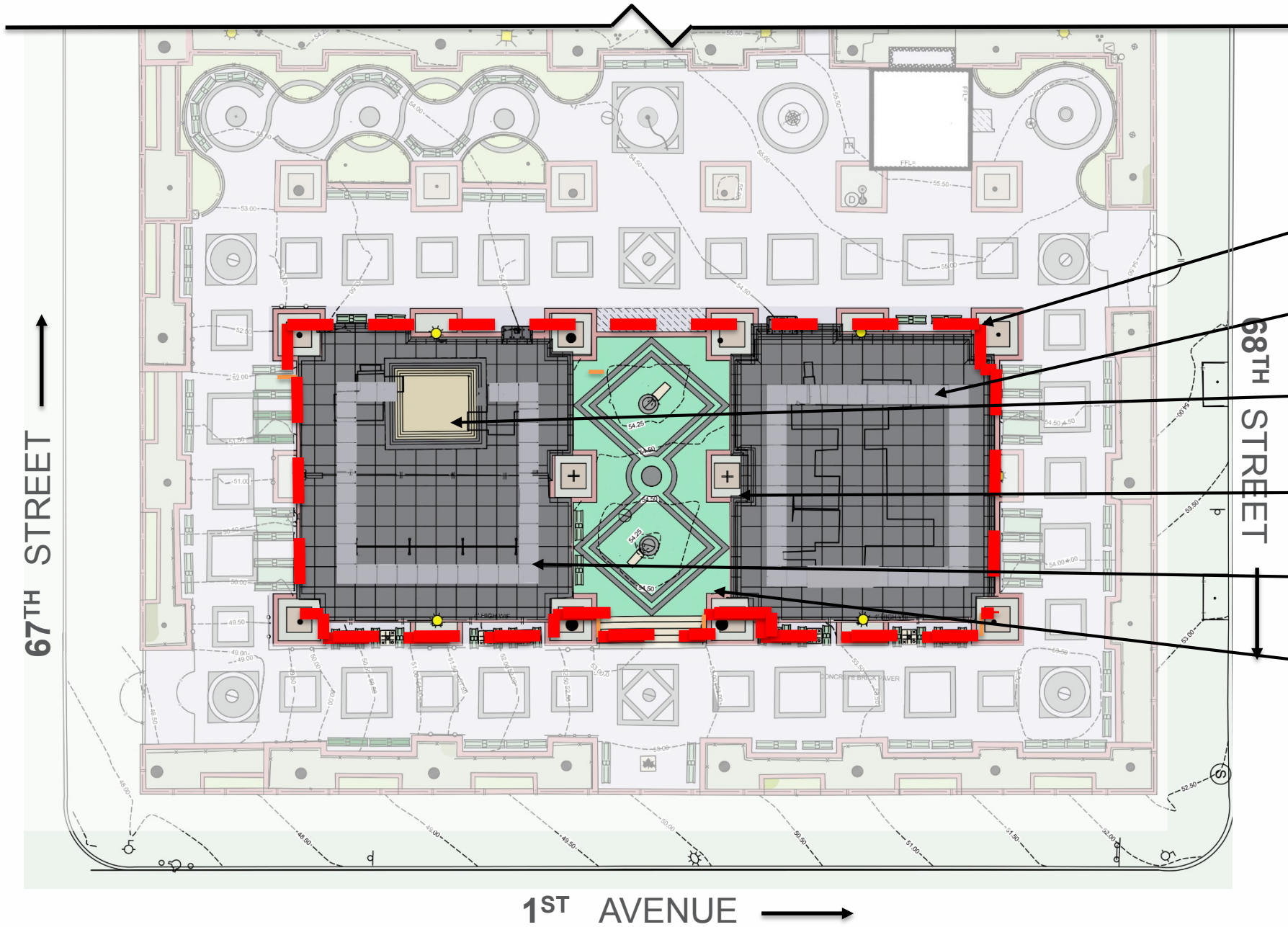

- PRIMARY WORK AREA
- NEW SAFETY SURFACE
- NEW SAND
- NEW TREES (2)
- NEW 7'-0" TOT SWING
- NEW COLORED CONCRETE SPRAY PLAZA (ADD ALT)



Saint Catherine's Park | Schematic Design

