

Lenox Hill Hospital Redevelopment Project

March 2019





Lenox Hill Hospital: Serving New York City for Over 160 Years

Northwell Health in New York City – Prior to 2010

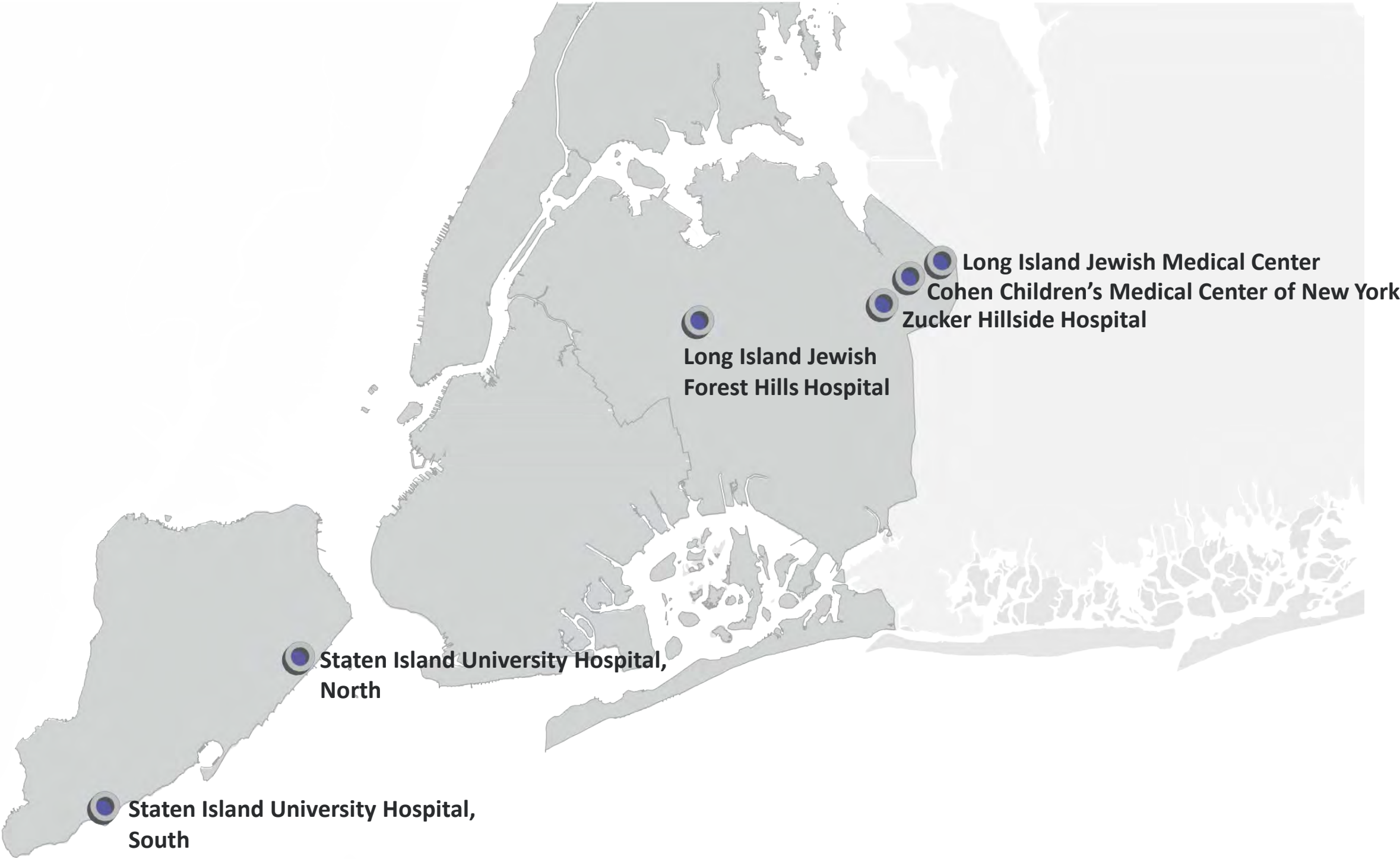

Northwell Health in New York City – Today

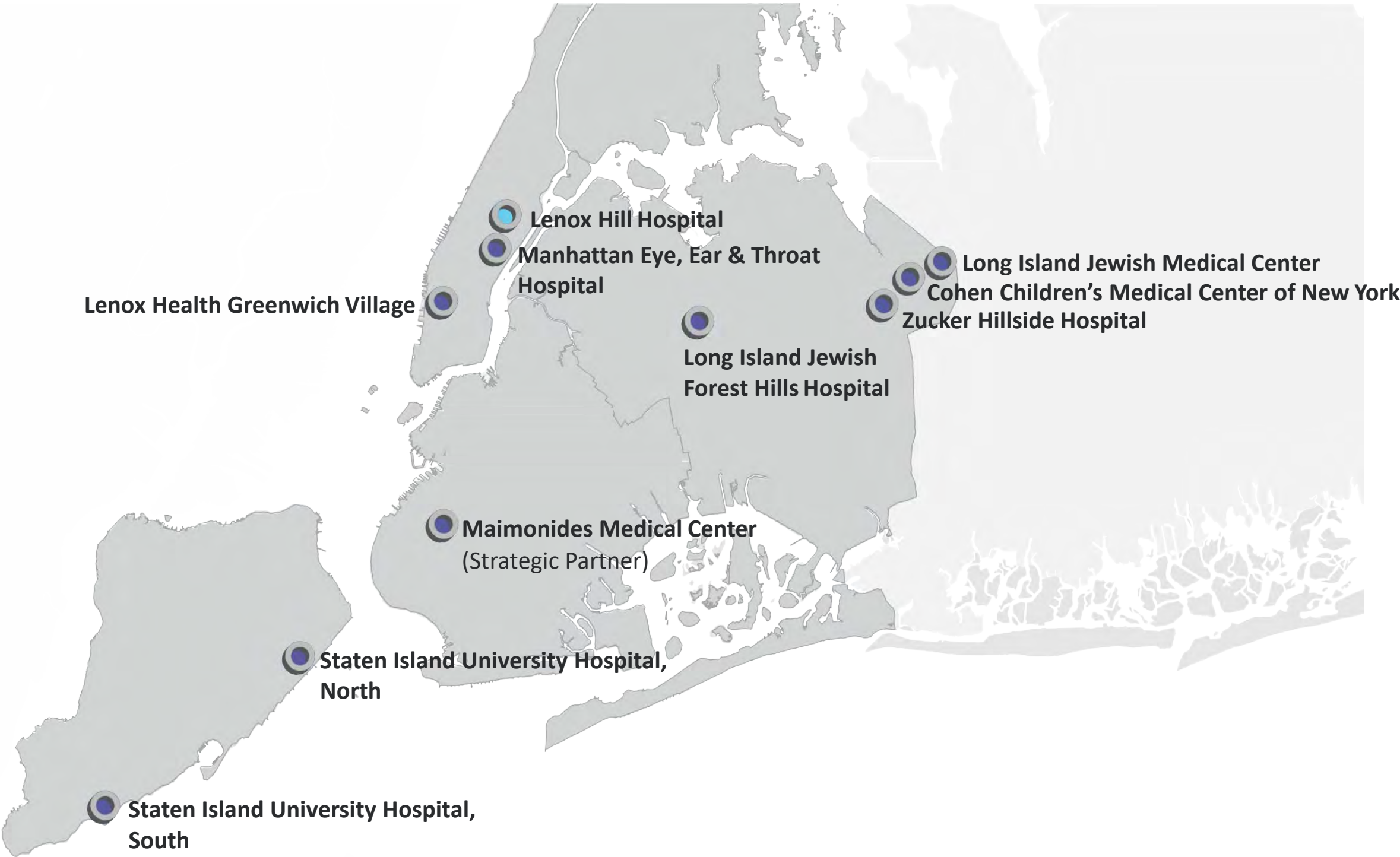

We take care of New York City

8 Hospitals

- Lenox Hill Hospital, Manhattan
- Long Island Jewish Medical Center, Queens
- Cohen Children’s Medical Center, Queens
- Zucker Hillside Hospital, Queens
- Forest Hills, Queens
- Staten Island University Hospital North, Staten Island
- Staten Island University Hospital South, Staten Island
- Maimonides Medical Center, Brooklyn – *Strategic Partner*

1 Specialty Hospital

- Manhattan Eye, Ear & Throat Hospital (MEETH), Manhattan

1 Freestanding Emergency Department

- Lenox Health Greenwich Village, Manhattan

17 Urgent Care Centers

142 Ambulatory and Physician Practices

40 Ambulances and Emergency Response Units

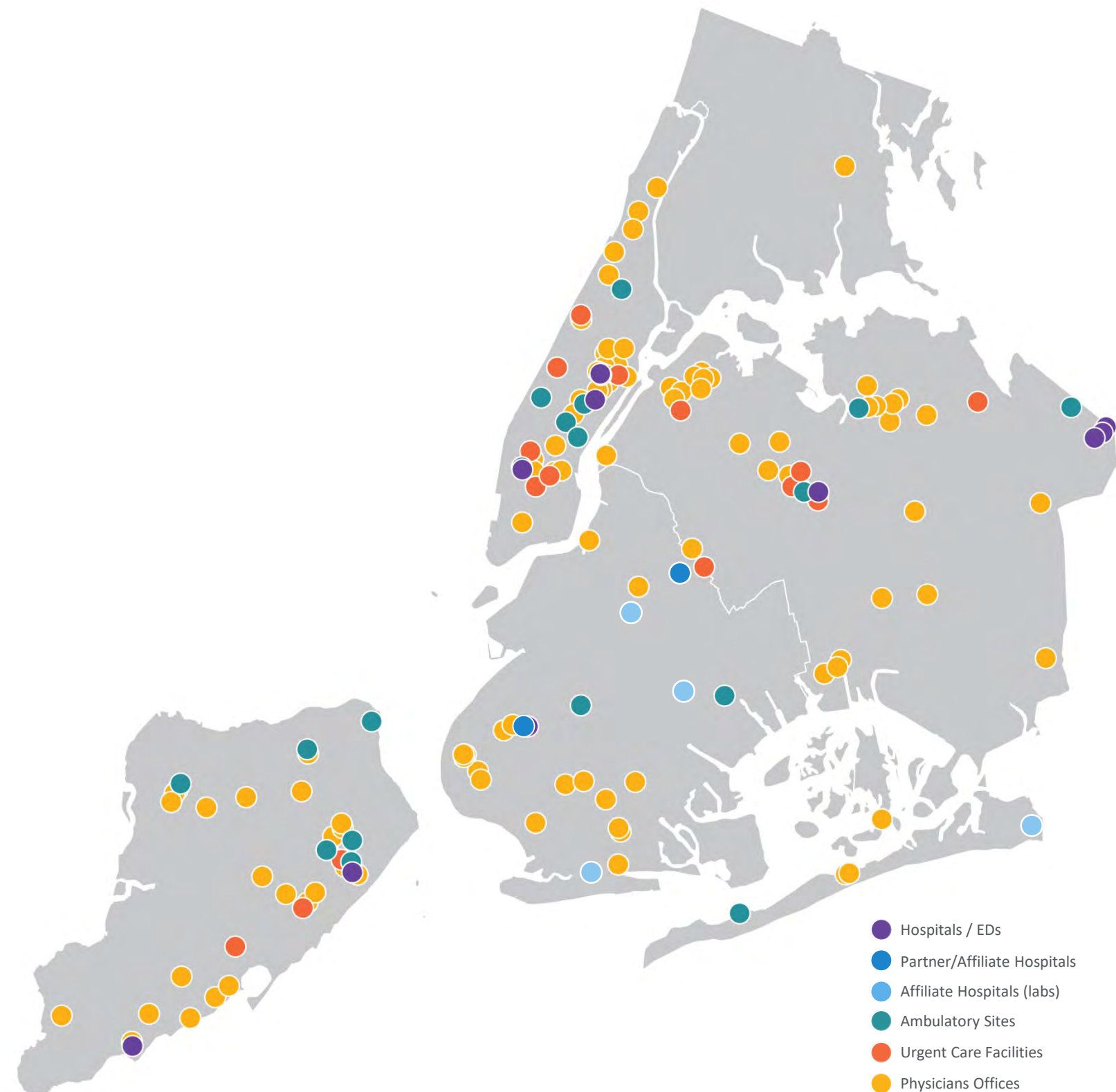

Our hospitals care for New York City residents

NYC Resident Discharges (2017)
Source: SPARCS

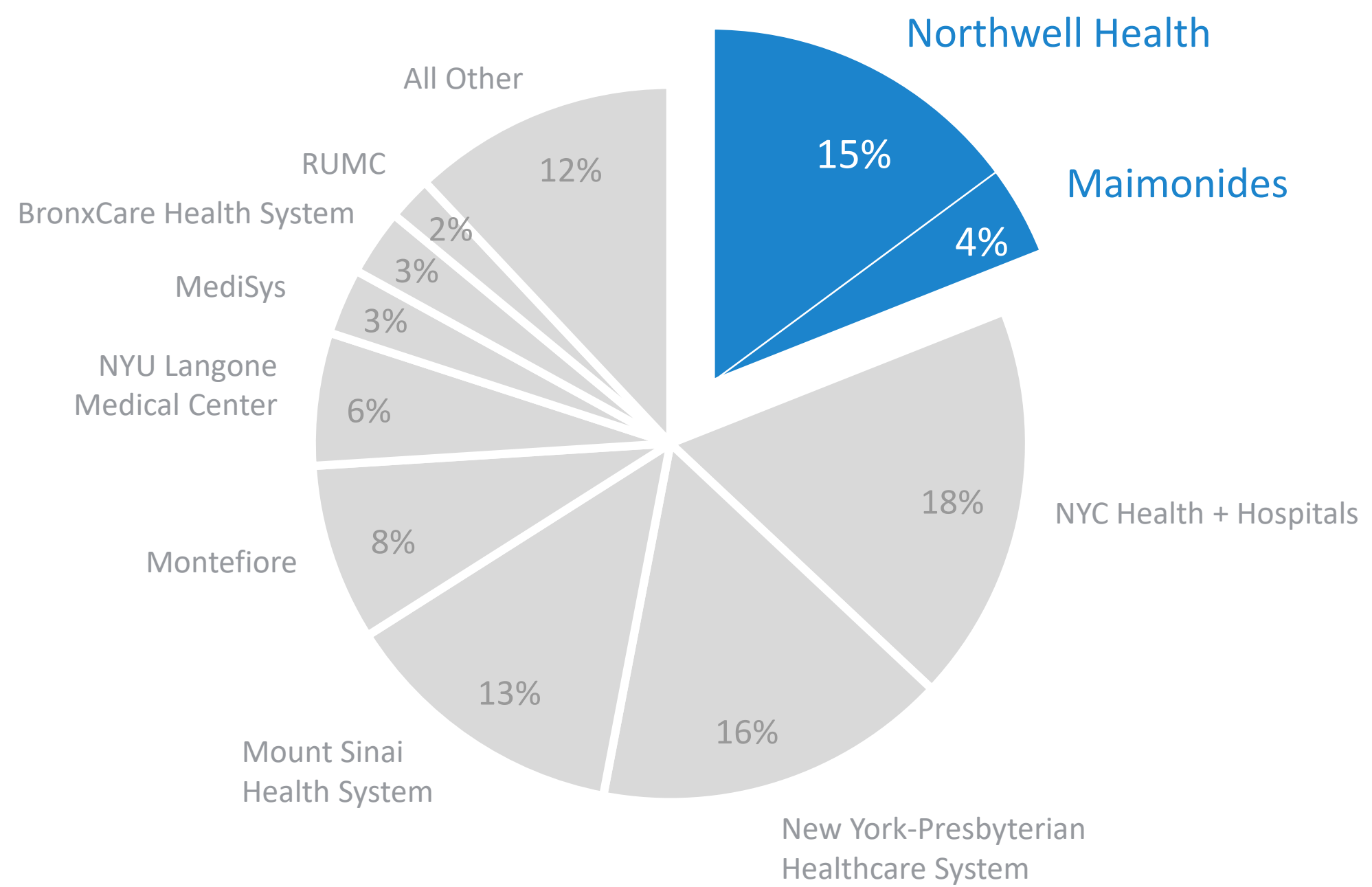

Our employees are part of the communities we serve

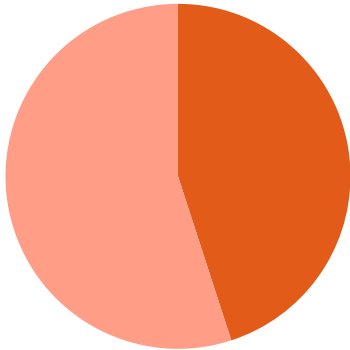

**45% of workforce
lives or works in NYC**

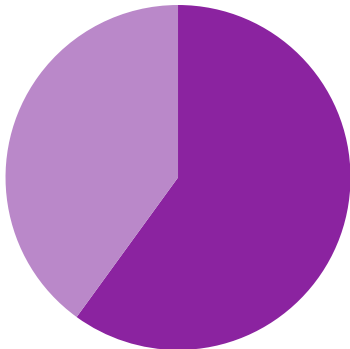

60% Minority*

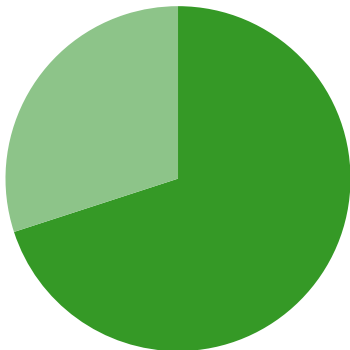

70% Women*

68,000
Total Northwell Employees

* Employees that live or work in NYC

Lenox Hill Hospital: Over a Century and a Half of Innovation

- 1857 Community leaders recognized the need for [medical services for the immigrant community](#) and together found the German Dispensary
- 1887 Four young German-American women form a [Nurses' Training School class](#)
- 1907 First [physical therapy department](#) in the U.S
- 1908 First [tuberculosis division](#) in New York City
- 1938 First [angiocardiography](#) in the country performed
- 1955 One of the first hospitals in the City to open a [cardiac catheterization laboratory](#)
- 1957 One of the first [intensive care](#) units in New York City
- 1967 First [cardiac care](#) unit in the New York metropolitan area
- 1978 First [angioplasty](#) procedure in the U.S.
- 1989 First [Lyme Disease Center](#) in New York City
- 1991 First [coronary stent](#) in New York City
- 2000 One of the first hospitals in the US to acquire a state of the art [robotic cardiac system](#) for minimally invasive heart bypass surgery
- 2003 First FDA approved [drug coated stent implanted](#)
- 2009 First totally endoscopic [robotic coronary artery bypass on a beating heart](#)

Lenox Hill Hospital Today

- Regionally ranked by US News and World Reports
- New York Magazine Top Doctors: 70 at Lenox and MEETH
- More than 163,000 patients treated annually
- 3,892 deliveries in 2018
- 55,906 Emergency Room visits in 2018

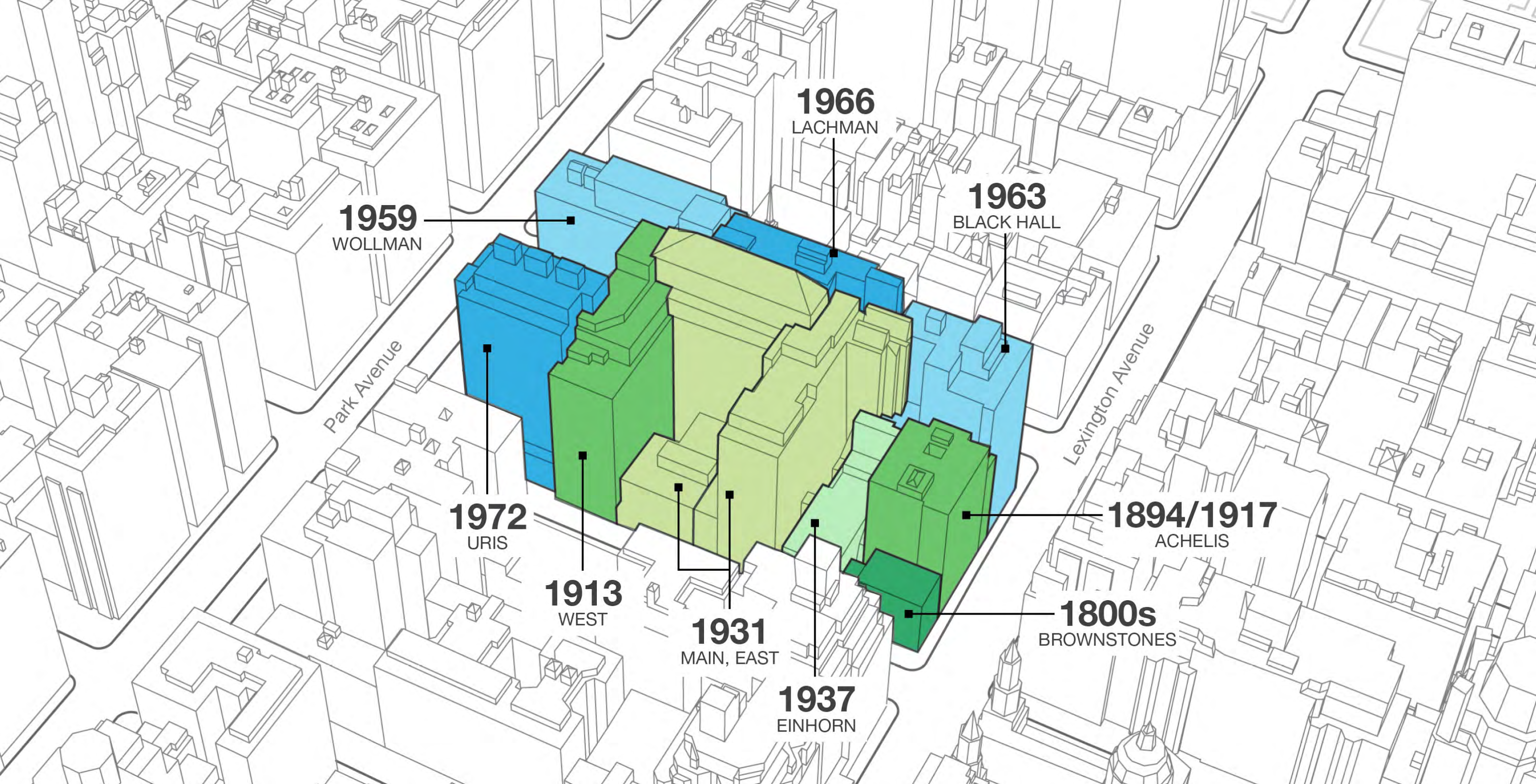

History of Lenox Hill Hospital Growth

Hospital Needs: Upgraded Patient Rooms

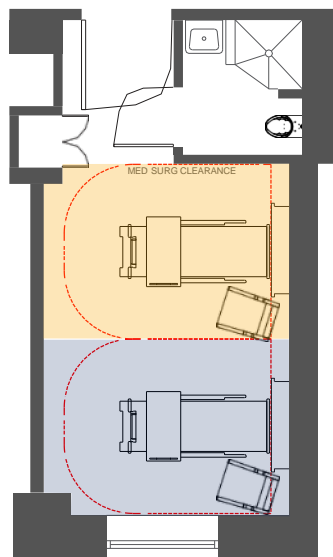

Existing Patient Room

- Double occupancy
- Increased risk of infection
- Not designed to current code
- No caregiver zone
- No family space

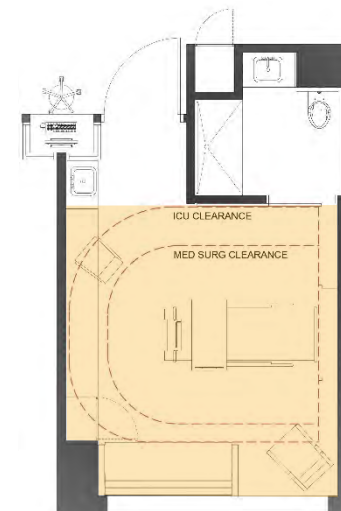

Industry Standard Patient Room

- Single occupancy
- Caregiver zone
- Family space
- Patient confidentiality

Hospital Needs: Upgraded Operating Room Suites

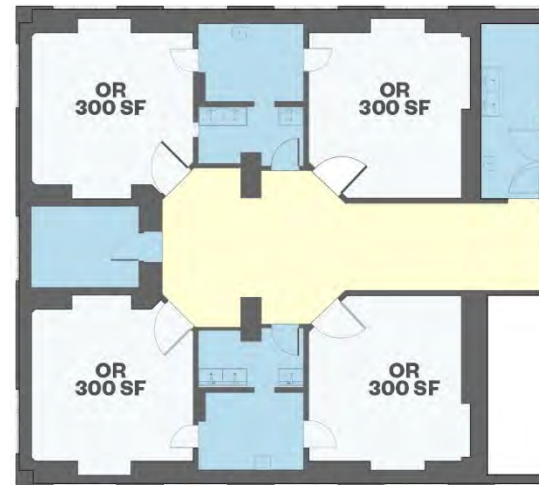

Existing OR Suite

(with circulation and support)

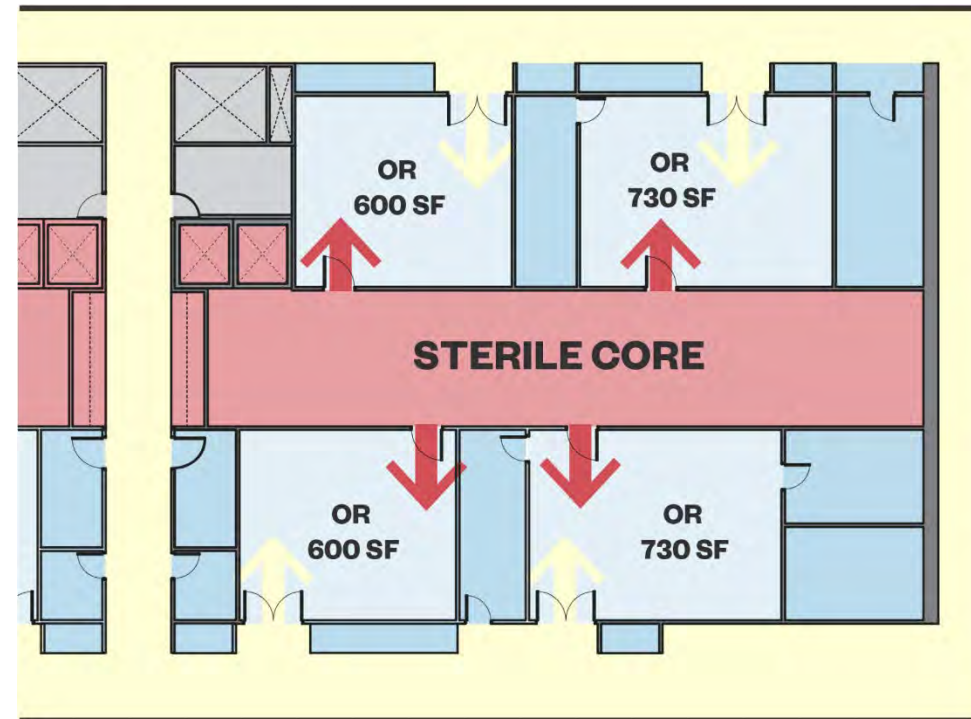

Industry Standard OR Suite

(with circulation and support)

- Separation of restricted circulation
- Dedicated path for sterile supplies
- Rooms sized to support image-guided procedures and robotics
- Control rooms and dedicated space for IT equipment

Hospital Needs: Upgraded Emergency Department

- Individual patient rooms will enhance patient experience and infection control
- Private individual rooms for patients requiring a longer evaluation period
- Increase in patient treatment spaces to meet growing need for emergency medical services on the Upper East Side



Hospital Needs: Ambulance Drop-off



Hospital Needs: Dedicated Mother-Baby Hospital

- Separate entrance, lobby, and dedicated elevators will provide a quick and private path for mothers in labor
- Enlarged single-patient post-partum care rooms will support 24-hour visitation and couplet care
- Private NICU rooms will enable families to be with their newborn throughout care



Lenox Hill Hospital Redevelopment: Project Overview

- State-of-the-art patient rooms, operating rooms, and emergency department
- New Mother-Baby Hospital with dedicated Park Avenue entrance
- Off-street ambulance bays and loading docks
- Atrium and other publicly-accessible space for engagement and education
- Subway station improvements
- Operational hospital throughout construction
- Portion of Park Avenue for new residential to support hospital redevelopment

Hospital Program

Space	Existing	Proposed	% Change
Beds:	450	475	+ 6%
<i>Private</i>	<i>136</i>	<i>444</i>	
<i>Semi-Private</i>	<i>286</i>	<i>---</i>	
<i>NICU</i>	<i>28</i>	<i>31</i>	
Operating Rooms	25	30	+ 20%
Procedure Rooms	14	14	0%
ED Treatment Positions	34	72	+ 112%
ED Critical Decision Unit	0	10	+ 100%
Labor & Delivery Rooms	11	15	+ 36%

Site Plan



Site Section

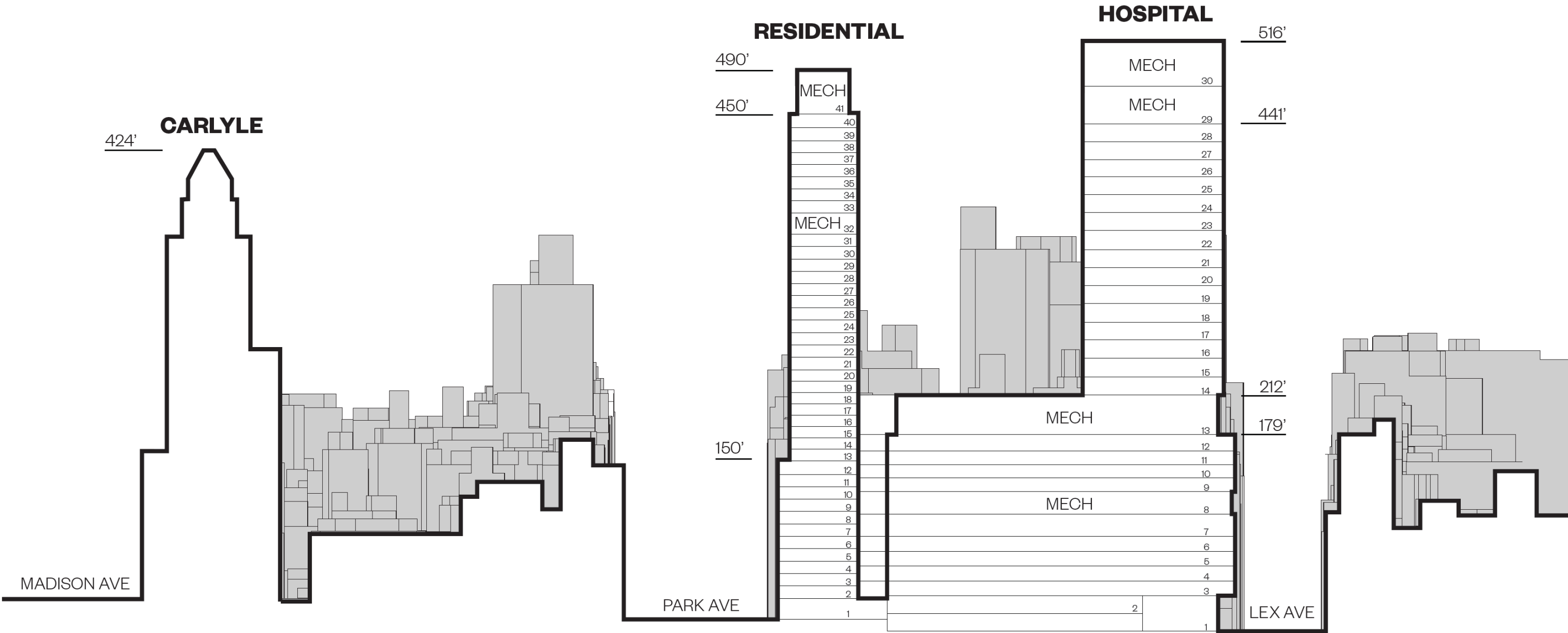

Illustrative Rendering



Illustrative Hospital Stacking Plan

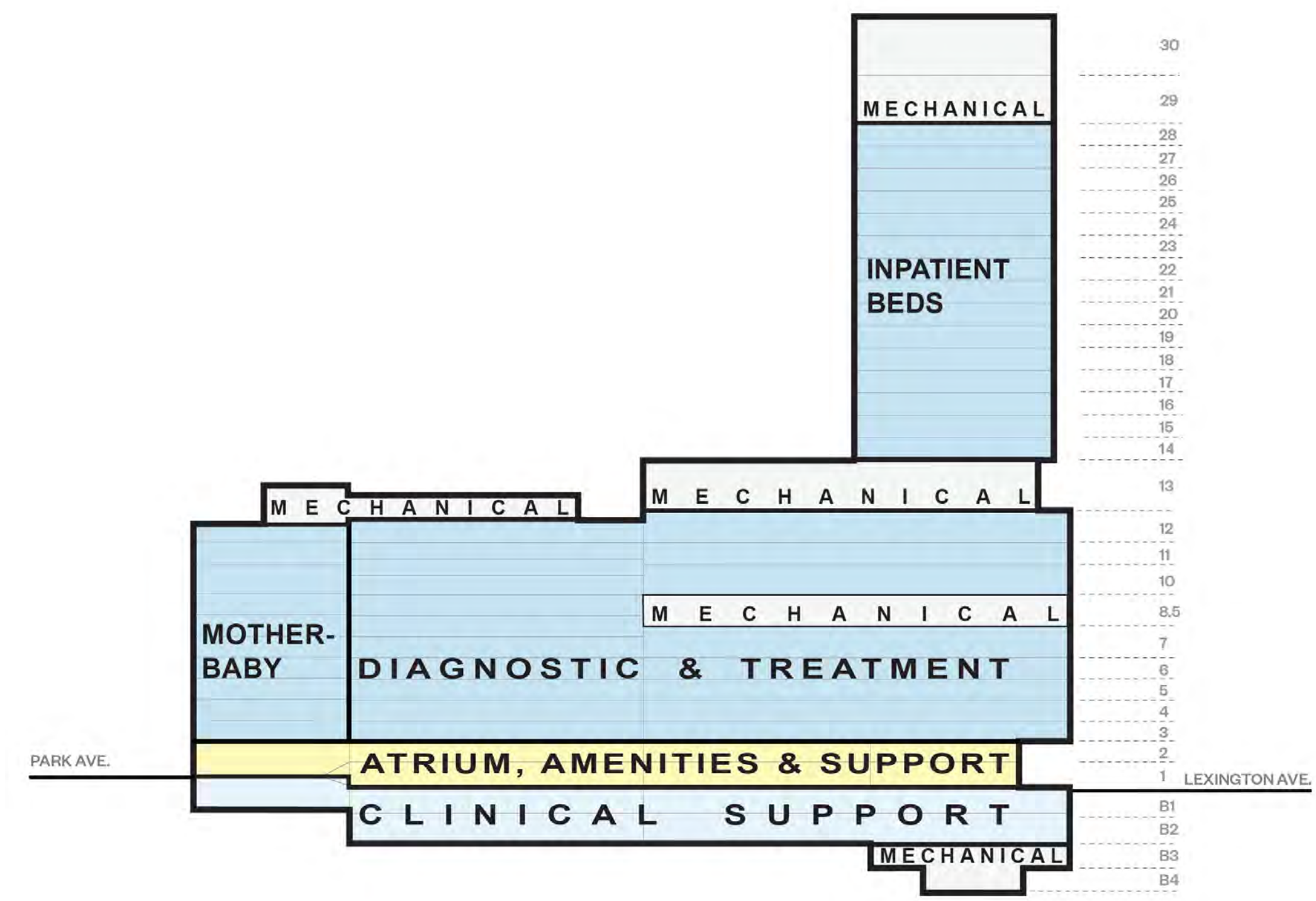

Ground Floor Plan

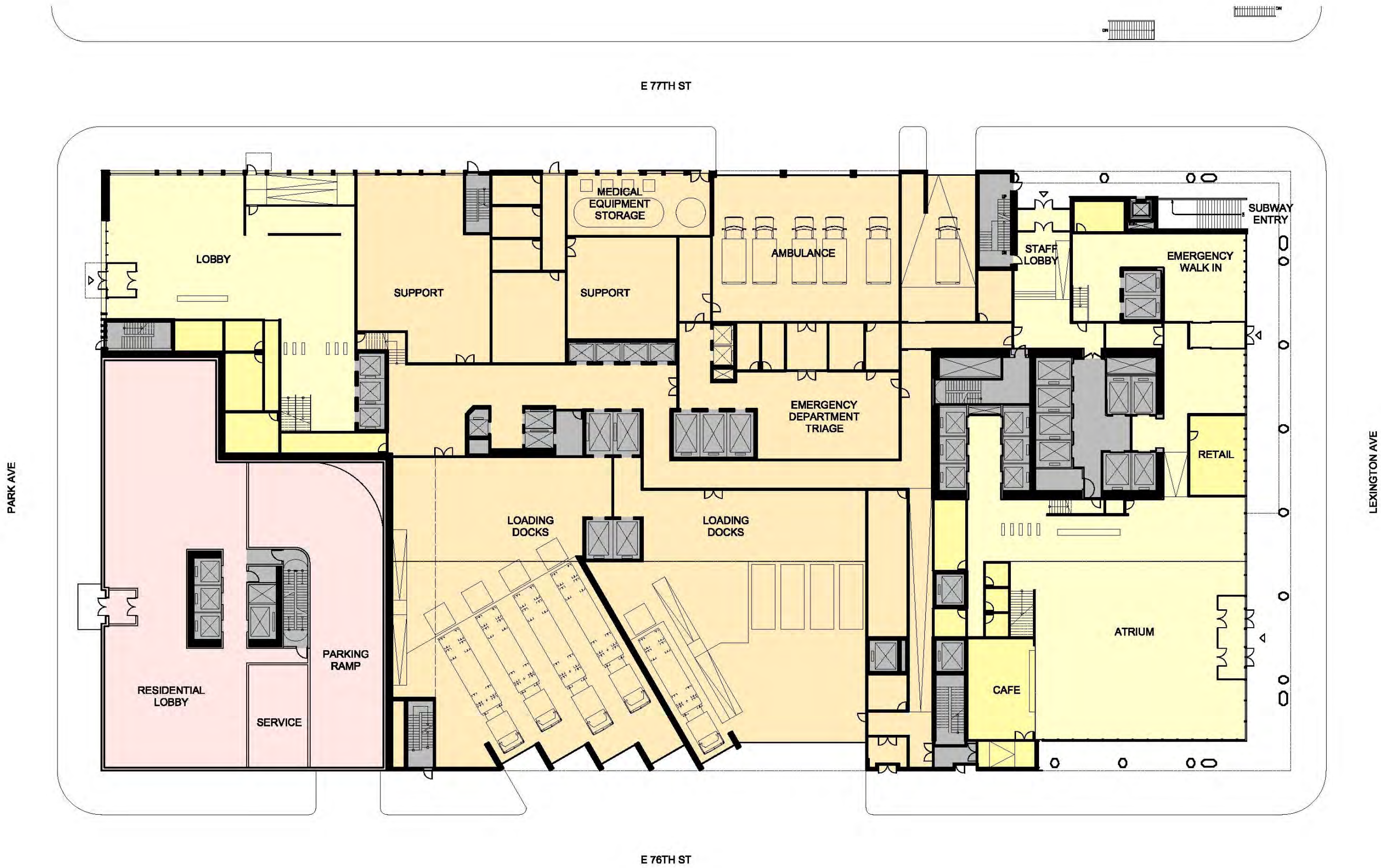

Second Floor Plan







Lexington Avenue @ 76th Street



Existing

Proposed

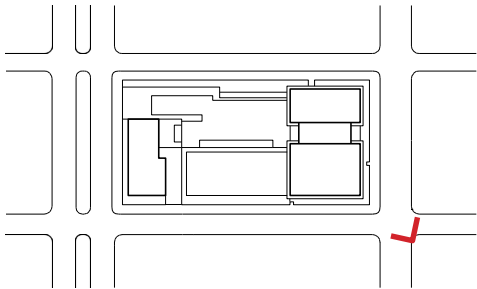

Lexington Avenue @ 77th Street



Existing



Proposed

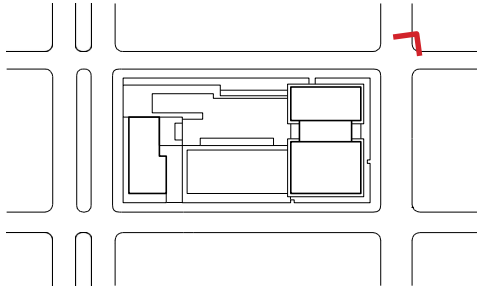

77th Street (toward Park Avenue)



Existing



Proposed

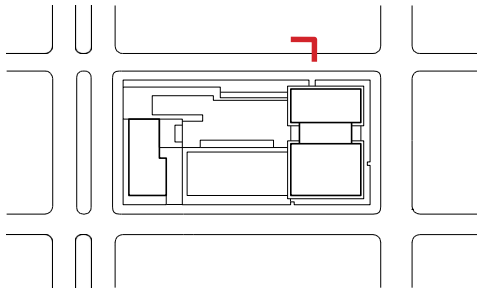

Park Avenue @ 77th Street



Existing



Proposed

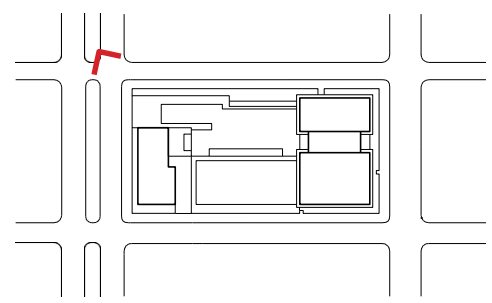

Park Avenue @ 76th Street



Existing



Proposed

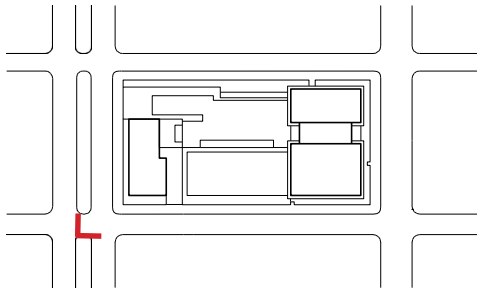

76th Street (toward Lexington Avenue)



Existing



Proposed

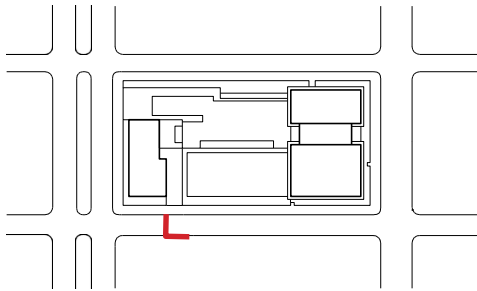

How to Stay Informed



Website
www.renewinglenox.org

Email
renewinglenox@northwell.edu

Phone
(212) 434-4360