



**Parks**

# John Jay Park

Located on FDR Drive between East 76th and 78th Streets,  
in the Borough of Manhattan.

Community Board Meeting  
September 6, 2018  
Tyler Parlato, NYC Parks

**Total Budget:** \$400K  
City Council District 5, Ben Kallos - \$400K FY17

**Project Size:** 0.15 ac

# Goals

- Upgrade active uses for adult constituents
- Facilitate passive use and preserve views of river





MANHATTAN

1000'



UPPER EAST SIDE

500'



JOHN JAY PARK

50'



NYC Parks

John Jay Park | Project Location

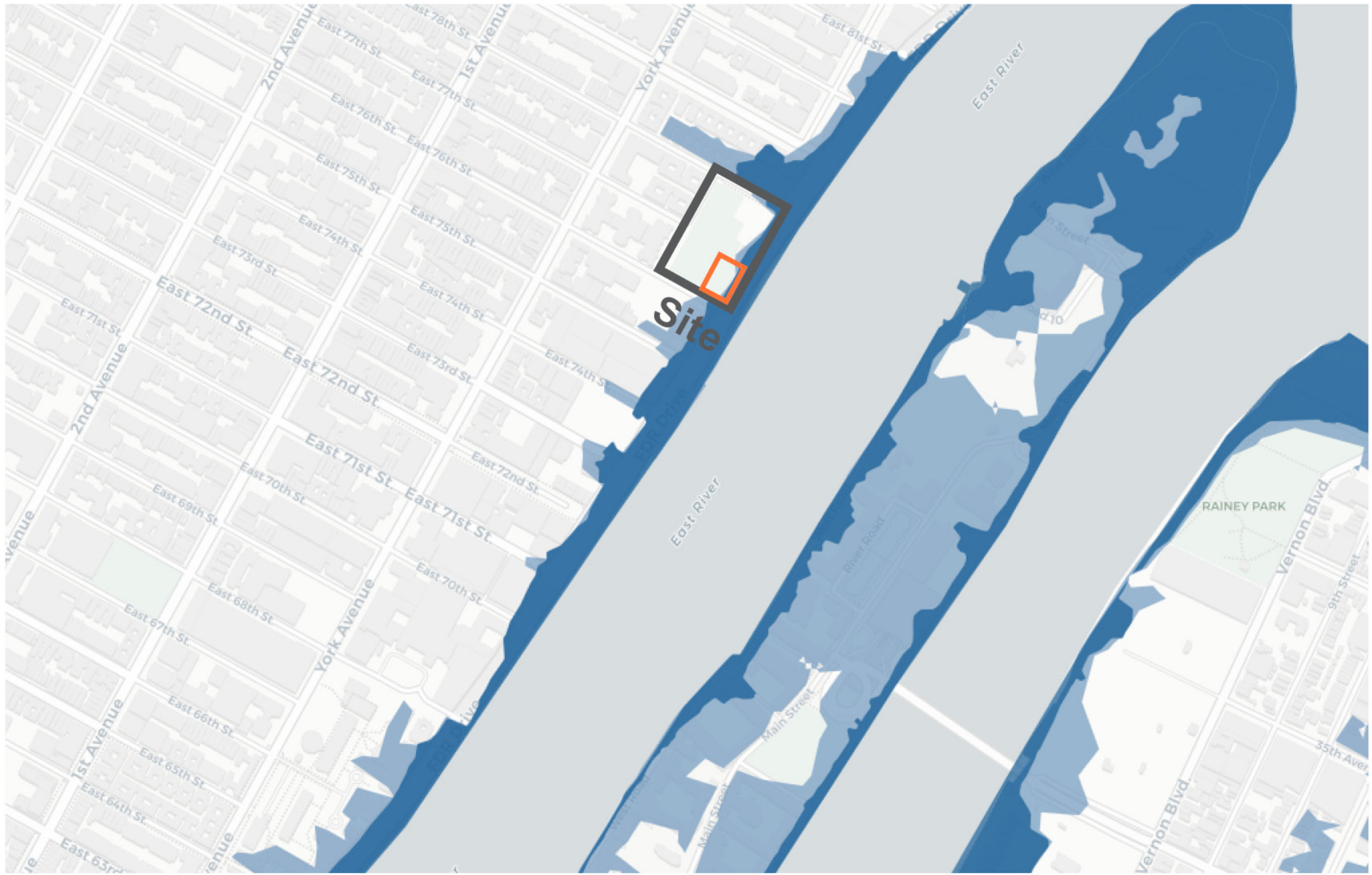

# Flood Hazard Zones

## 2015 Preliminary 100-year Floodplain

**1% Annual Chance Floodplain (100 Year Floodplain)** The area that has a 1% chance of flooding in any given year.

## 2050s Projected 100-year Floodplain

The potential areas that could be impacted by the 100-Year flood in the 2050s based on projections of the high-estimate 90th percentile sea level rise scenario (NYC Panel on Climate Change (NPCC) 2015 data).

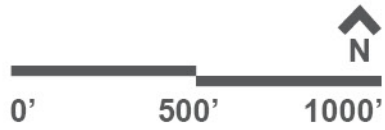

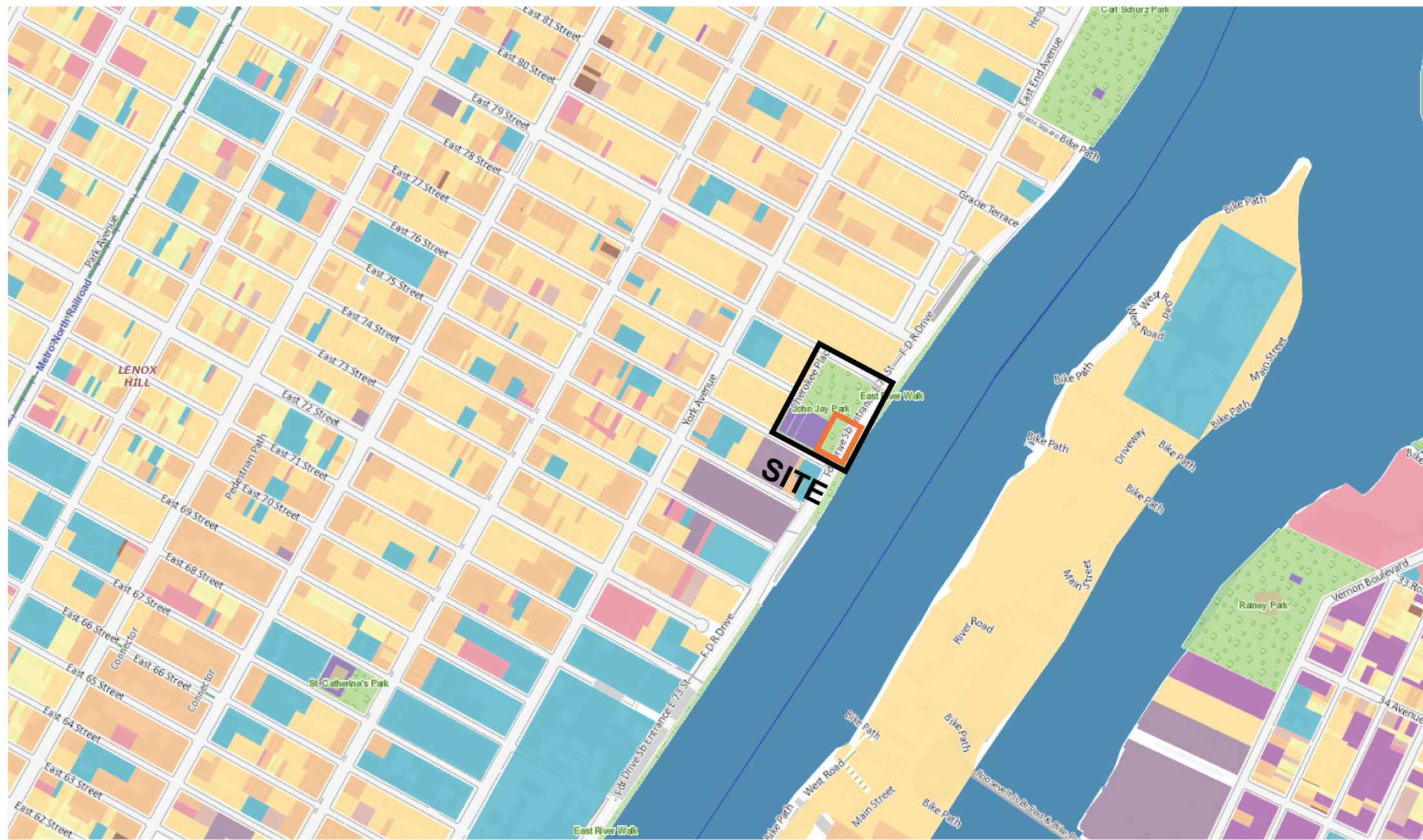

### All Land Use Categories

- 1 and 2 Family Residential
- Multi-family Residential
- Mixed Use
- Open space and outdoor recreation
- Commercial
- Institutional
- Industrial
- Parking
- Transportation/ Utilities
- Vacant Lots

NTS



NYC Parks

## John Jay Park | Surrounding Land Use



- Carl Schurz Park**
- Comfort Station
  - Basketball
  - Play Equipment
  - Spray Shower
  - Roller Hockey
  - Dog Run

- St. Catherine's Park**
- Comfort Station
  - Handball
  - Tennis
  - Basketball
  - Play Equipment



**John Jay Park | Neighborhood Context**



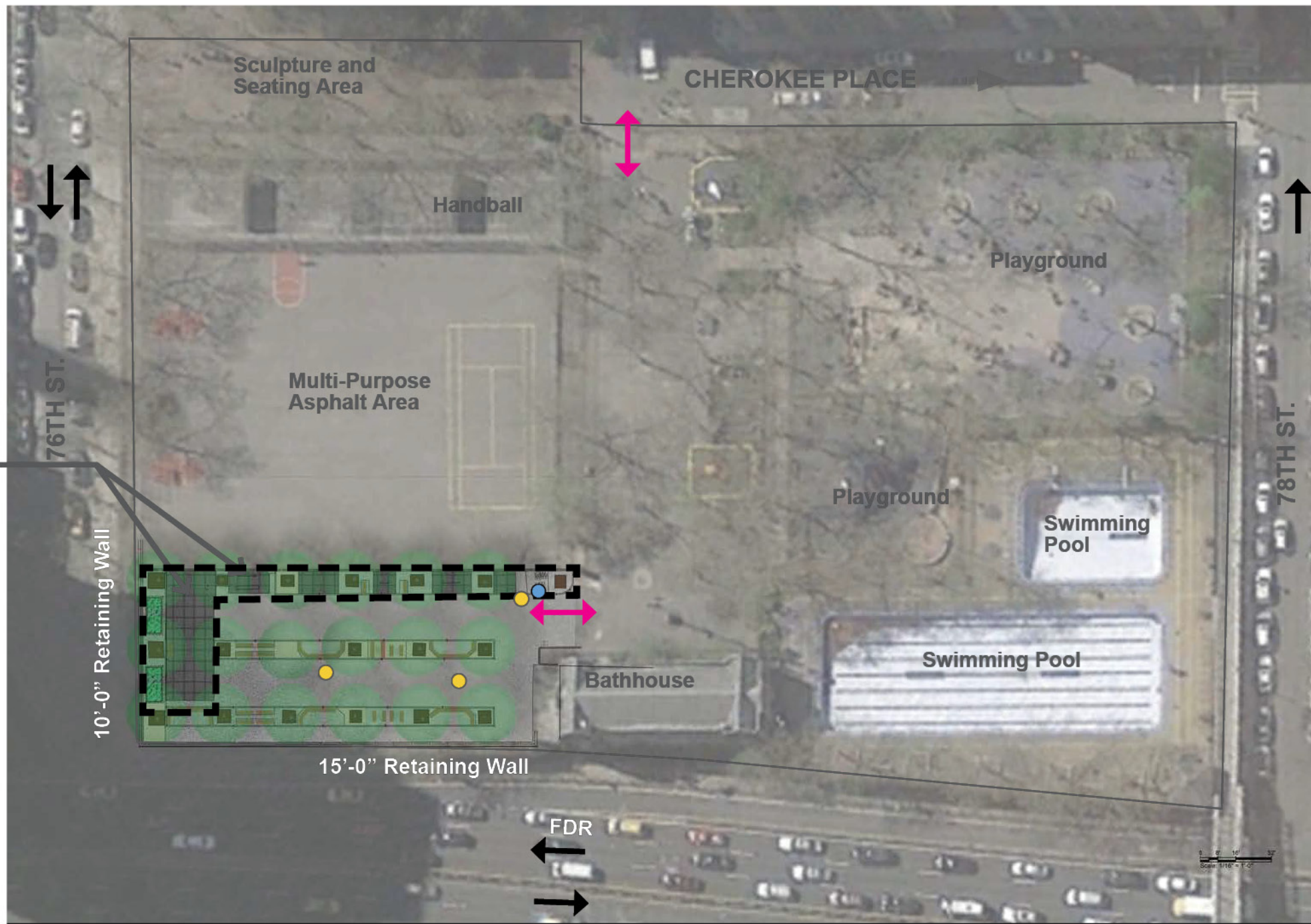

### Legend

-  Project Limit
-  Park Entrance
-  Tree
-  Parks Lightpole
-  Drinking Fountain
-  Traffic

Fitness Units on Safety Surface

10'-0" Retaining Wall

15'-0" Retaining Wall

FDR



## John Jay Park | Existing Conditions



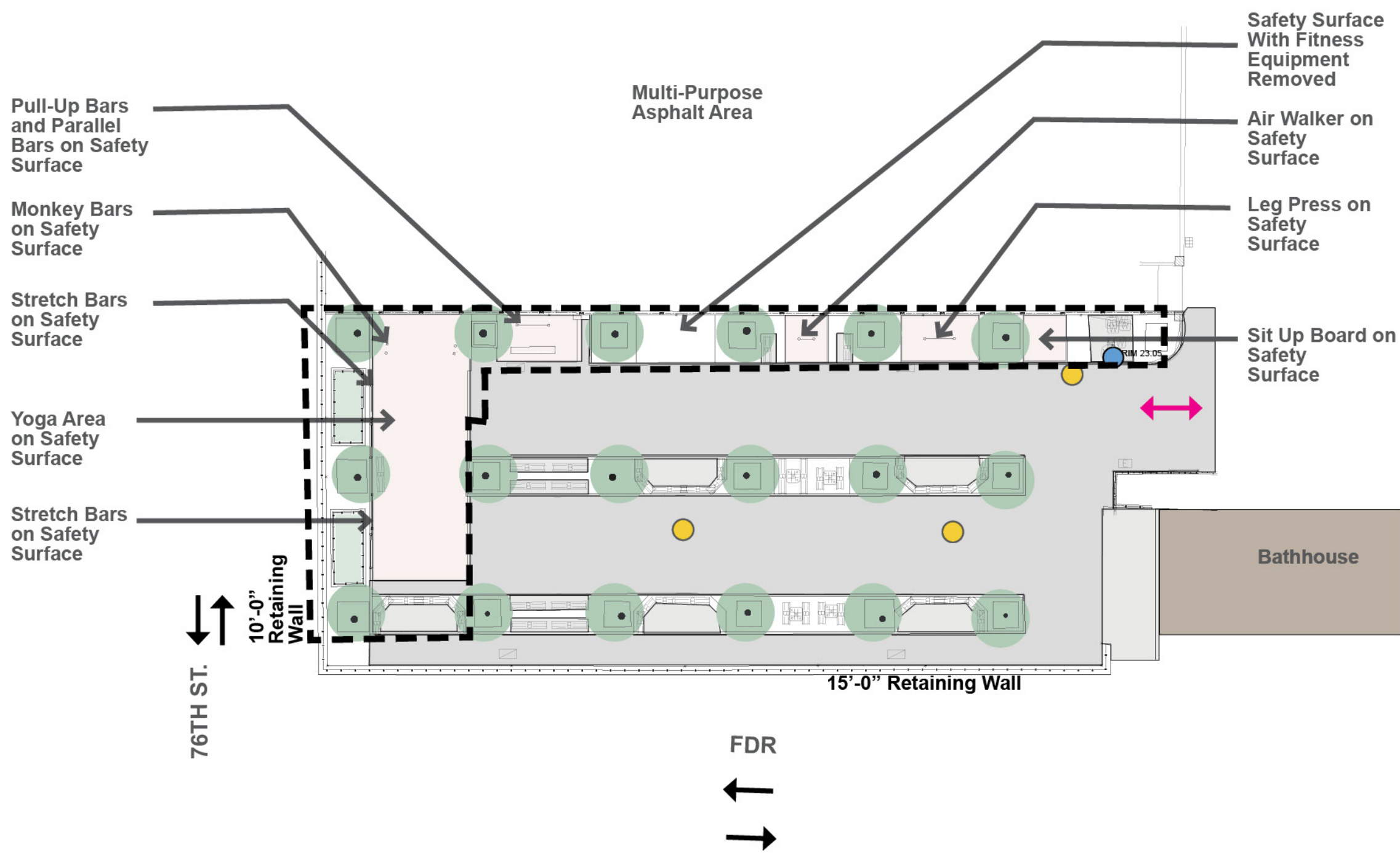

- ### Legend
- Project Limit
  - Park Entrance
  - Fitness Equipment
  - Building or Structure
  - Asphalt Pavement
  - Reinforced Concrete
  - Tree
  - Parks Lightpole
  - Drinking Fountain
  - Traffic
  - Type 'B' Benches





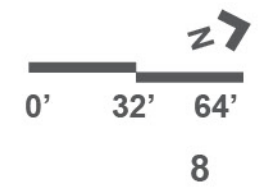



John Jay Park | Existing Conditions - Enlargement





# Legend

-  Project Limit
-  Park Entrance
-  Pedestrian Traffic
-  Heavy Vehicle Traffic
-  existing fitness equipment & safety surface
-  deteriorated asphalt
-  Tree Canopy/Shade

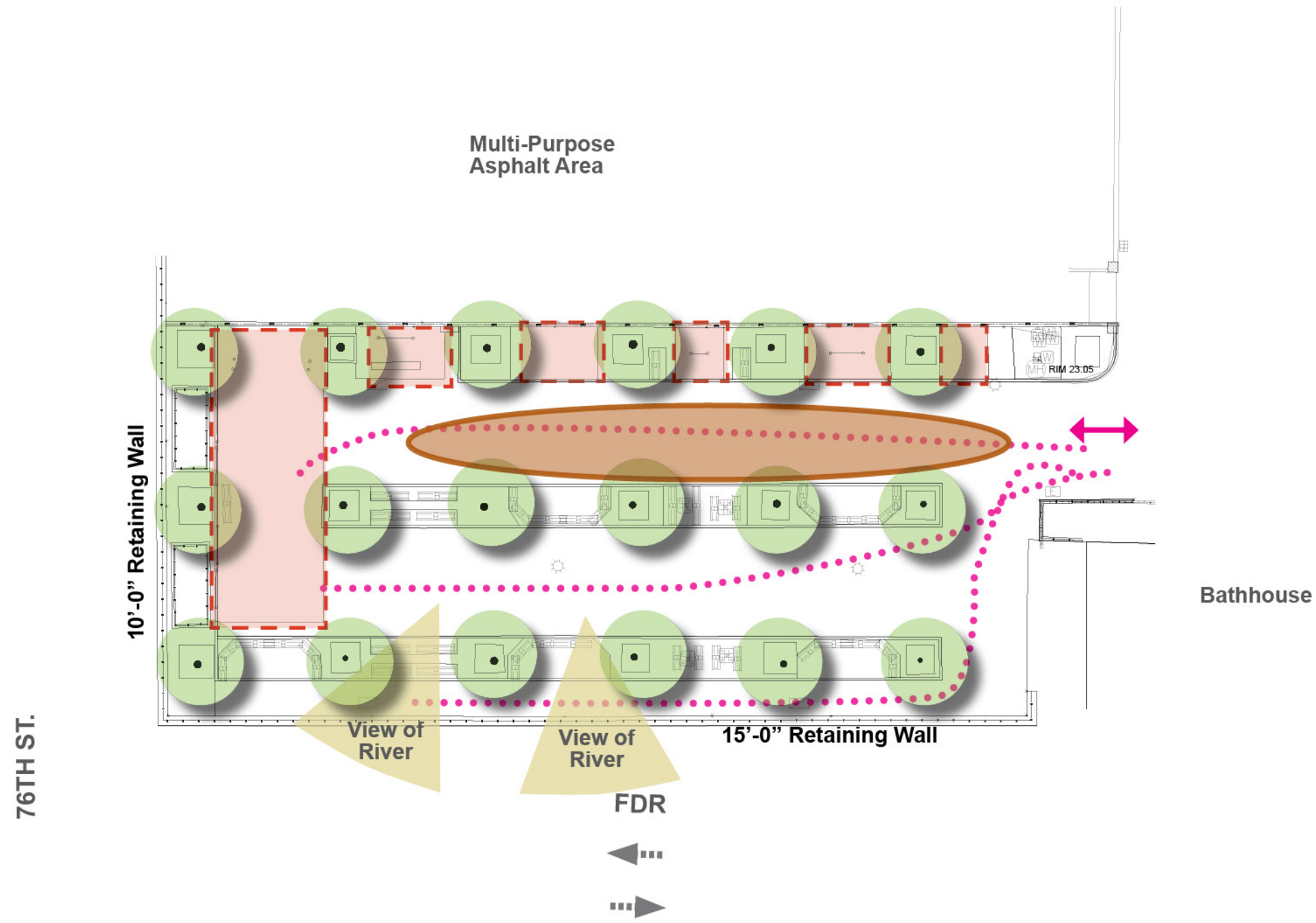

# Legend

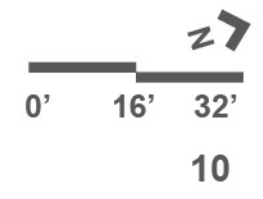
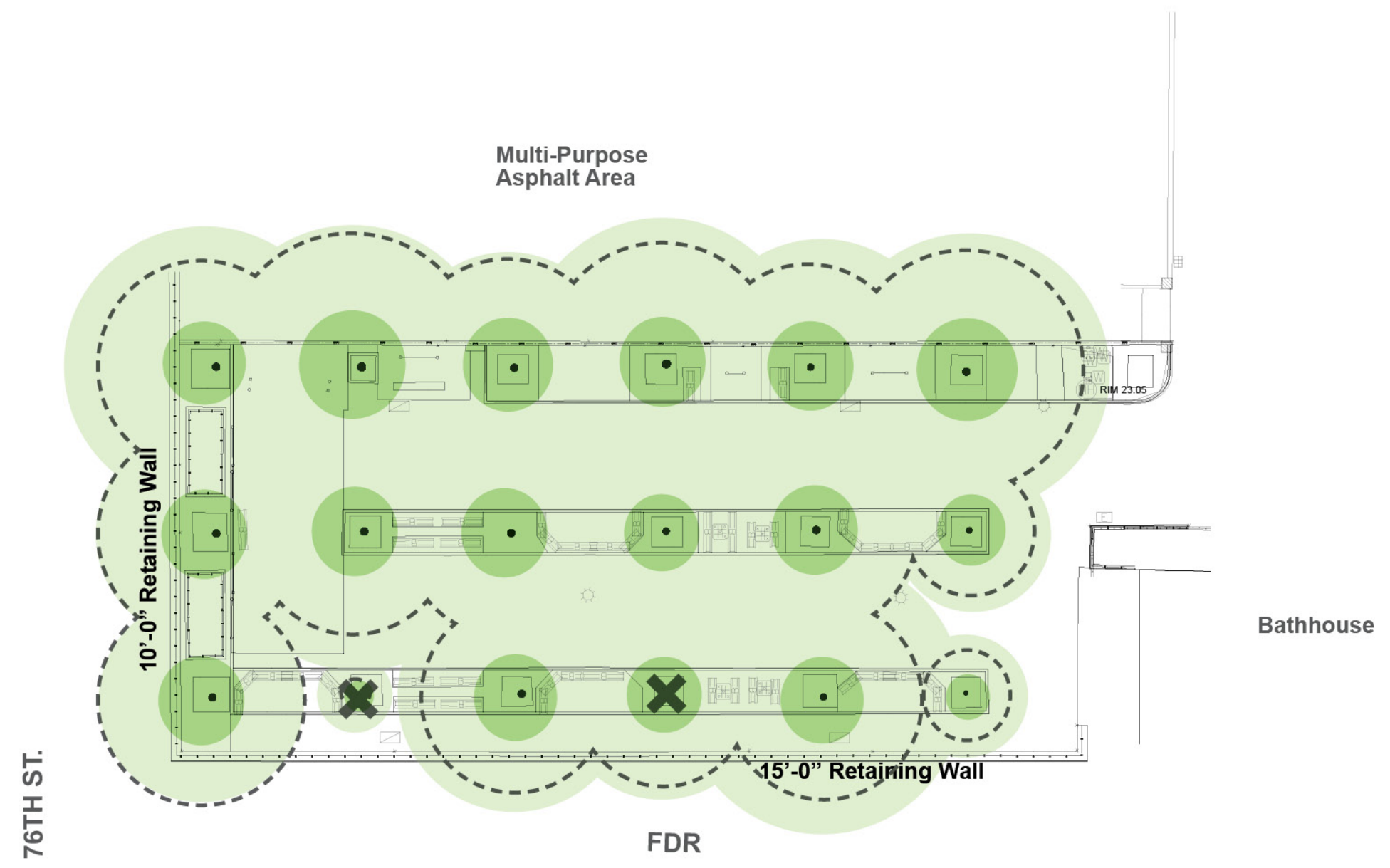
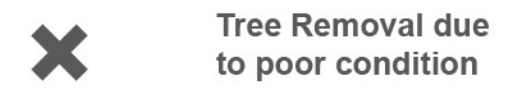
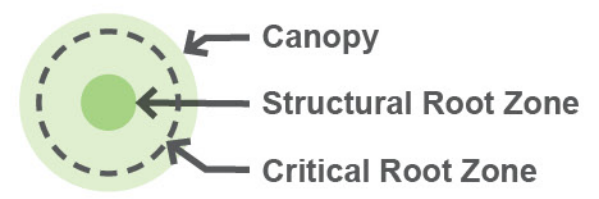



1 - View of Drinking Fountain looking South



2 - View of Entrance and Fitness Equipment looking North

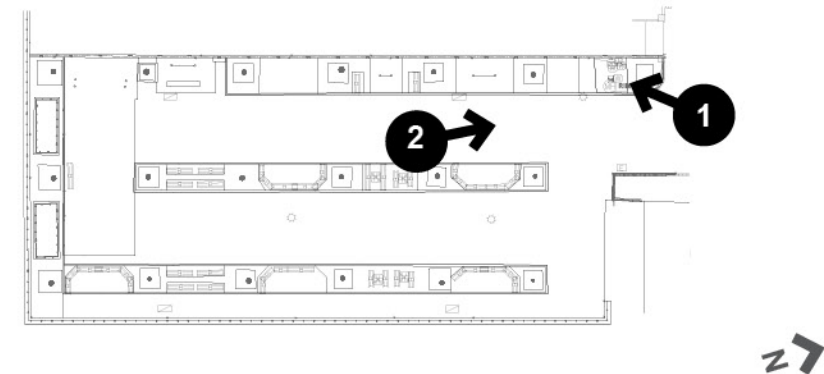

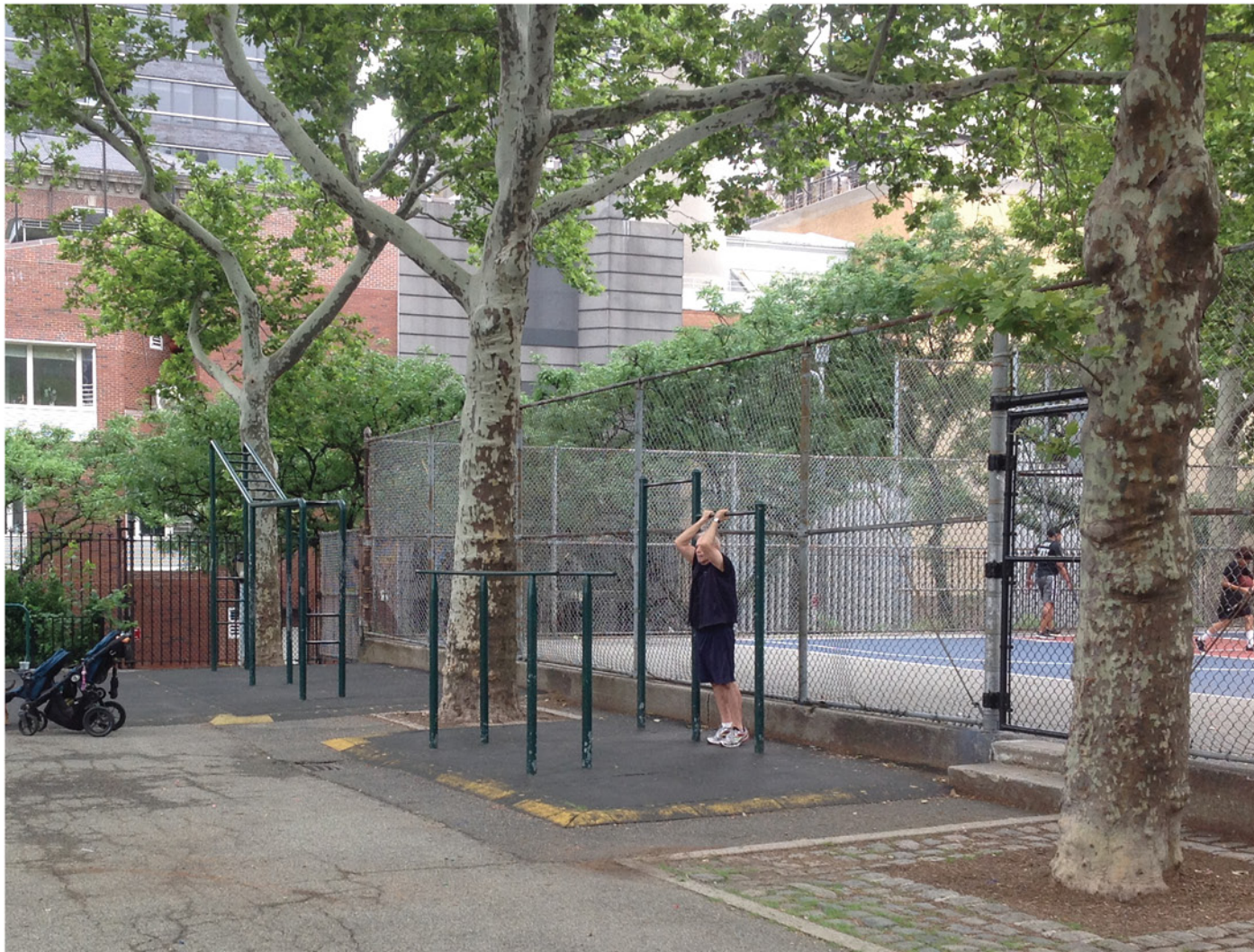

1 - View of Fitness Equipment looking South



2 - View of Entrance to MPPA looking West

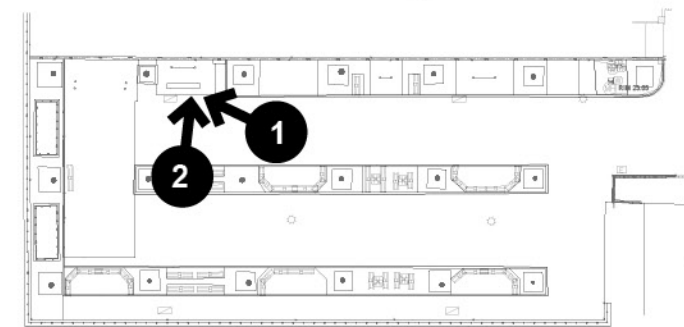



1 - View of Fitness Equipment and Yoga Area looking West



2 - View of Safety Surfacing with Fitness Equipment Removed

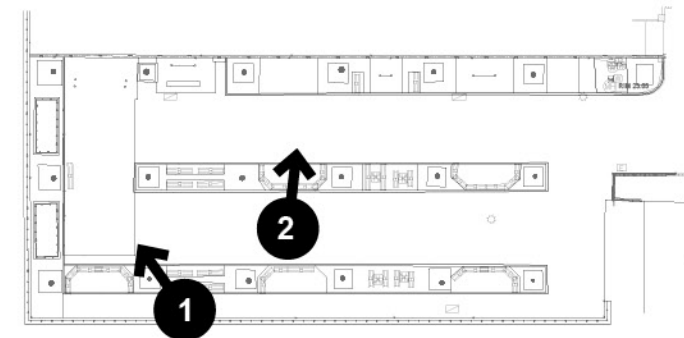

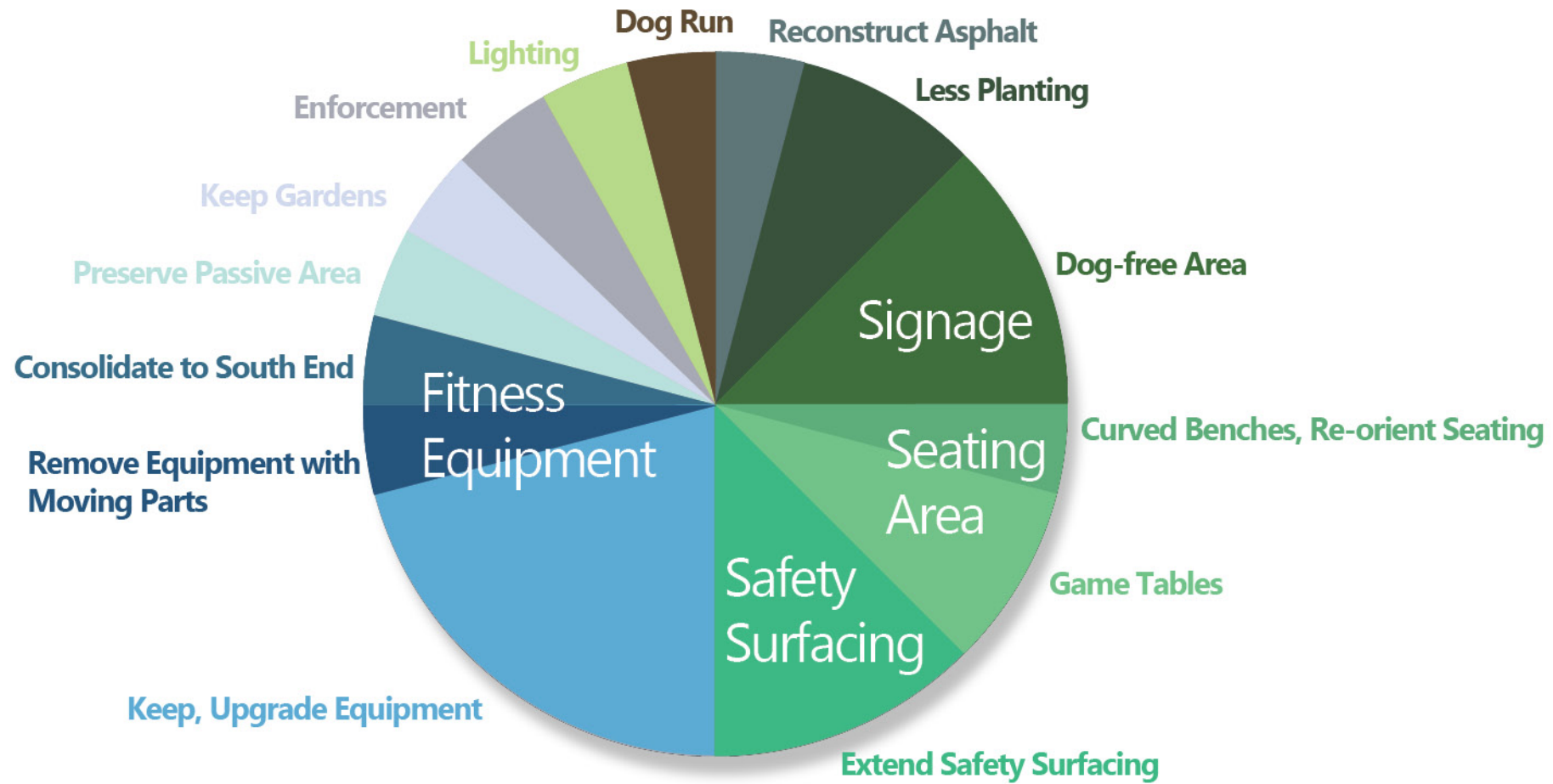

Multi-Purpose Asphalt Area

New Accessible Picnic Table on Accessible Granite Block Pavement

New Type 'B' Benches on Accessible Granite Block Pavement

Existing D.F. Type 'F' Hi-Lo

New Fitness Units on New Safety Surfacing

New Picnic Table on Accessible Granite Block Pavement

76TH ST.

10'-0" Retaining Wall

Existing Picnic Tables on Accessible Granite Block Pavement

Existing Lightpole to Remain, Typ.

Existing Pavement to Remain

Existing Trees to be protected, typ.

Bathhouse

Existing Game Tables on Accessible Granite Block Pavement

15'-0" Retaining Wall

FDR



NYC Parks

John Jay Park | Schematic Design



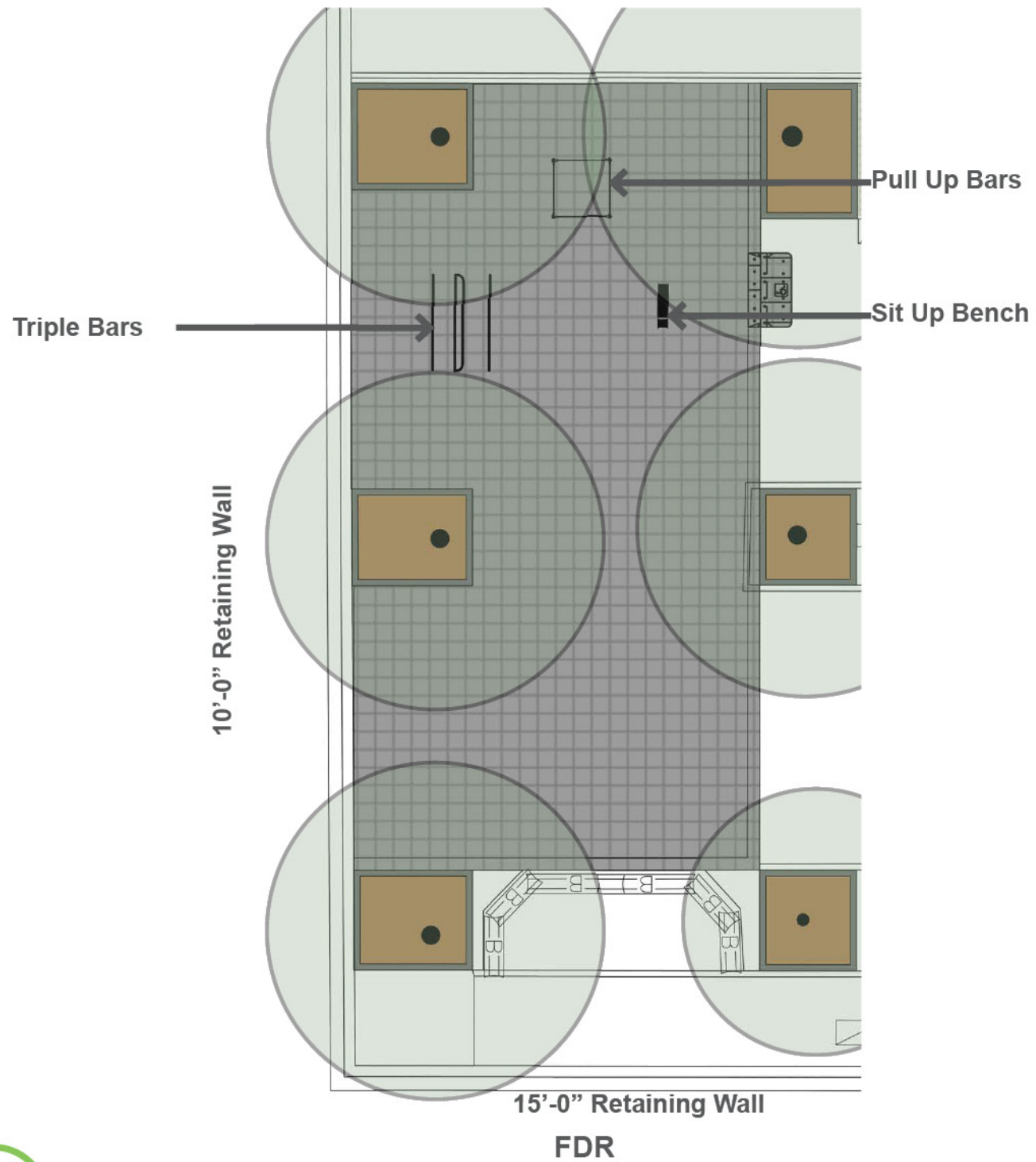

Pull Up Bars



Triple Bars



Sit Up Bench





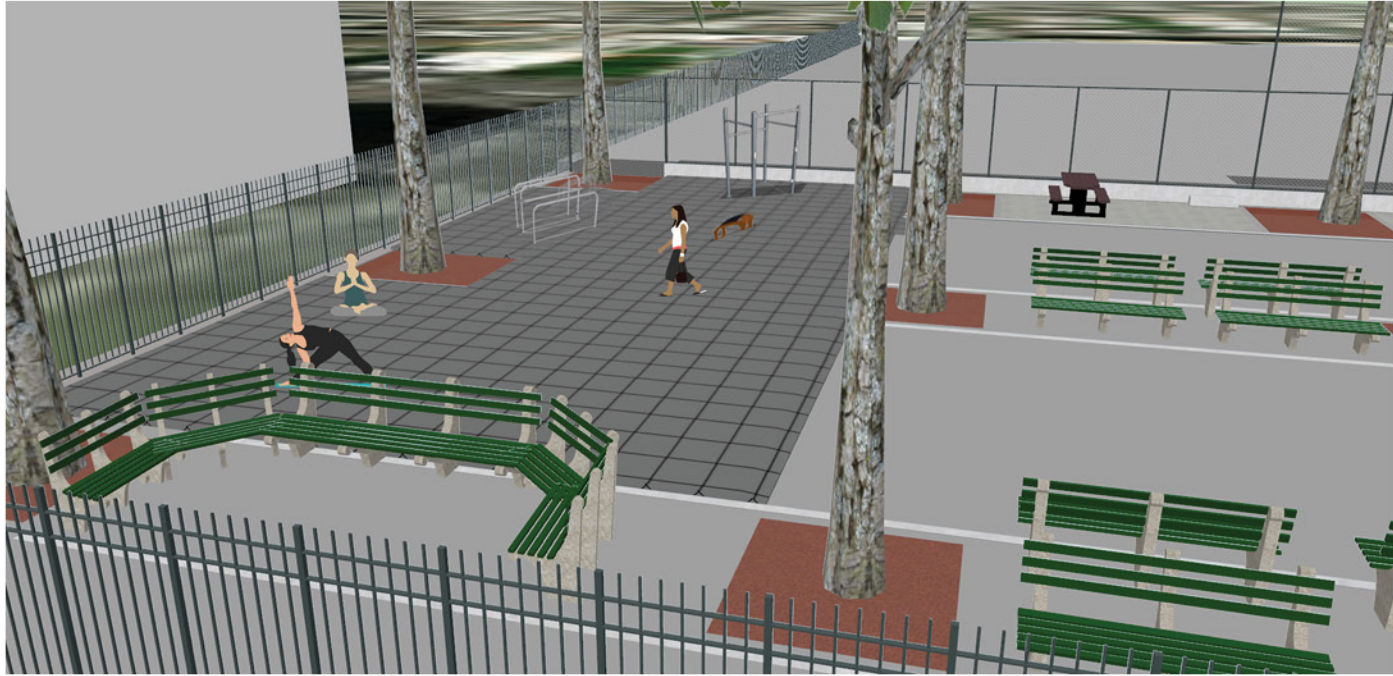

1 - View of Fitness Area looking West

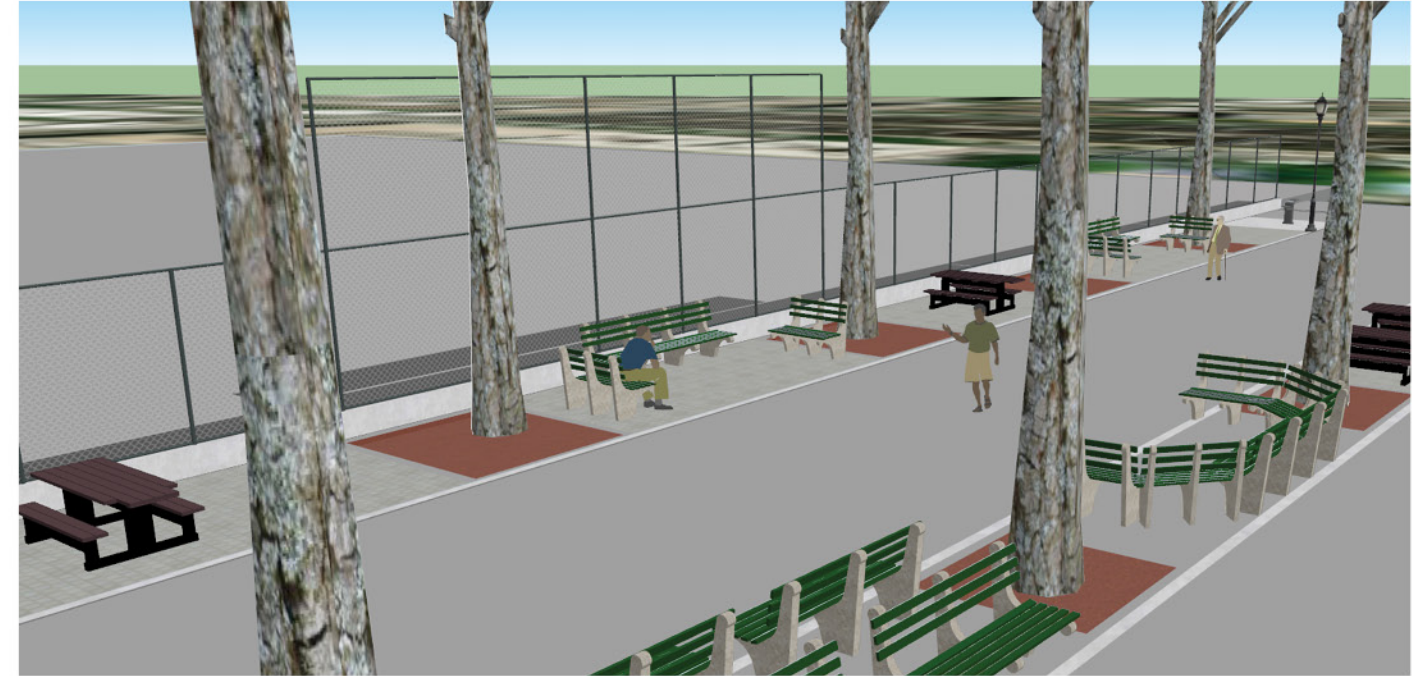

2 - View of Seating Area looking North

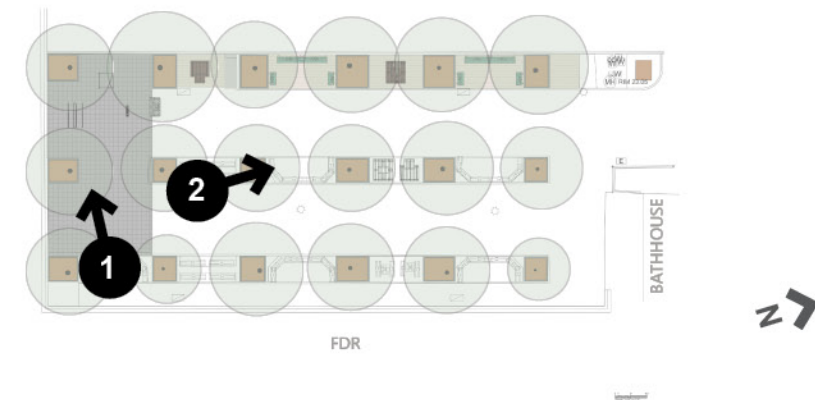



Adult Fitness



Picnic Table



Bench Type 'B'

**LEGEND**

- EXISTING FENCES (x = HEIGHT)
- .....x..... CLF
- x—— STEEL

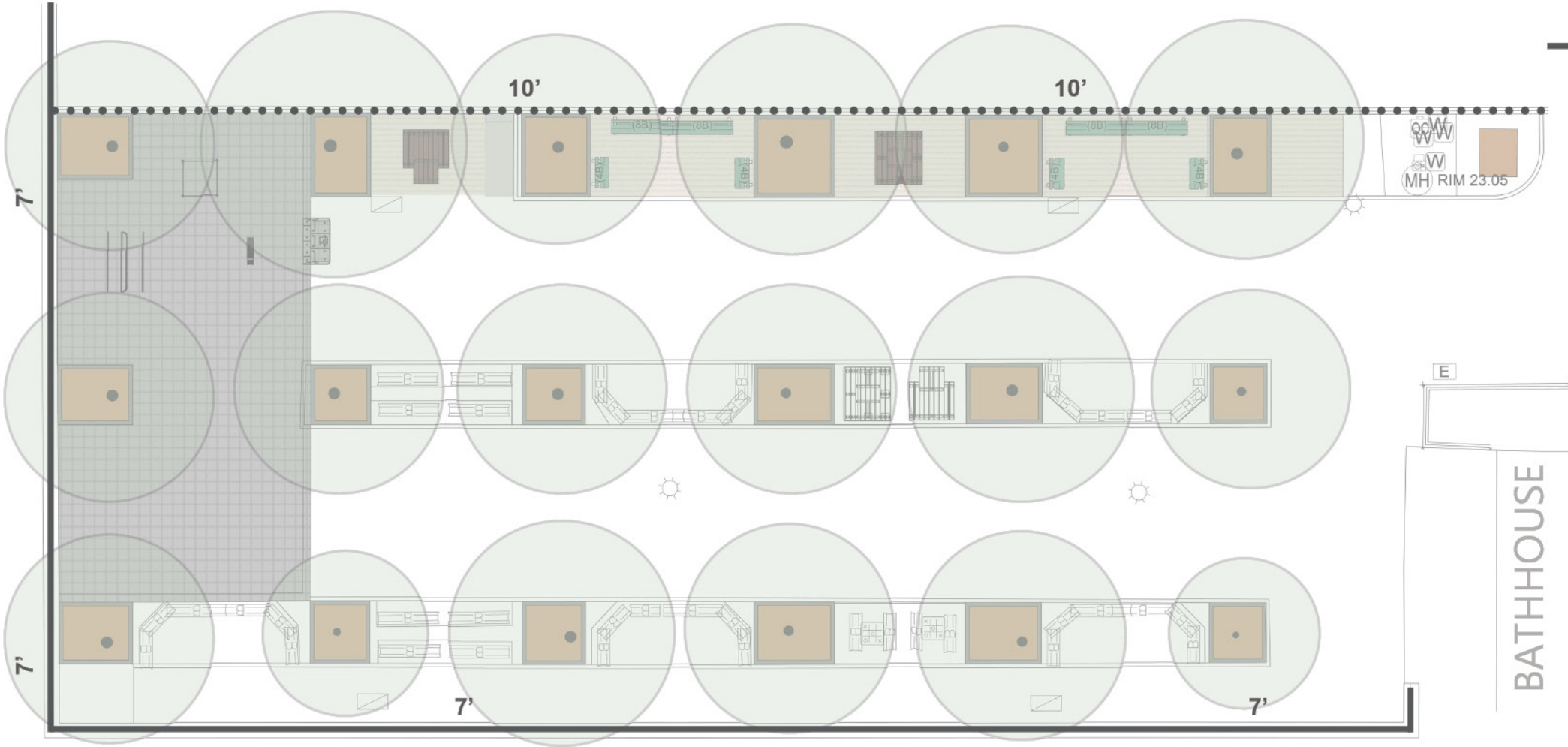

Multi-Purpose Asphalt Area

New Accessible Picnic Table on Accessible Granite Block Pavement

New Type 'B' Benches on Accessible Granite Block Pavement

Existing D.F. Type 'F' Hi-Lo

New Fitness Units on New Safety Surfacing

New Picnic Table on Accessible Granite Block Pavement

76TH ST.

10'-0" Retaining Wall

Existing Picnic Tables on Accessible Granite Block Pavement

Existing Lightpole to Remain, Typ.

Existing Pavement to Remain

Existing Trees to be protected, typ.

Bathhouse

Existing Game Tables on Accessible Granite Block Pavement

15'-0" Retaining Wall

FDR



NYC Parks

John Jay Park | Schematic Design

