

Subject Site

ZONING MAP

THE NEW YORK CITY PLANNING COMMISSION

Major Zoning Classifications:
The number(s) and/or letter(s) that follows on R, C or M District designation indicates use, bulk and other controls as described in the text of the Zoning Resolution.

R - RESIDENTIAL DISTRICT

C - COMMERCIAL DISTRICT

M - MANUFACTURING DISTRICT

SPECIAL PURPOSE DISTRICT
The letter(s) within the shaded area designates the special purpose district as described in the text of the Zoning Resolution.

..... AREA(S) REZONED

Effective Date(s) of Rezoning:

06-26-2014 C 140181 ZMM

Special Requirements:

For a list of lots subject to CEOR environmental requirements, see APPENDIX C.

For a list of lots subject to "D" restrictive declarations, see APPENDIX D.

For Inclusionary Housing designated areas on this map, see APPENDIX F.

ZONING MAP

8c

MAP KEY

5d	6b
8a	8c
8b	8d

© Copyrighted by the City of New York

NOTE: Zoning information as shown on this map is subject to change. For the most up-to-date zoning information for this map, visit the Zoning section of the Department of City Planning website: www.nyc.gov/planning or contact the Zoning Information Desk at (212) 720-3281.

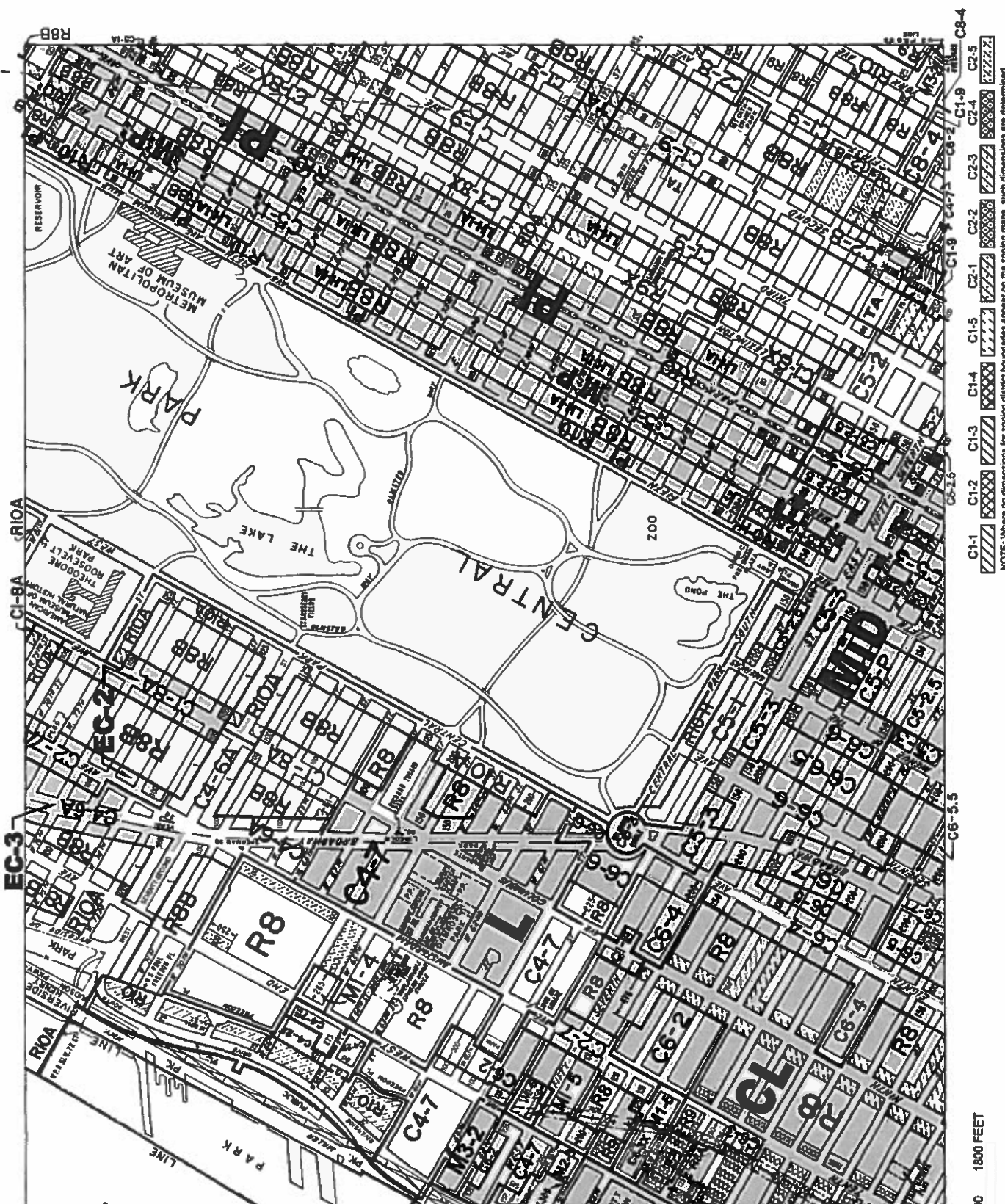

NOTE: Where no dimensions for zoning district boundaries appear on this zoning map, such dimensions are determined in Article VII, Chapter 8 (Location of District Boundaries) of the Zoning Resolution.

10 1800 FEET

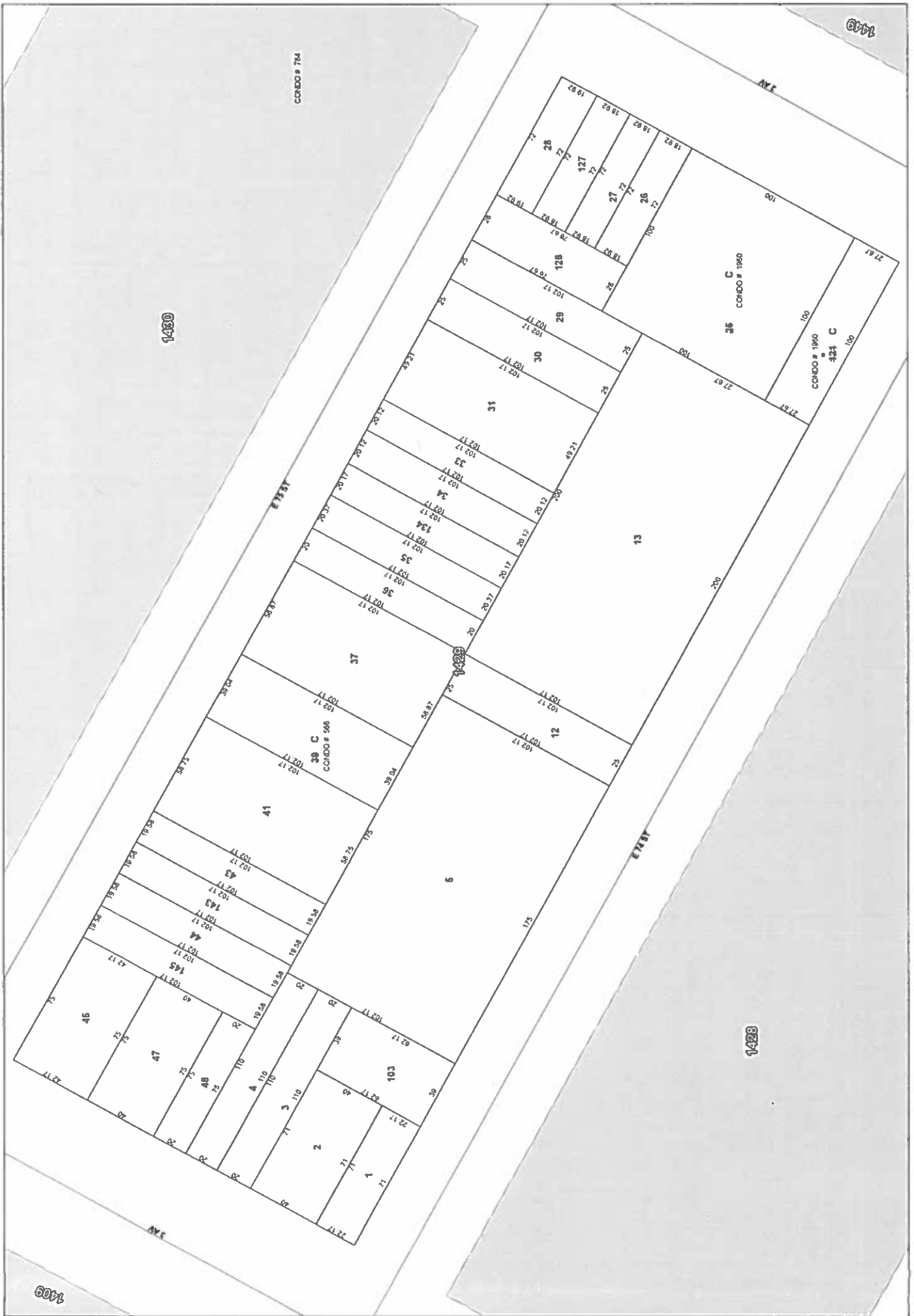

1409

1430

1428

1449

CONDO # 764

38 C
CONDO # 566

35 C
CONDO # 1960

CONDO # 1960
321 C