

NEW YORK CITY DEPARTMENT OF
DESIGN + CONSTRUCTION

**RCONSTRUCTION OF
E 81ST STREET PEDESTRIAN BRIDGE**

Over

FDR DRIVE

BOROUGH OF MANHATTAN

COMMUNITY BOARD 8M

DECEMBER 03, 2014

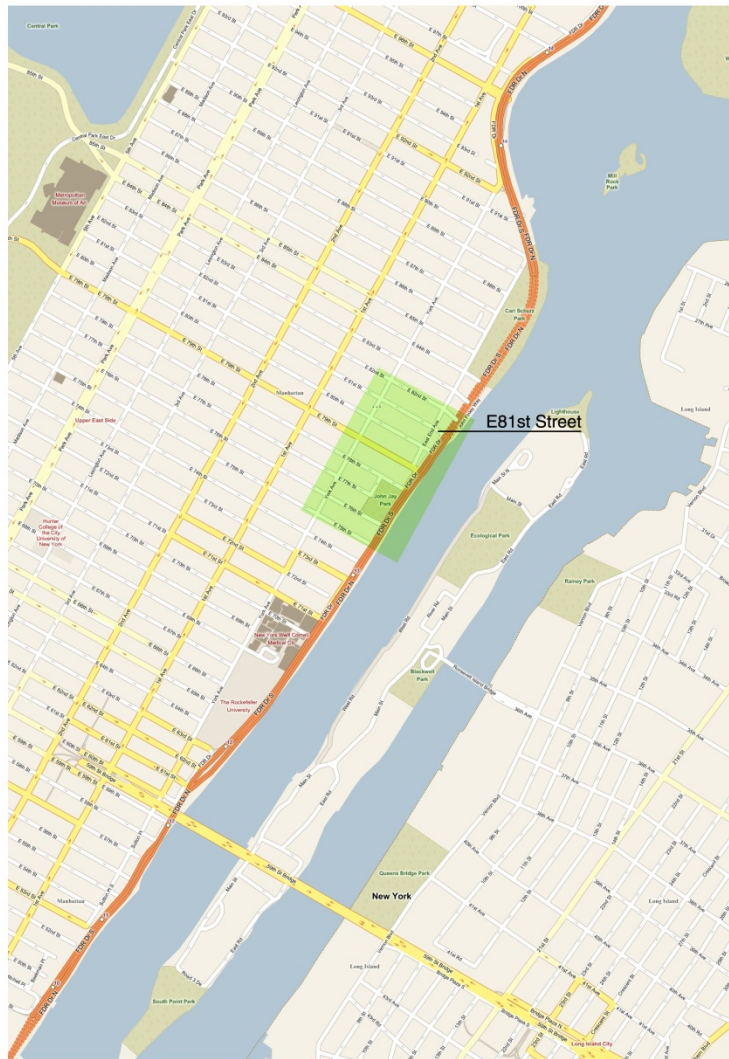

Above: Area Map
 Top Right: Aerial Photograph of Site Context
 Bottom Right: Composite Panoramic View of E81st St Site from Roosevelt Island



E 81st STREET BRIDGE – STEPS AT 81st STREET



E 81st STREET BRIDGE – VIEW LOOKING EAST



05/04/2005

E 81st STREET BRIDGE – PROMANADE VIEW



E 81st STREET BRIDGE – LOOKOUT POINT



E 81st STREET BRIDGE – STAIRS TO ESPLANADE



PARK ESPLANADE – LOOKING SOUTH



EAST 81ST STREET BRIDGE – VIEW FROM ROOSEVELT ISLAND

EXISTING CONDITION



E 81st STREET BRIDGE – UNDERDECK SHIELD



E 81ST STREET BRIDGE – DECK UNDERSIDE





E 81st STREET BRIDGE – UNDER DECK DETERIORATION



E 81st STREET BRIDGE – FOUNDATION DETERIORATION

PROPOSED BRIDGE

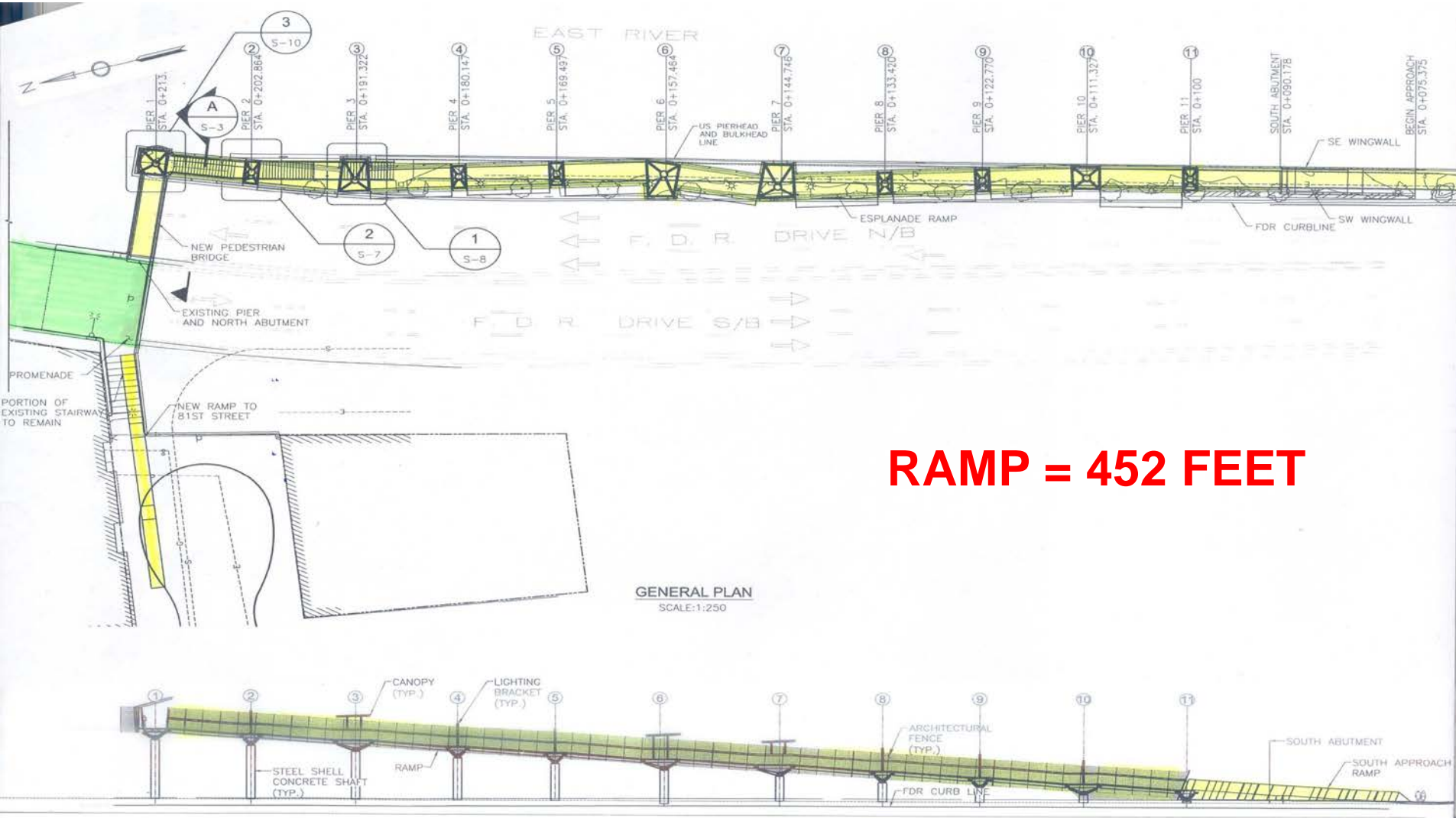

E81st STREET – PROPOSED PLAN, ELEVATION



EAST 81ST STREET PEDESTRIAN BRIDGE

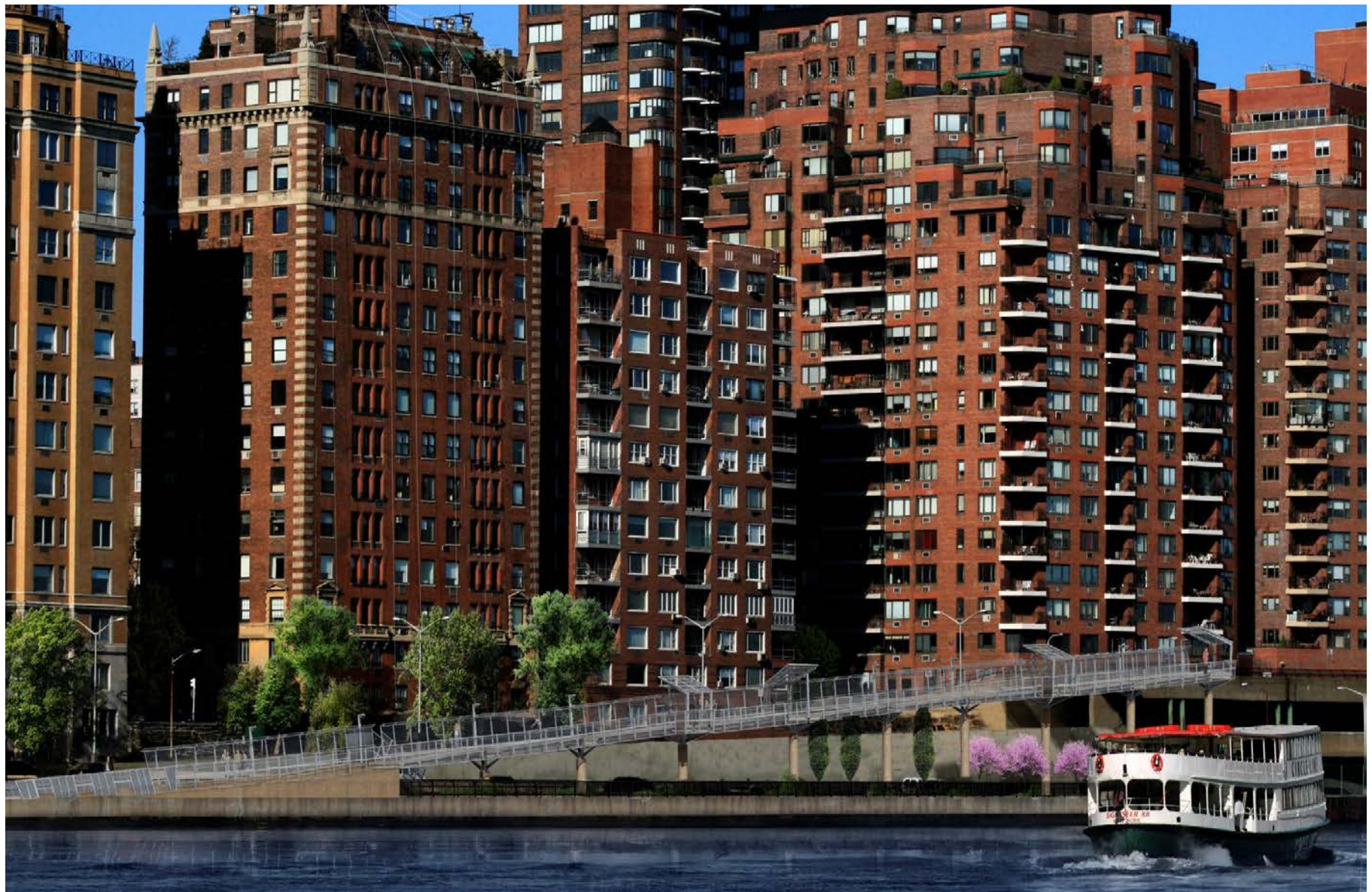





NO BARRIER FREE ACCESS AT E81ST STREET

05/04/2005

E 81st STREET BRIDGE – STEPS AT 81st STREET

81st Street Bridge

- Possible Field office Locations
- Can CB recommend a location

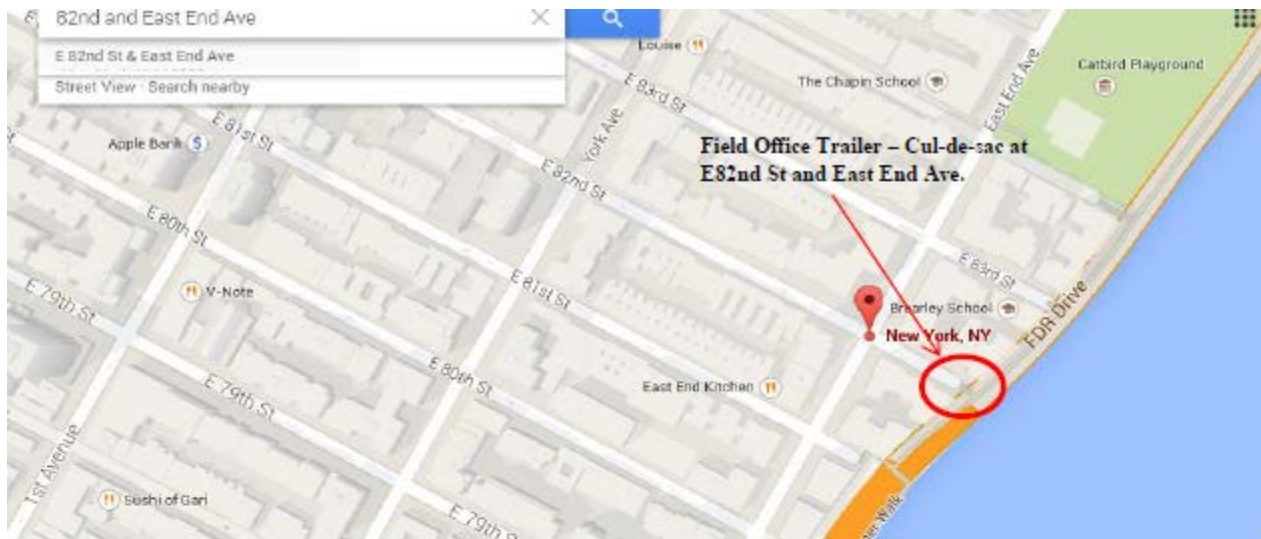

Field Office Trailer Location 4: North View



24x56 Complex

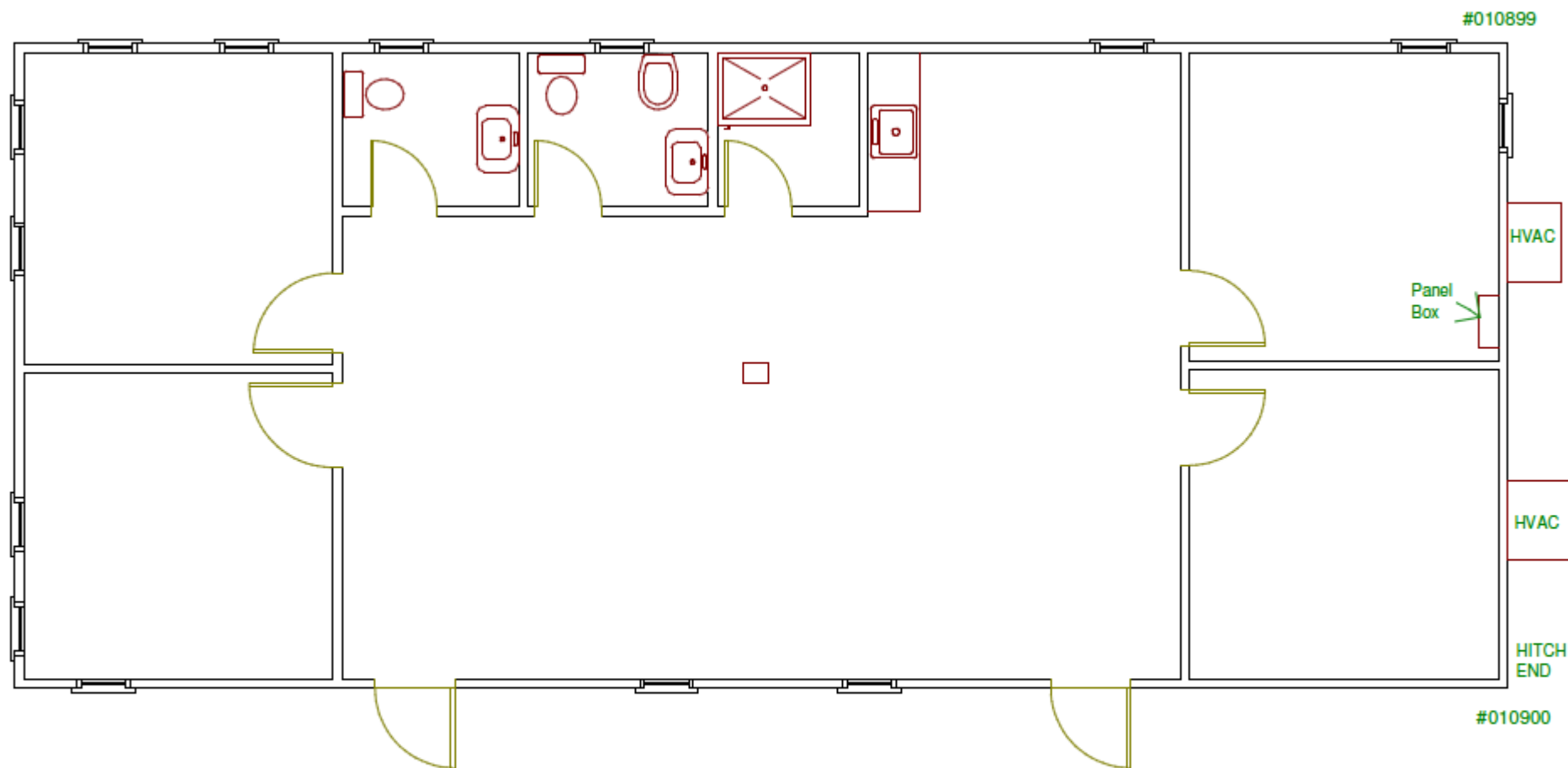

Unit #'s 010899 & 010900

COMMUNITY IMPACTS & WHAT TO EXPECT

MEETING WITH CB DURING PRELIMINARY DESIGN
MEETING WITH CB DURING FINAL DESIGN
MEETING AT PRE-CONSTRUCTION STAGE
MEETING AGAIN ON AS NEEDED BASIS
WEEKLY LOOK AHEAD/BULLETINS
BI-MONTHLY NEWSLETTER TO COMMUNITY
ADVISING ON PROGRESS AND MAJOR MILESTONES

.

Special Needs:

- Individuals with special needs should contact the CCL
- DDC field staff will work specially with those individuals to minimize certain inconveniences

Rodent Control:

- A rodent survey will be performed prior to construction
- Rodent Control Stations will be installed by a professional rodent control contractor

CITY DOT TRAFFIC STIPULATIONS DURING CONSTRUCTION

Access to Promenade will be maintained at all times
Limited access to esplanade from 81st Street during construction.

FDR-One lane closure from 11 PM to 5 AM weekdays

Two lane closure from 1 AM to 5 AM weekdays

Full closure 15 minutes on the hour for erection

Two lane closure from midnight to 7 AM-Saturday

Two lane closure from 11 PM Saturday to 10 AM Sunday

KEEPING YOU INFORMED

Office of Community Outreach & Notification, DDC

- **DDC will assign a Community Construction Liaison (CCL). The CCL will keep the community informed by:**
 - Being the first point of contact between the project and the community
 - Identifying, addressing and/or resolving field inquiries & issues as well as any coordination between the project and needs of the affected stakeholders
 - Providing regular updates/advisories for the community to better plan around construction activities
- CCL contact information will be provided once determined
 - Name:** TBA
 - Email:** TBA
 - Field Office:** TBA
 - Telephone :** TBA
- DDC Website: www.nyc.gov/ddc
- DDC Video: www.nyc.gov/webuild

During Non-Working hours, please call 311 and give the Project ID: HBPED100M

COMMUNITY IMPACTS

- Pedestrian access will be maintained at all times on the Promenade
- Temporary street closures and / or limited access may be necessary
- Uniformed NYPD traffic agents assigned on FDR when required.
- DDC will monitor operation and work within DEP Noise Code regulations
- Sidewalk and/or loading dock access from the curb may be temporarily restricted while work is conducted (coordination will be arranged on a case by case basis)

THANK YOU



NEW YORK CITY DEPARTMENT OF
DESIGN + CONSTRUCTION