

201'-6 1/4"

PARKING GARAGE FOR 60
HOME VEHICLES INCLUDING
TRANSIENT PARKING

TOWER CELLAR

BAR SCALE

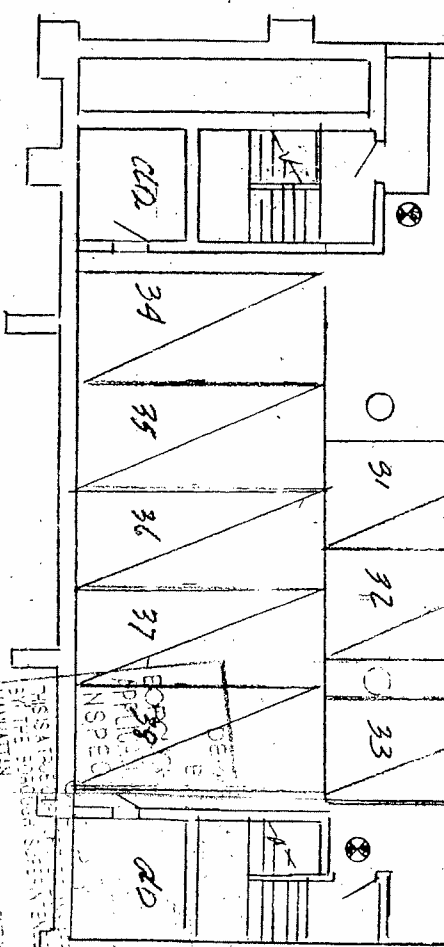

JUL 13 2007

EXAMINED FOR SIGNATURE AND SEAL
PREVENTION ONLY AS PER
SECTION 2-207 OF THE ENGINEERING
COURT REPORTS AND RECORDS
MAY 13 2007
DILOOH SINGH DBA

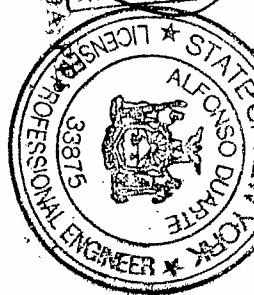

180 EAST END AVE
NEW YORK, NY 10014
DUARTE: 180 TEARMS CORP

ALFONSO DUARTE
PROFESSIONAL ENGINEER
199-14 24th ROAD
WHITESTONE, N.Y. 11357
(718) 352-2764

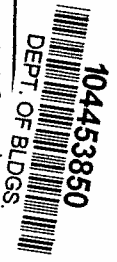

DWG.
2052

207'-6 1/2"

PARKING GARAGE FOR 50 HORSE VEHICLES
Including Transit Driveways

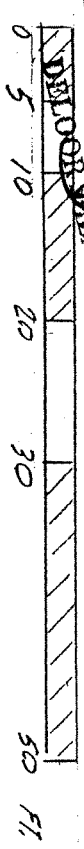
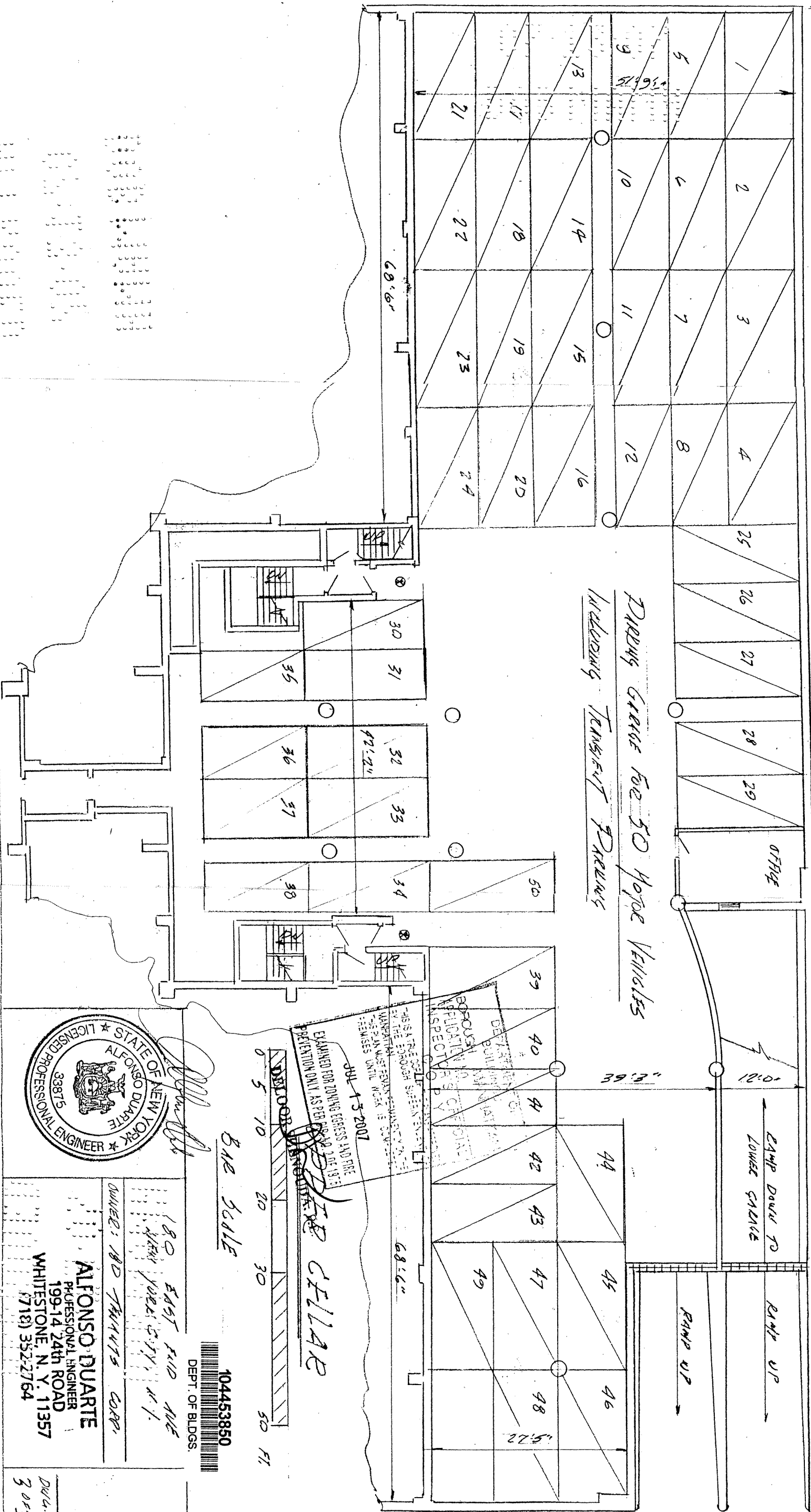

ONE SCALE

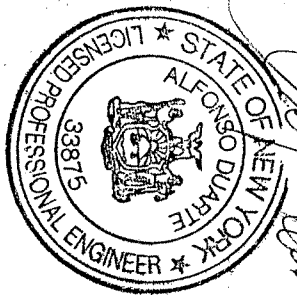

180 EAST 41ST AVE
NEW YORK CITY, N.Y.
OWNER: AD THAWATS CORP.
ALFONSO DUARTE
PROFESSIONAL ENGINEER
199-14 24th ROAD
WHITESTONE, N.Y. 11357
(718) 352-2764

104453850
DEPT. OF BLDGS.

DWG.
3053

EXAMINED FOR JOURNAL EGRESS AND FIRE
RETENTION ONLY, AS PER PAR. 2.07 OF 1973
E.C.P. PLAN MUST BE SEEN BY ALL
LICENSEES UNTIL WORK IS COMPLETED
JUL 15 2007

DEPARTMENT OF BUILDINGS
APPLICATIONS SECTION
INSPECTOR P.V.

EAST 88th STREET

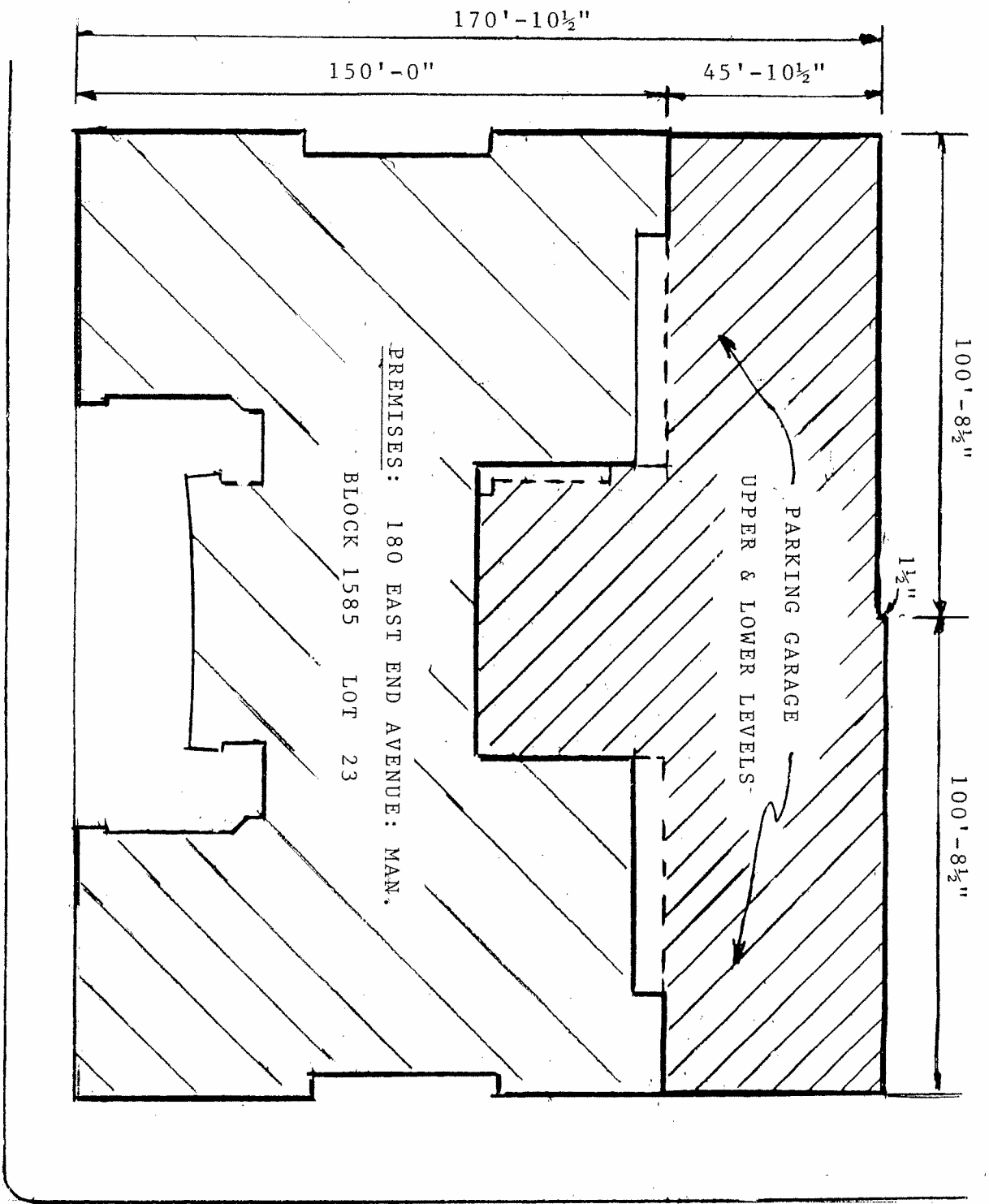

PREMISES: 180 EAST END AVENUE: MAN.

BLOCK 1585 LOT 23

PARKING GARAGE
UPPER & LOWER LEVELS

100'-8 1/2"

100'-8 1/2"

1 1/2"

170'-10 1/2"

150'-0"

45'-10 1/2"

201'-5"

EAST END AVENUE

PLOT PLAN



BAR SCALE

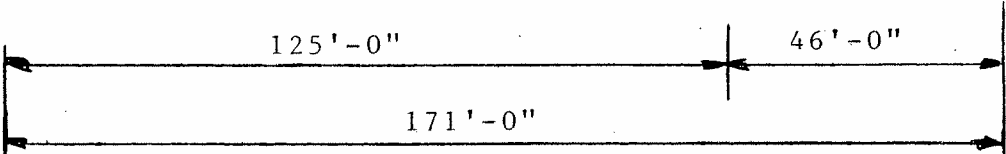

EAST 89th STREET

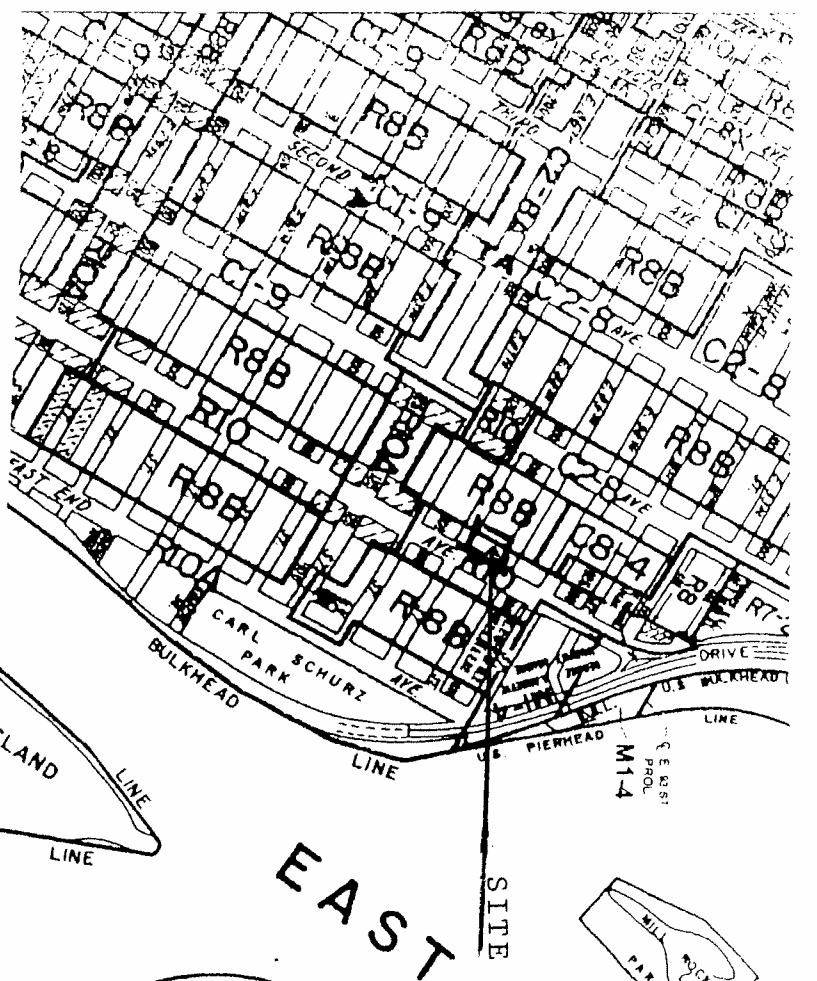

SITE LOCATION

NO SCALE

	AREA FT'	# OF CARS
LOWER LEVEL	12,000	59
UPPER LEVEL	11,000	55

HOURS OF OPERATION

7 Days a Week
24 Hours a day

EXISTING & PROPOSED CONDITIONS

ALFONSO DUARTE
PROFESSIONAL ENGINEER
190-14 24th ROAD
WHITESTONE, N.Y. 11357
(718) 352-2764

PREMISES
180 East End Avenue
Manhattan, New York

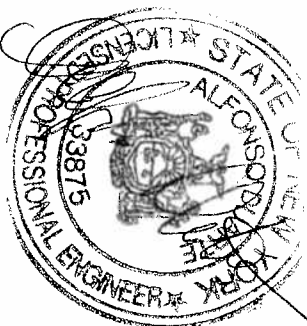

BSA CAL. # 190-92-BZ
OWNER: 180 TENANTS CORP.

PLOT PLAN

DWG. A-001.00
SHEET 1 of 3

4-25-13
DATE

201'-6 1/2"

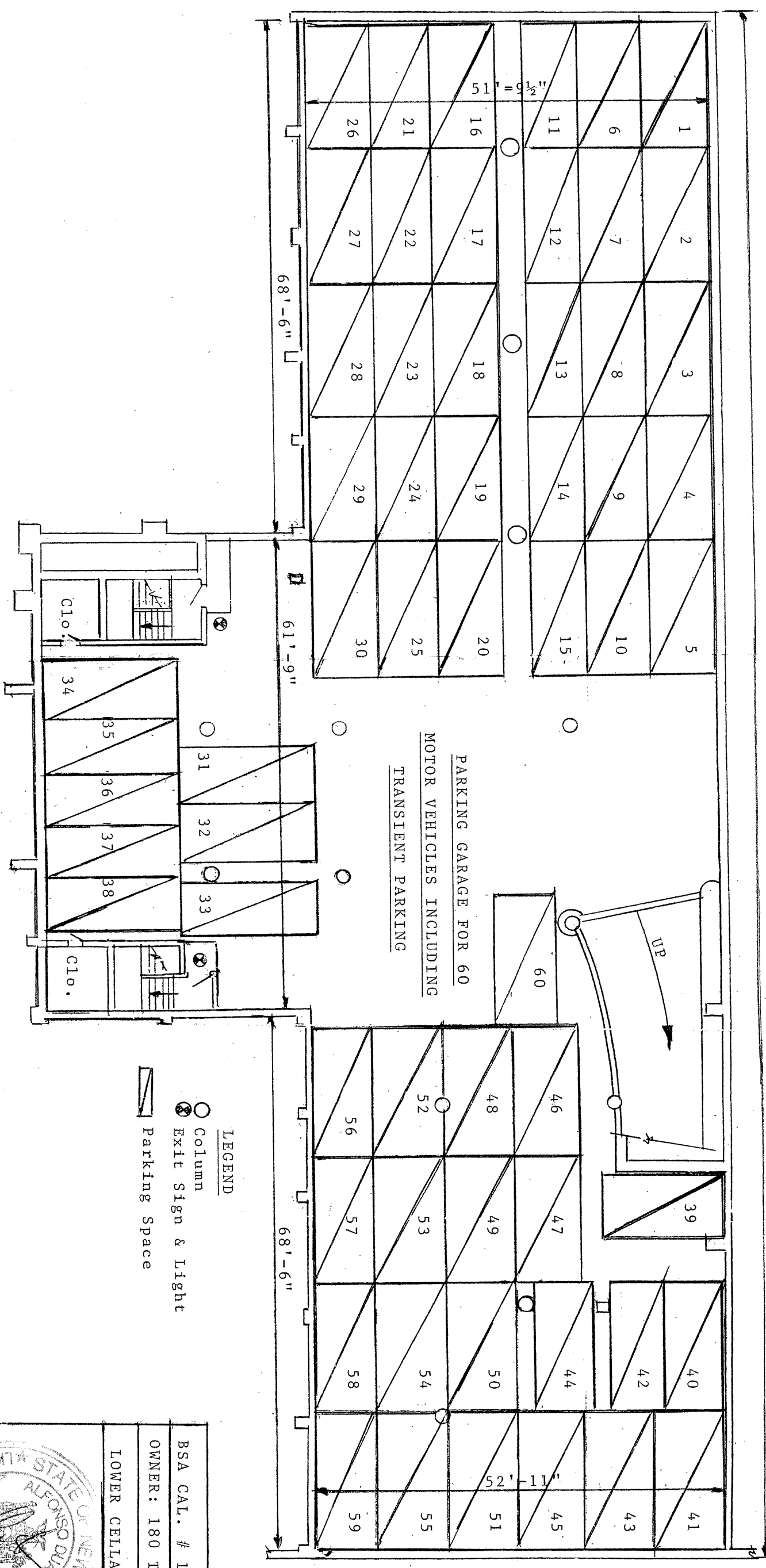

PLAN OF LOWER CELLAR

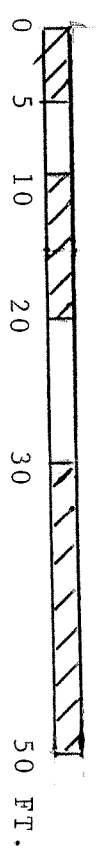

BAR SCALE

- LEGEND**
- Column
 - ⊙ Exit Sign & Light
 - ▨ Parking Space

EXISTING & PROPOSED CONDITIONS

ALFONSO DUARTE
 PROFESSIONAL ENGINEER
 199-14 24th ROAD
 WHITESTONE, N.Y. 11357
 (718) 362-2764

PREMISES
 180 East End Avenue
 Manhattan, New York

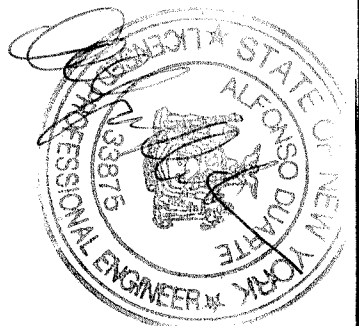

DWG. A-002.00
 SHEET 2 OF 3

4-25-13
 DATE

BSA CAL. # 190-92-BZ
 OWNER: 180 TENANTS CORP.
 LOWER CELLAR PLAN

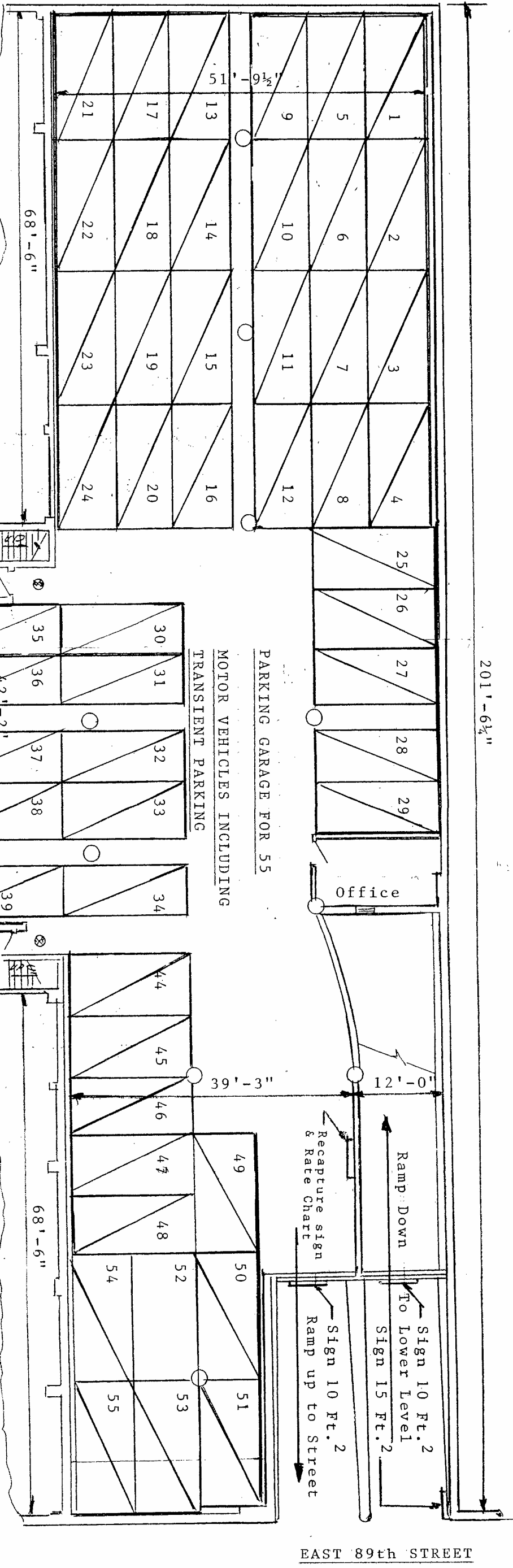

PLAN OF UPPER CELLAR

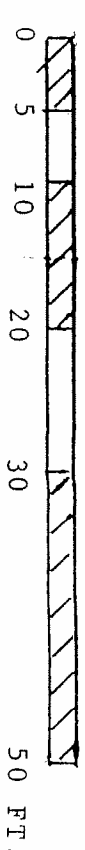

EXISTING & PROPOSED CONDITIONS

ALFONSO DUARTE
 PROFESSIONAL ENGINEER
 199-14 24th ROAD
 WHITESTONE, N.Y. 11357
 (718) 352-2764

PREMISES
 180 East End Avenue
 Manhattan, New York

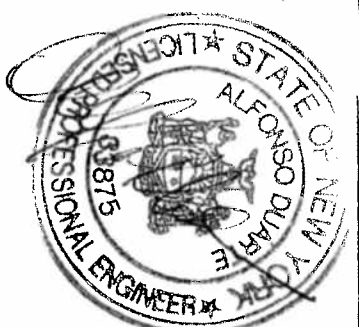

BSA CAL. # 190-92-BZ
 OWNER: 180 TENANTS CORP.
 UPPER CELLAR PLAN

DWG. A-003.00
 SHEET 3 of 3
 4-25-13
 date