

NEW YORK CITY DEPARTMENT OF
DESIGN + CONSTRUCTION

**RCONSTRUCTION OF
E 81ST STREET PEDESTRIAN BRIDGE**

Over

FDR DRIVE

BOROUGH OF MANHATTAN

COMMUNITY BOARD 8M

FEBRUARY 04, 2015

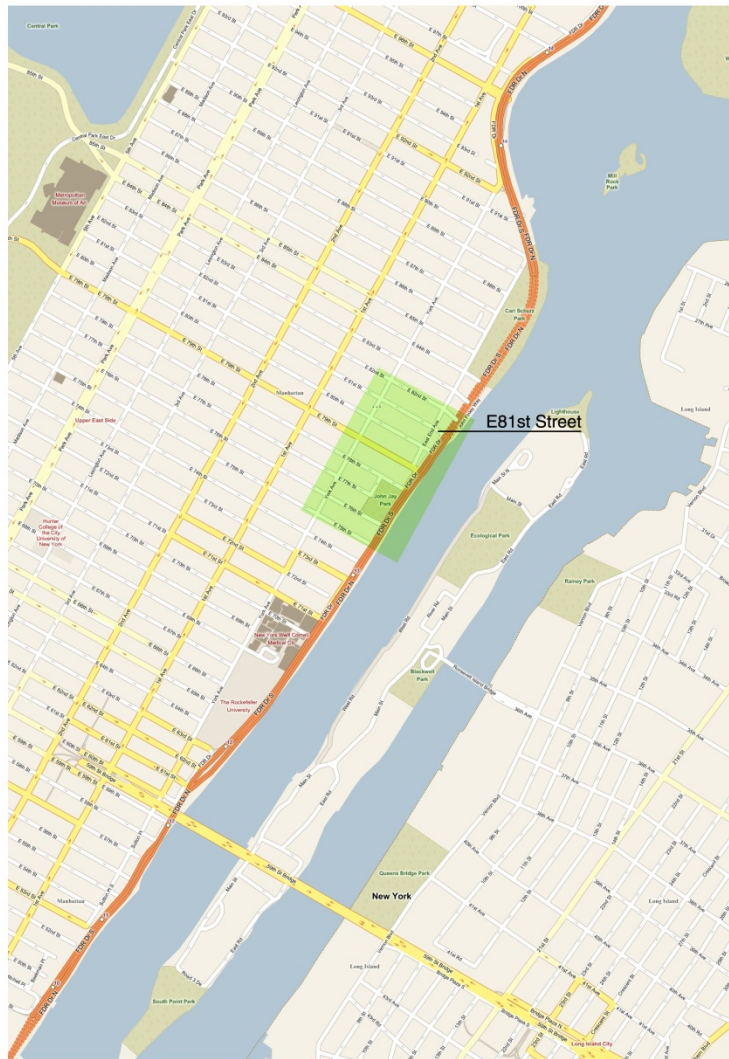

Above: Area Map
 Top Right: Aerial Photograph of Site Context
 Bottom Right: Composite Panoramic View of E81st St Site from Roosevelt Island

PROPOSED BRIDGE

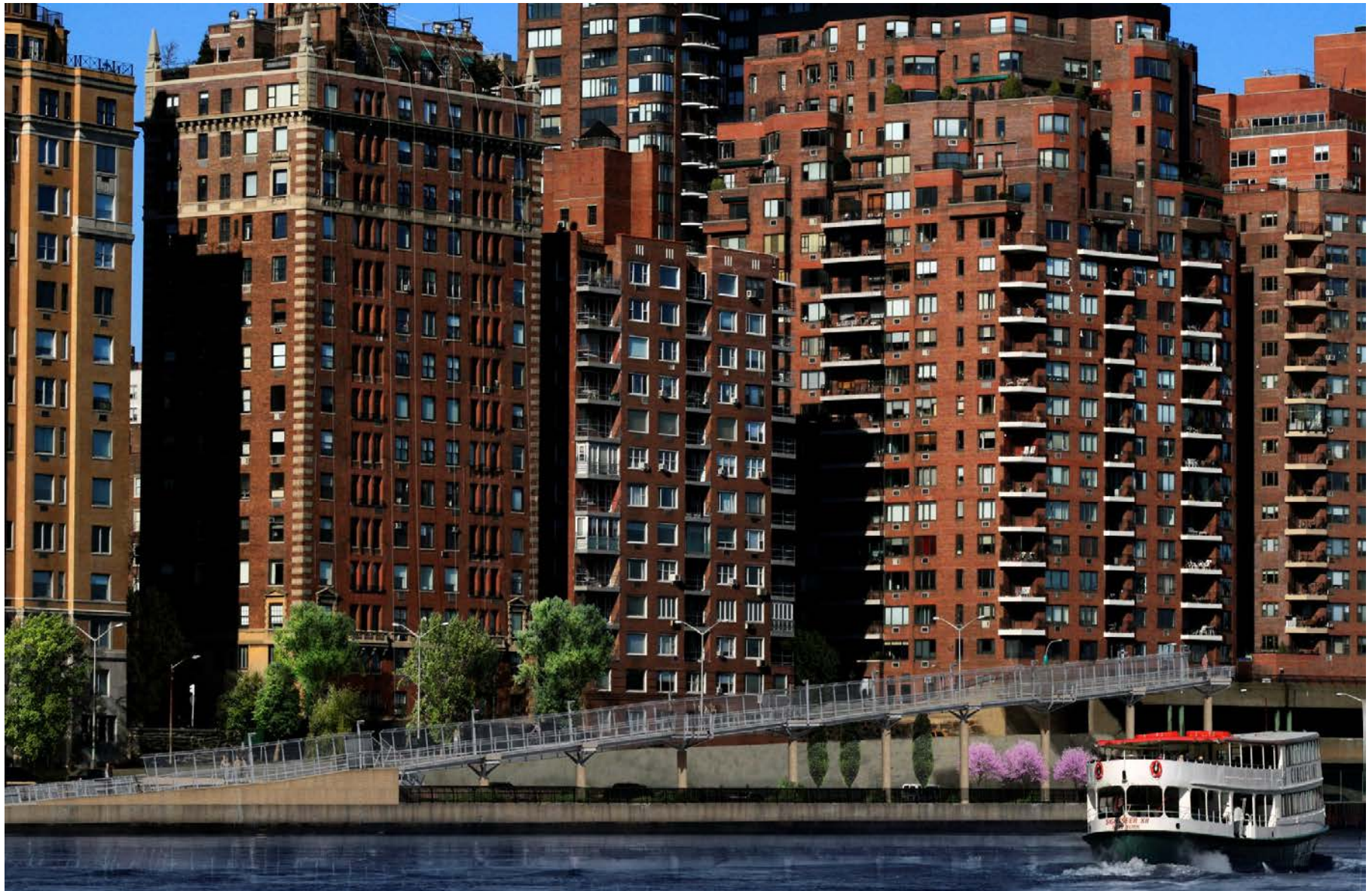



PDC PRESENTATIONS

JUNE 04, 2012

JUNE 25, 2012

JULY 16, 2012

SEPTEMBER 10, 2012



EAST 81ST STREET PEDESTRIAN BRIDGE

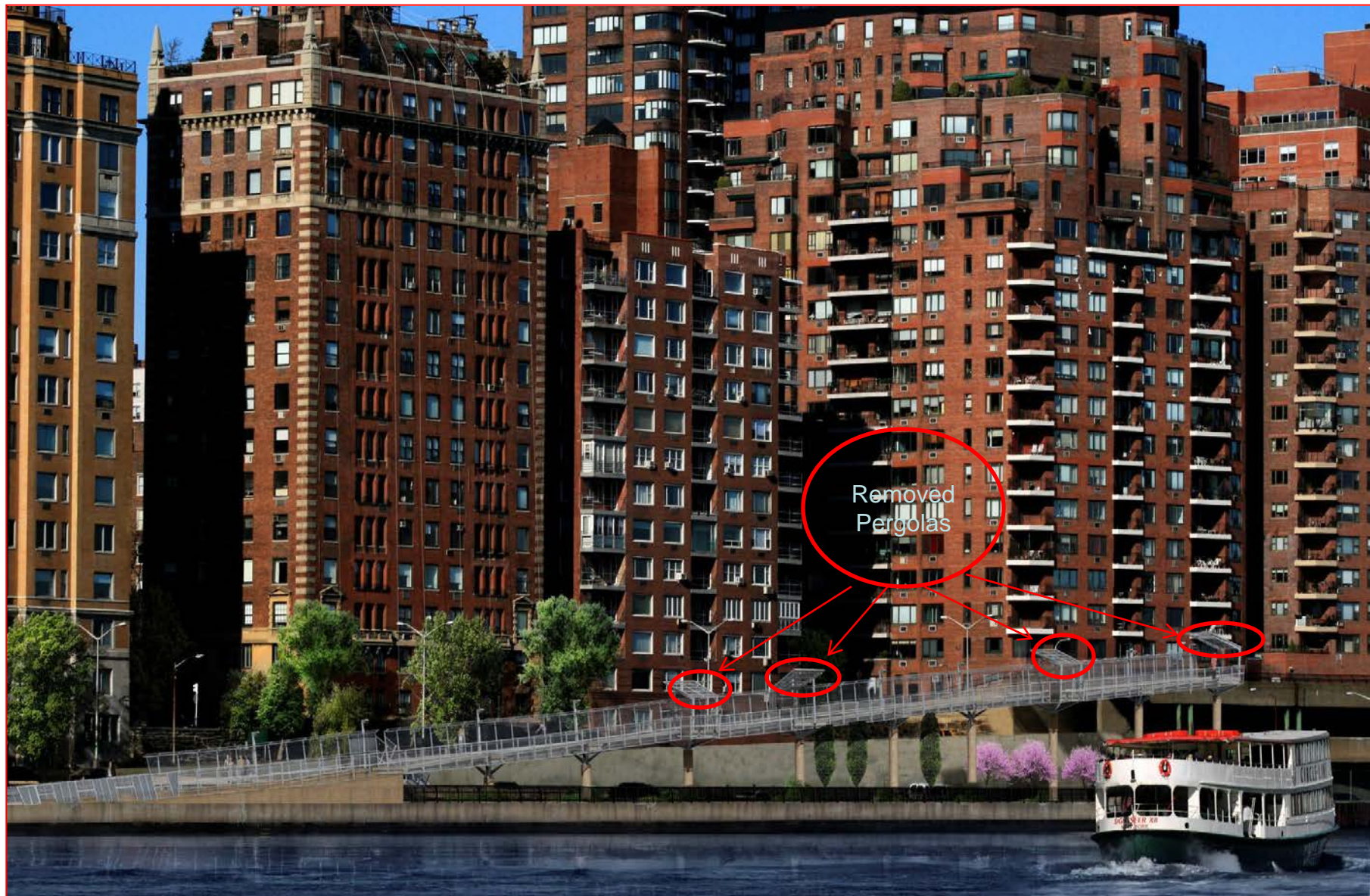



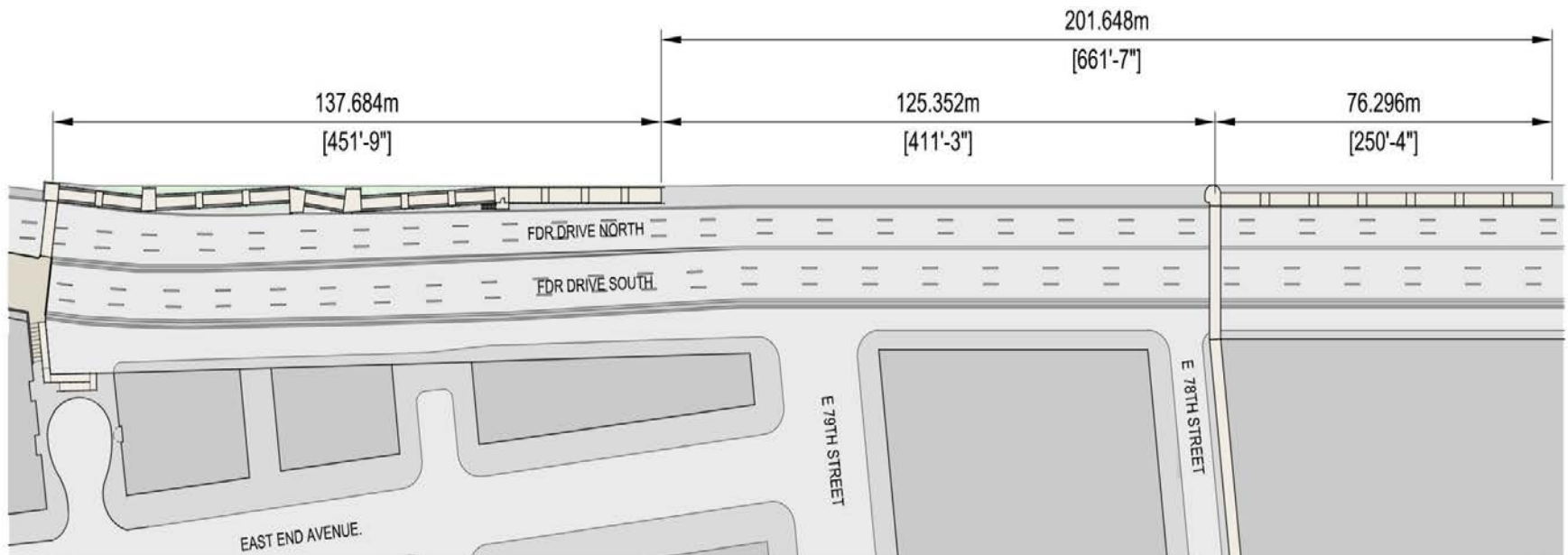

Esplanade Ramp



Low Fence and Railing



Bridge looking East

OCTOBER 01, 2012
PDC PRESENTATION

AGENDA

- **Review East Fence Option #1**
 - 78th Street Picket Fence Adaptation, no Pergolas
- **Review East Fence Option #2**
 - Picket Fence Reinterpretation, no Pergolas
- **Review East Fence Option #3**
 - Lower Mesh Fence with Pergolas
- **Review Benches & West Fence Design**



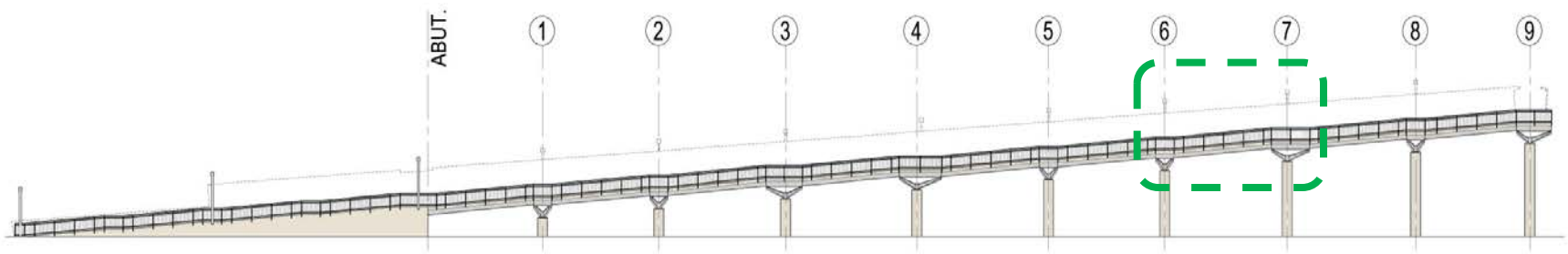

Overall East Elevation

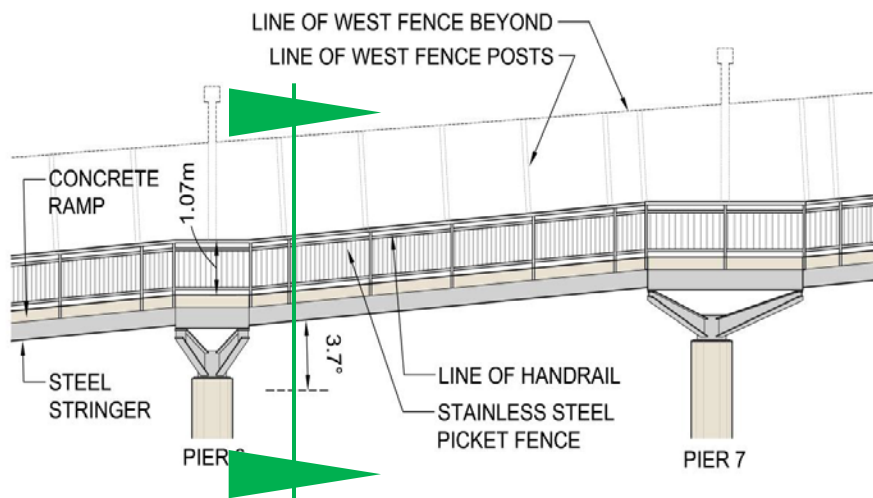

East Fence Detail

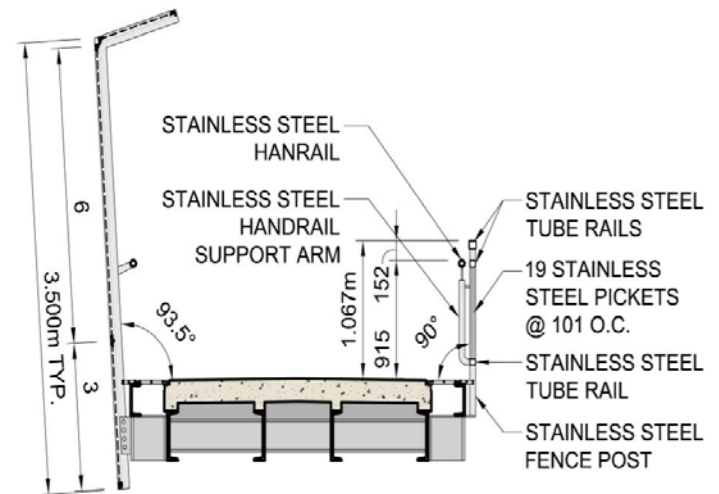

Typical Section

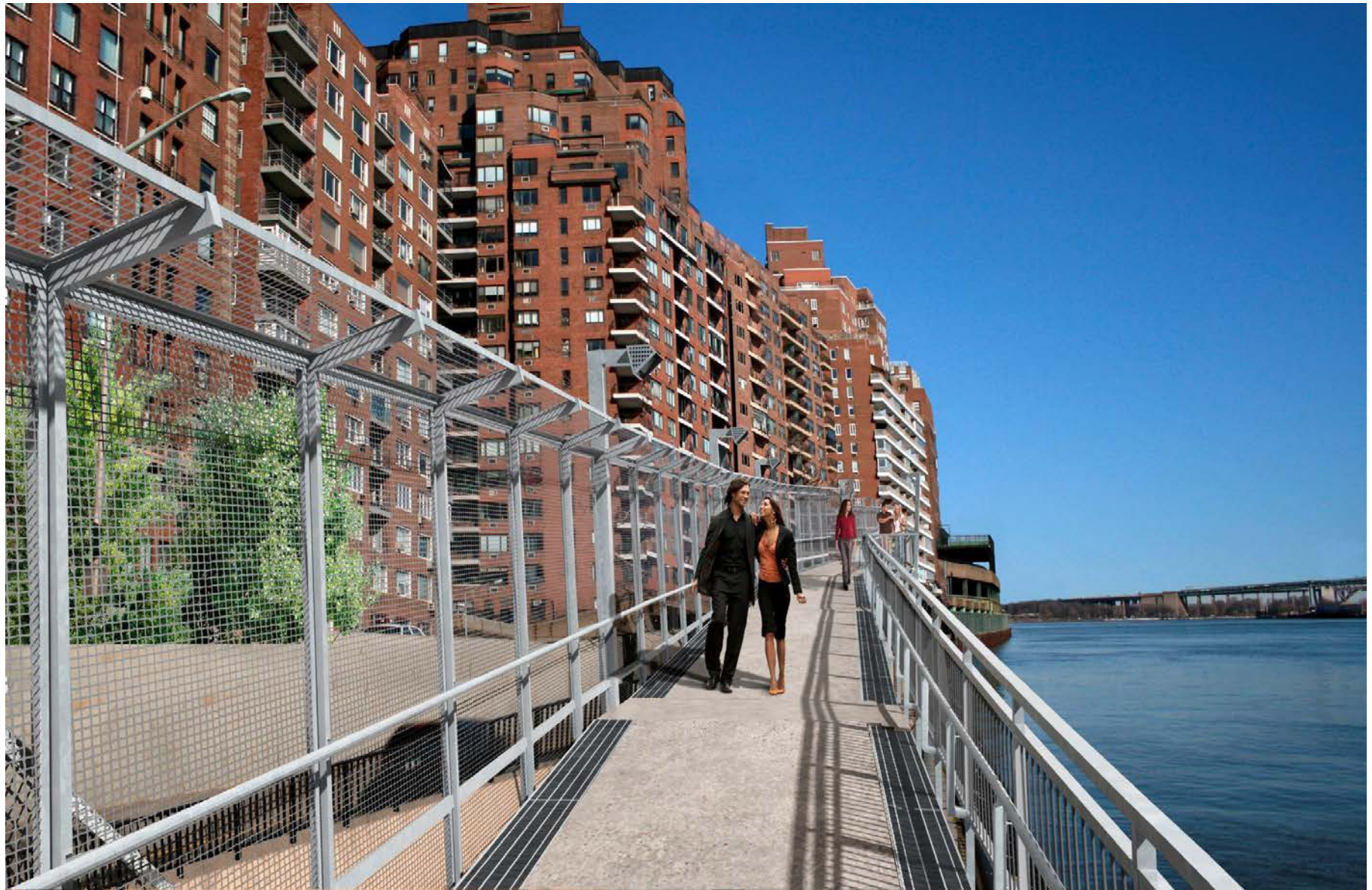

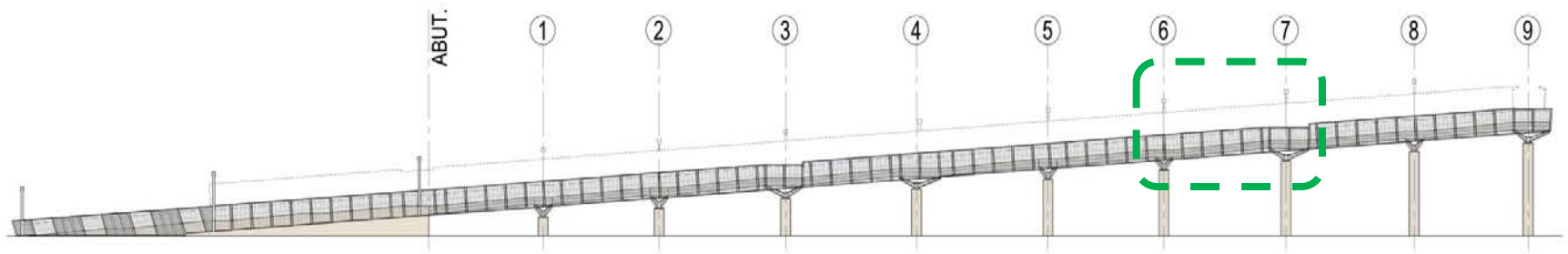

Overall East Elevation

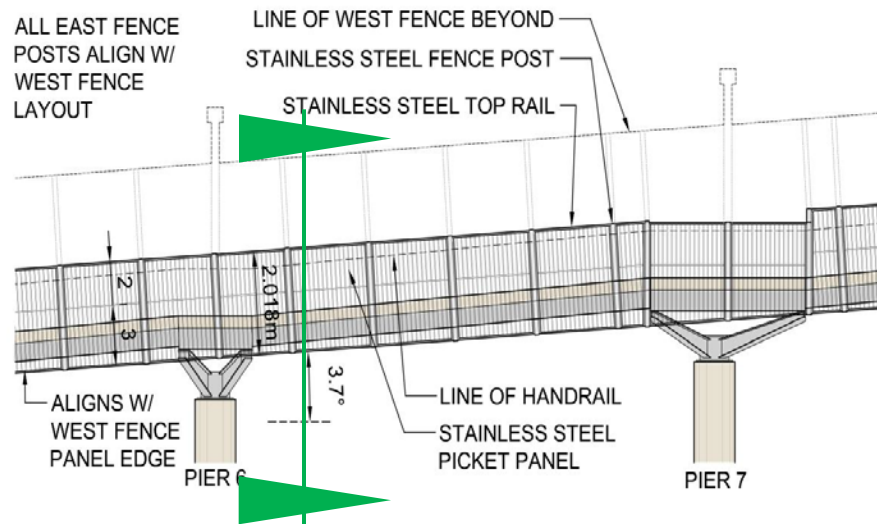

East Fence Detail

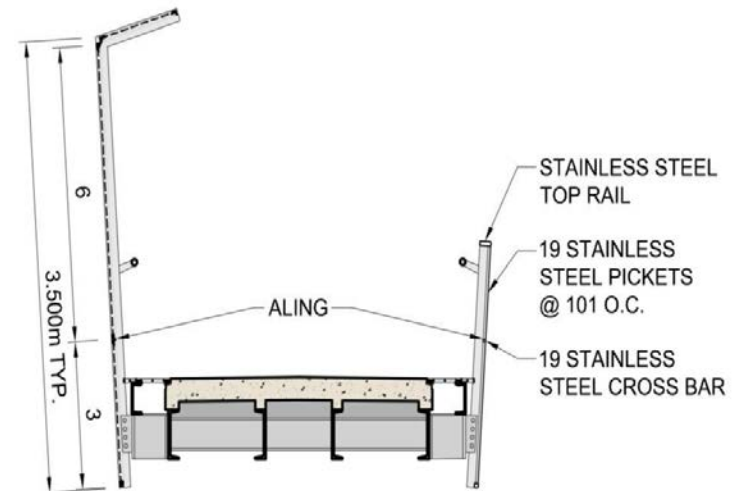

Typical Section

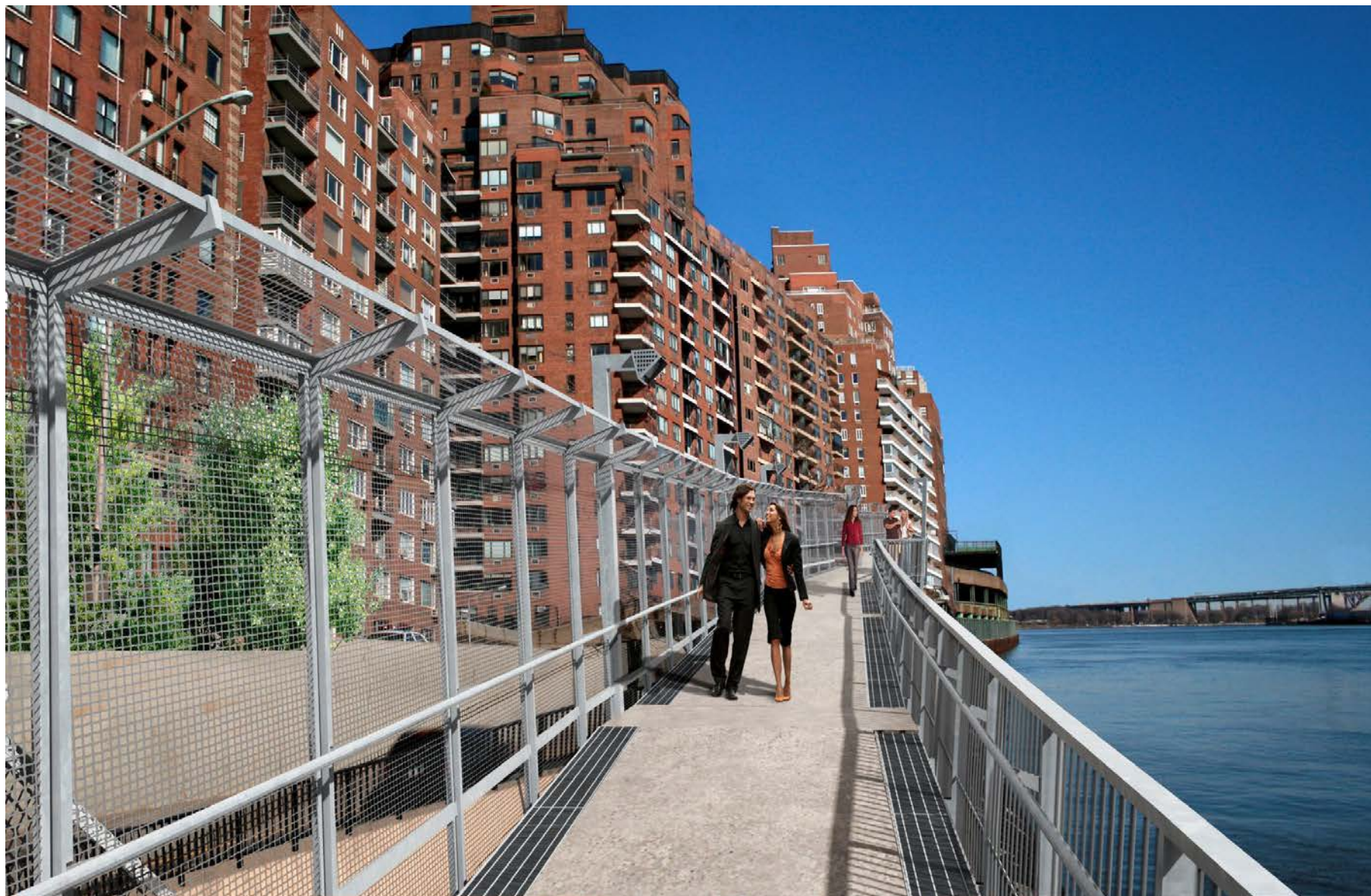

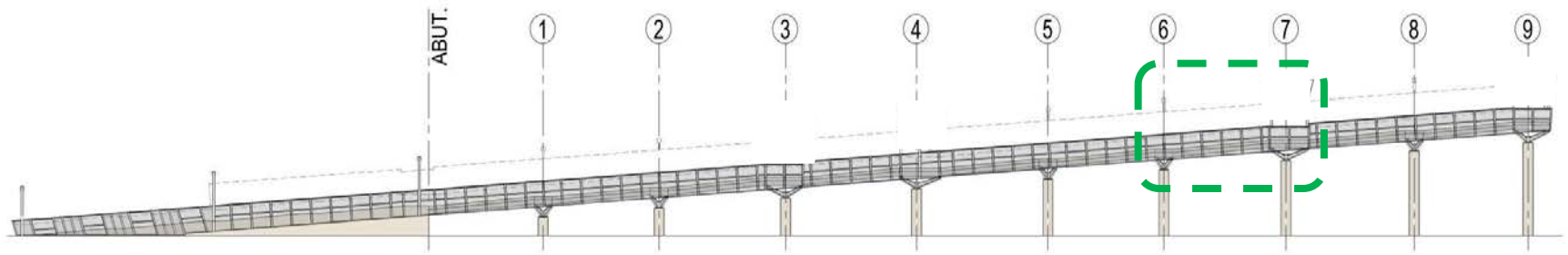

Overall East Elevation

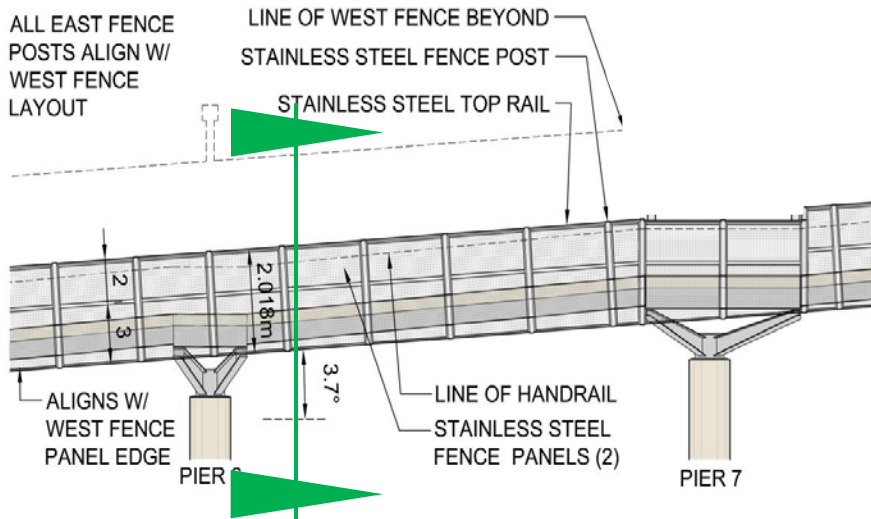

East Fence Detail

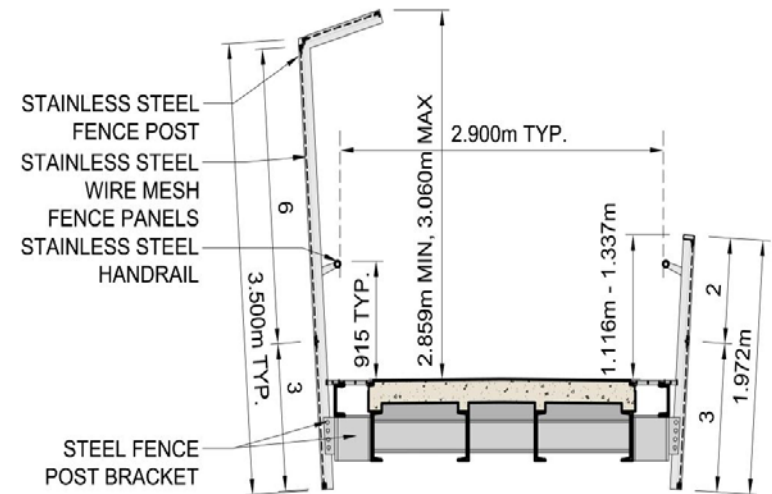

Typical Section

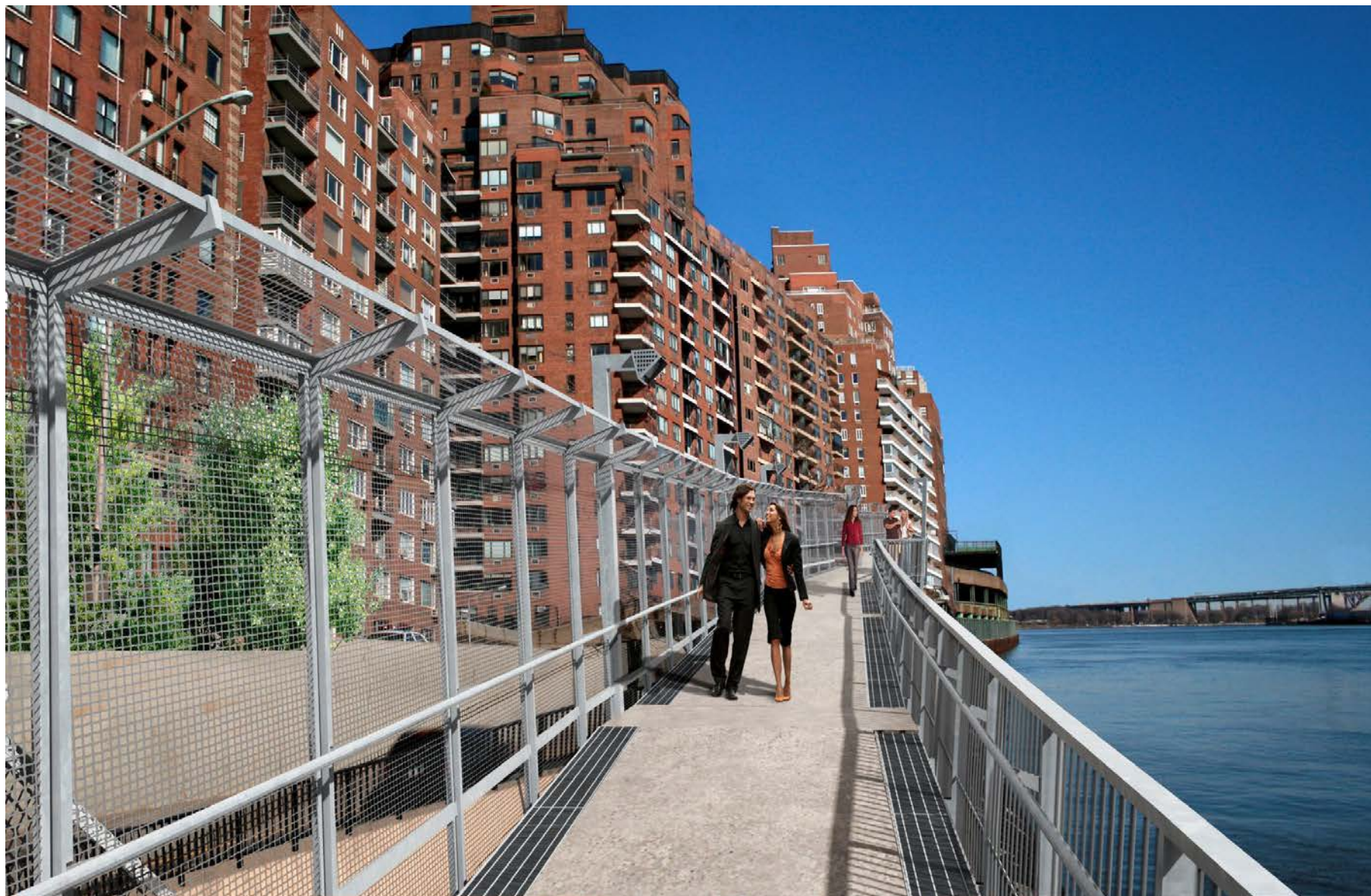

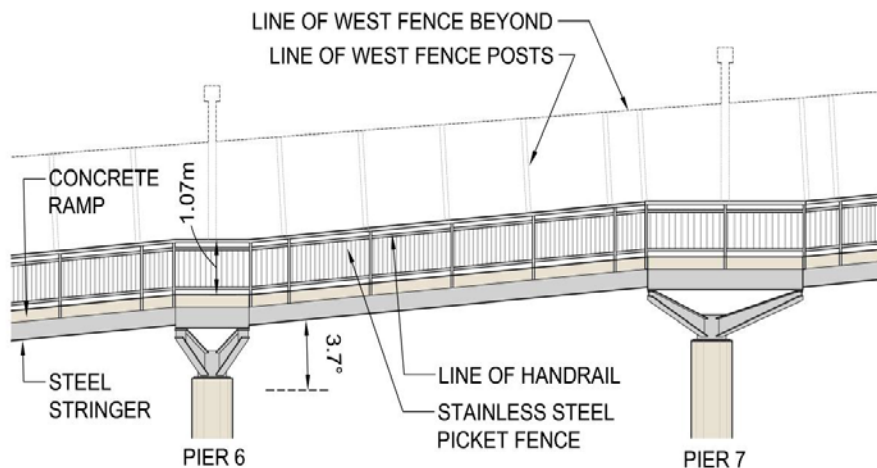

Option #1

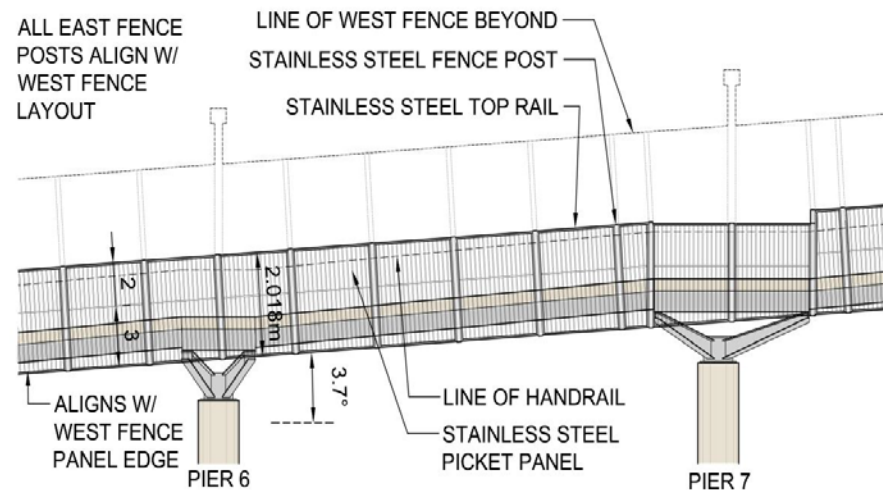

Option #2

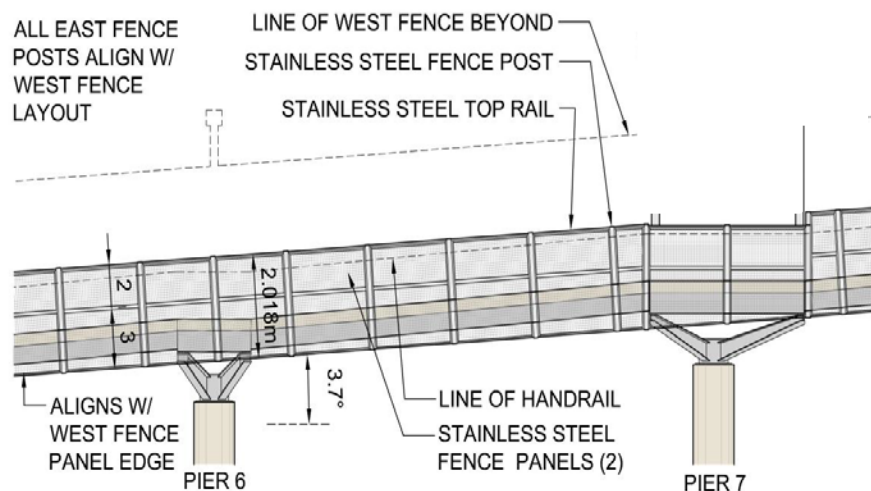

Option #3





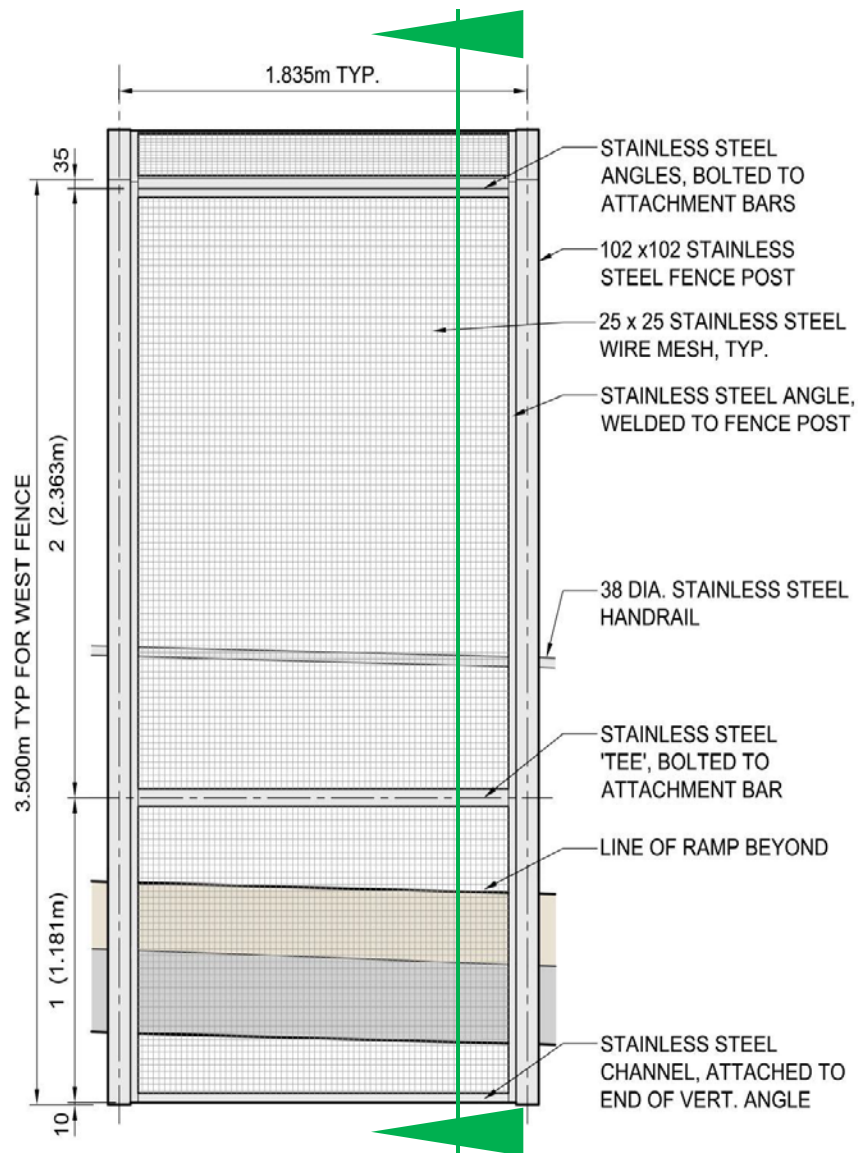

Typical Fence Panel

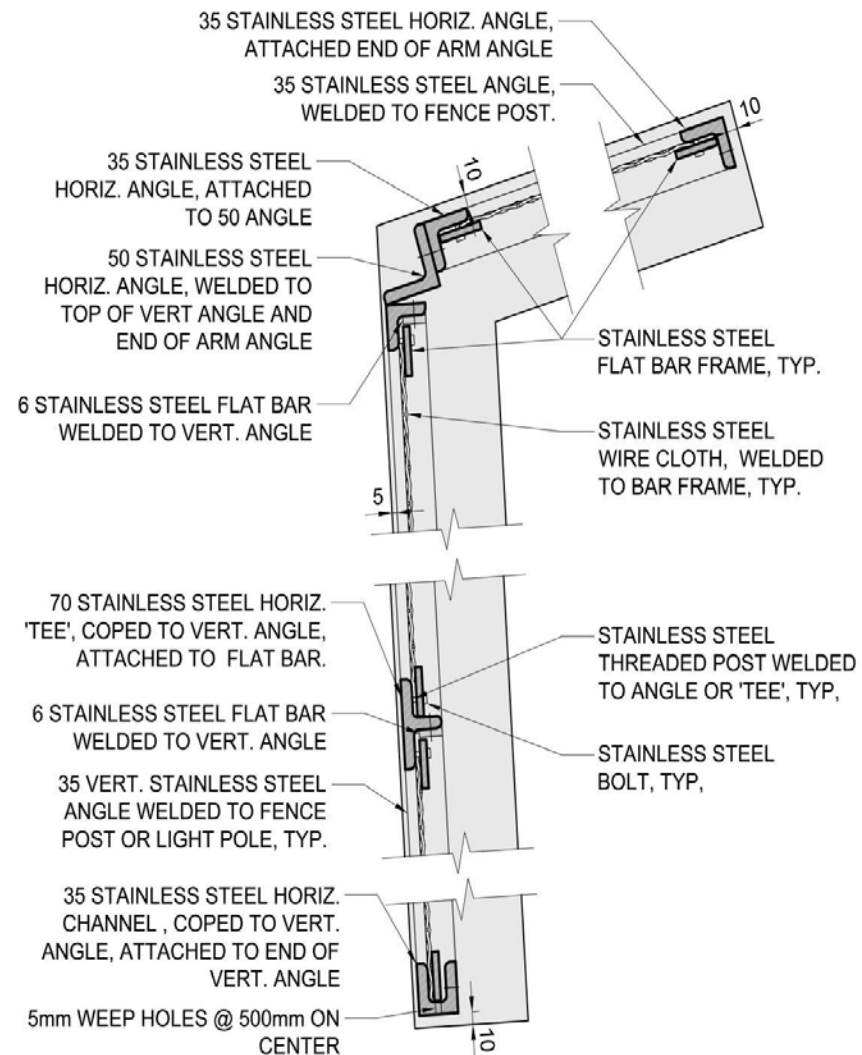

Section – Fence Pane

**EAT 81ST STREET
RAMP**

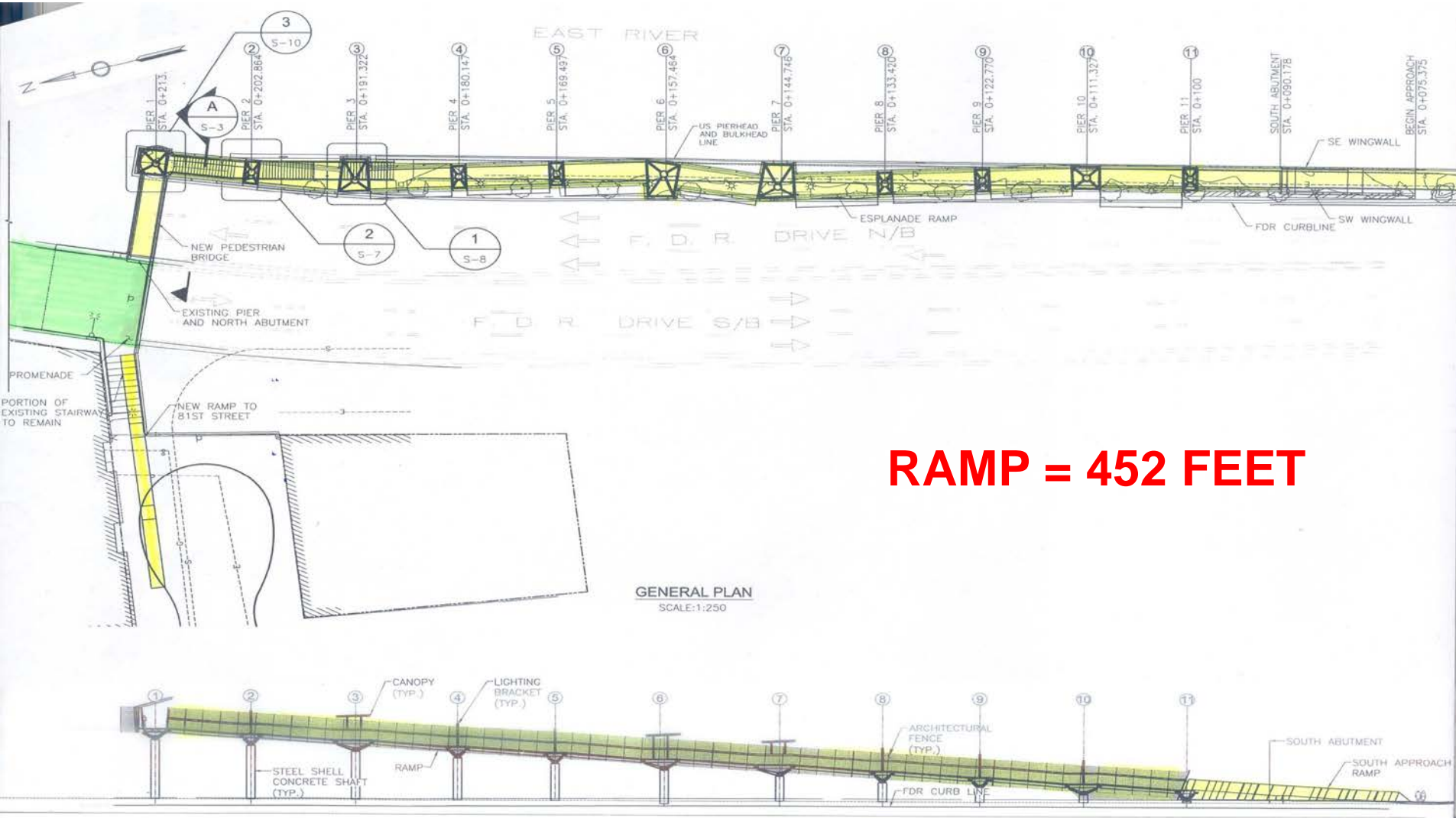

E81st STREET – PROPOSED PLAN, ELEVATION

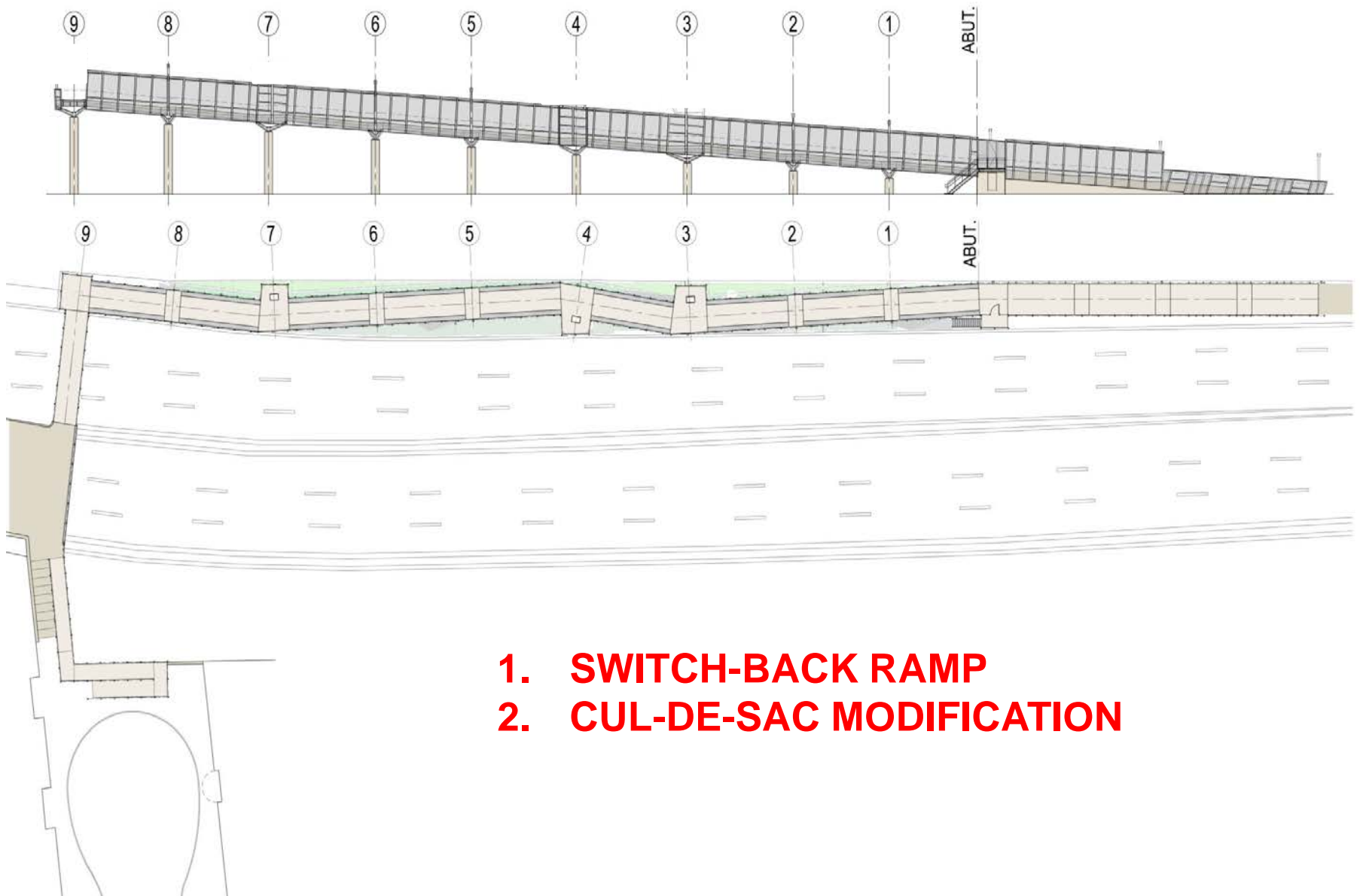

1. SWITCH-BACK RAMP
2. CUL-DE-SAC MODIFICATION

FIELD OFFICE

Field Office Trailer Location 4: North View



24x56 Complex

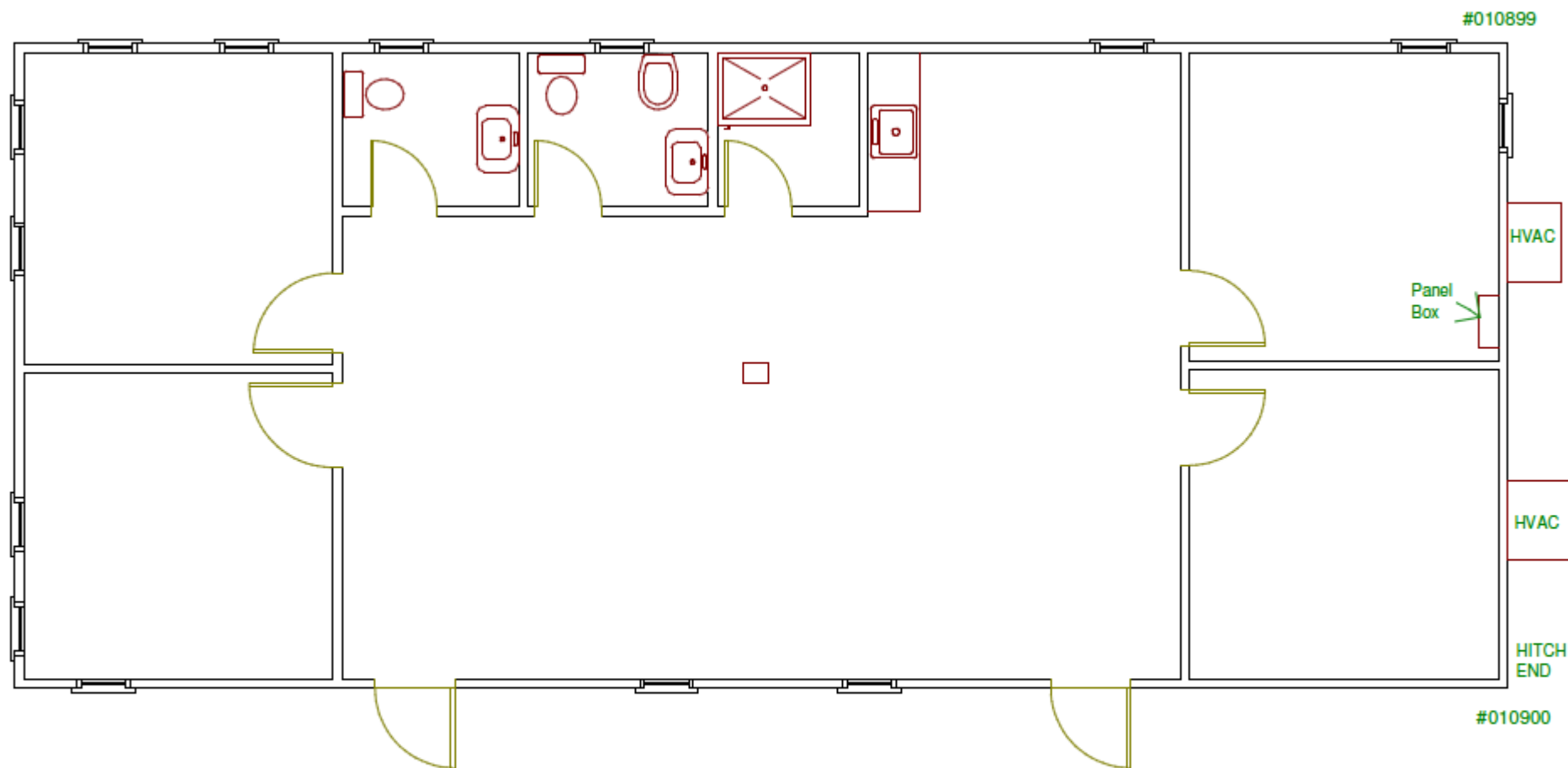

Unit #'s 010899 & 010900

SCHEDULE

RECONSTRUCTION OF PEDESTRIAN BRIDGE AT E81st STREET OVER FDR DRIVE

SCHEDULE AND DURATION

[illegible]

THANK YOU



NEW YORK CITY DEPARTMENT OF
DESIGN + CONSTRUCTION