



# **ADA ELEVATORS AT 68TH STREET STATION**

LEXINGTON AVENUE LINE (IRT)  
BOROUGH OF MANHATTAN

# **PROJECT OBJECTIVES**

- **Provide Accessibility for the Disabled**
  - » **Designated Key Station**
- **Relieve Severe Congestion**
  - » **Second Busiest Local Station in Subway System**
  - » **Busiest Single Fare Control Area of all Local Stations**

# UPPER EAST SIDE

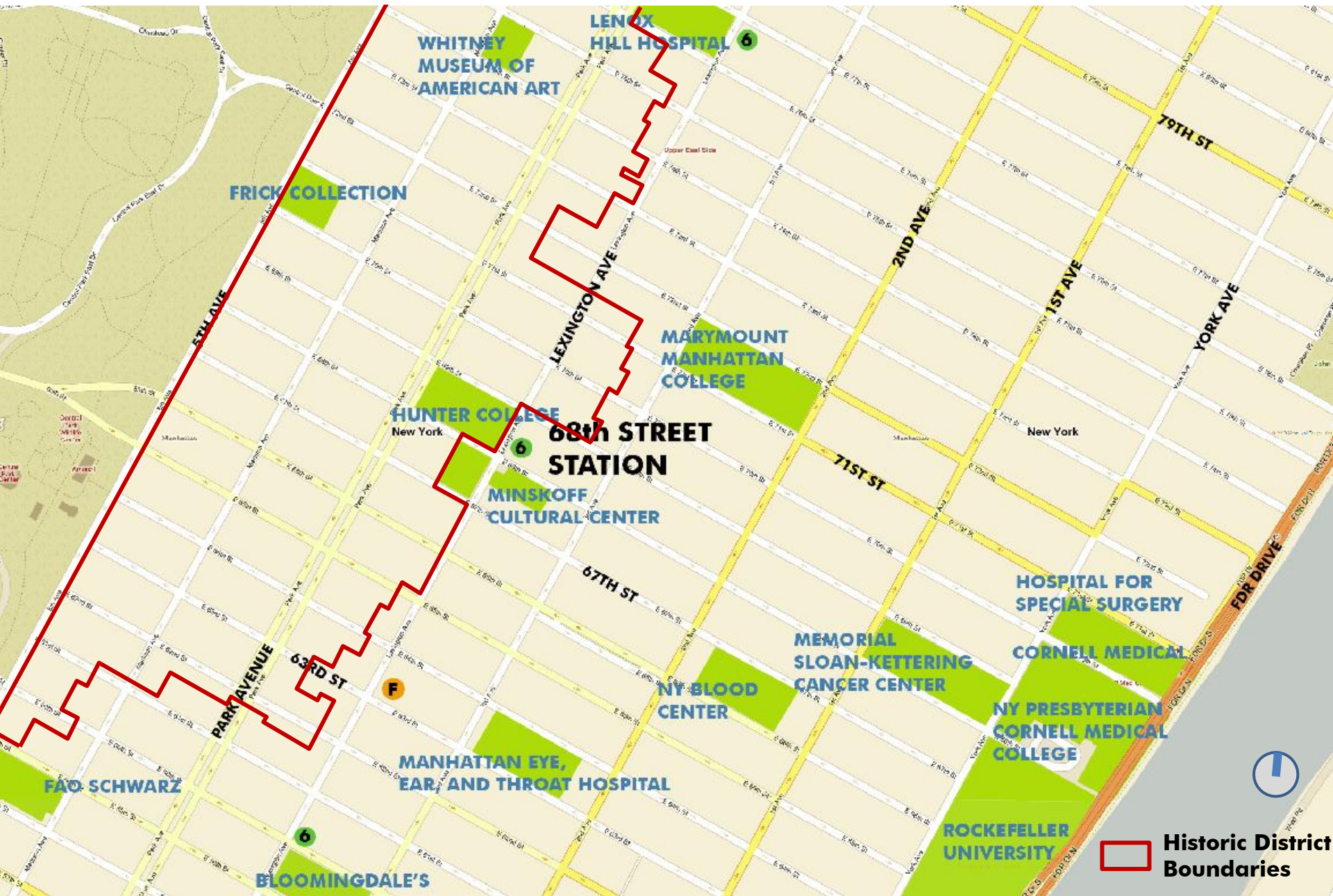



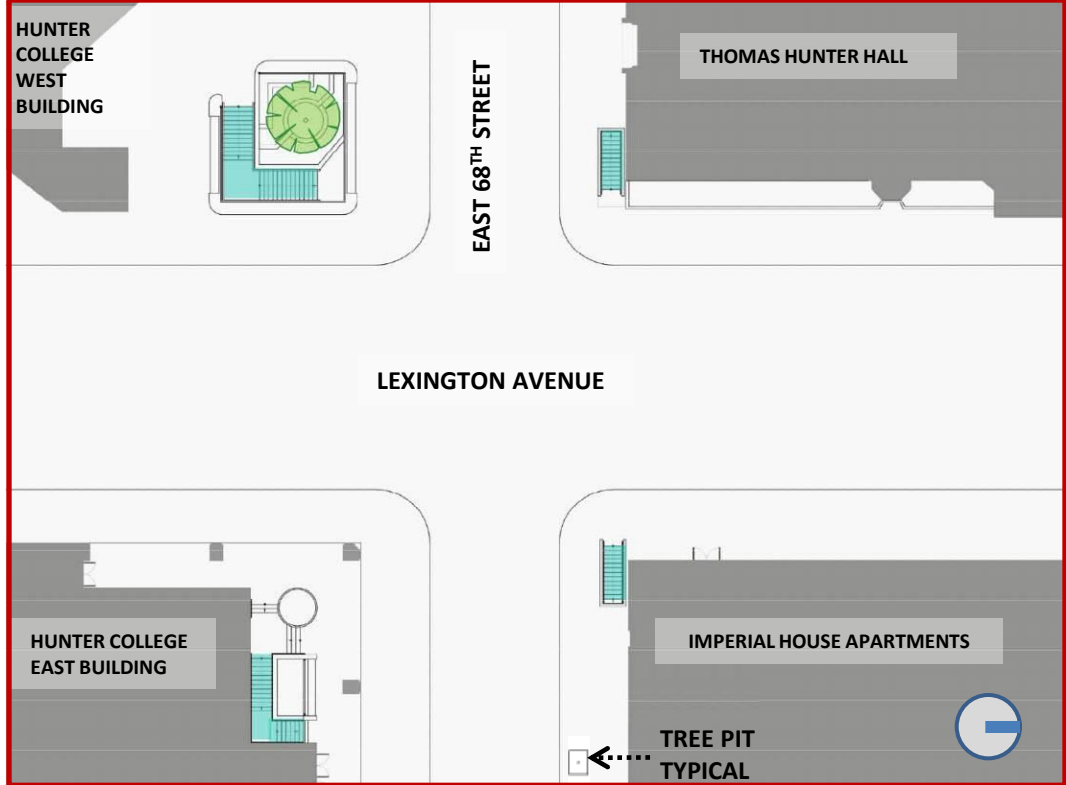

**68<sup>TH</sup> ST / LEX AVE**



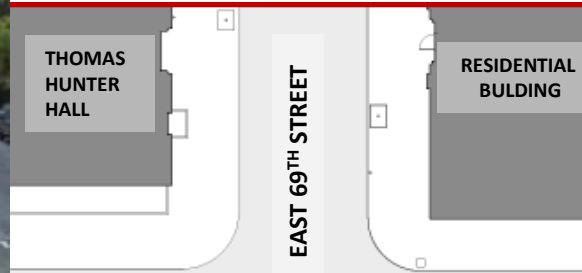

**69<sup>TH</sup> ST / LEX AVE**



# **SCOPE OF WORK**

- **Installation of 3 ADA Elevators**
- **Widen Street Stairs at 68<sup>th</sup> Street NE & SE Corners**
- **New Street Access at 69<sup>th</sup> Street SE & SW Corners**

# **ENTRANCE STUDY ALTERNATIVES**



# ENTRANCE STUDY ALTERNATIVES AT WEST SIDE OF 69<sup>TH</sup> STREET

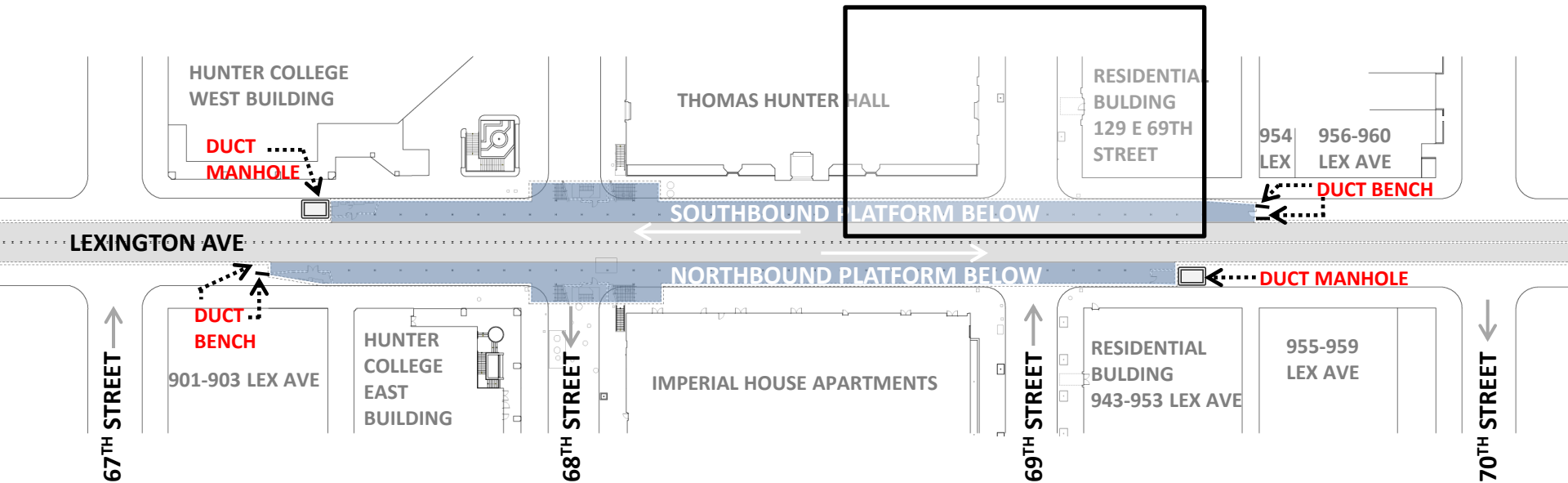



# 69TH STREET ENTRANCE STUDY - ALTERNATIVE W1

## SW CORNER

- **9' Wide stair**
- **Emergency Exit Door of Thomas Hunter Hall maintained**
- **Loading dock of Thomas Hunter Hall maintained**
- **Stair clears ECS duct bank**
- **4 Parking spaces removed**
- **2 Trees removed**

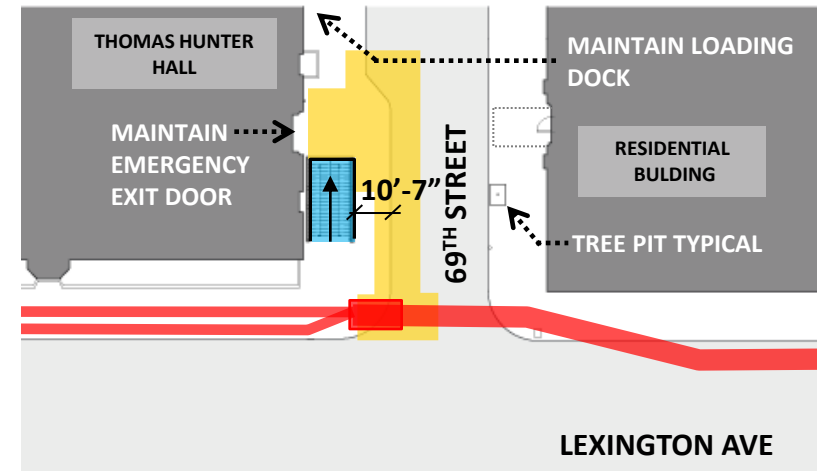

# 69TH STREET ENTRANCE STUDY - ALTERNATIVE W2

## SW CORNER

- **Two 5' wide stairs**
- **Emergency Exit Door of Thomas Hunter Hall maintained**
- **Stair clears ECS duct bank**
- **5 Parking spaces removed**
- **2 Trees removed**

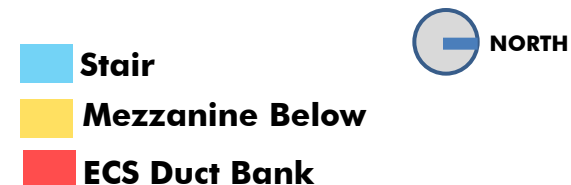
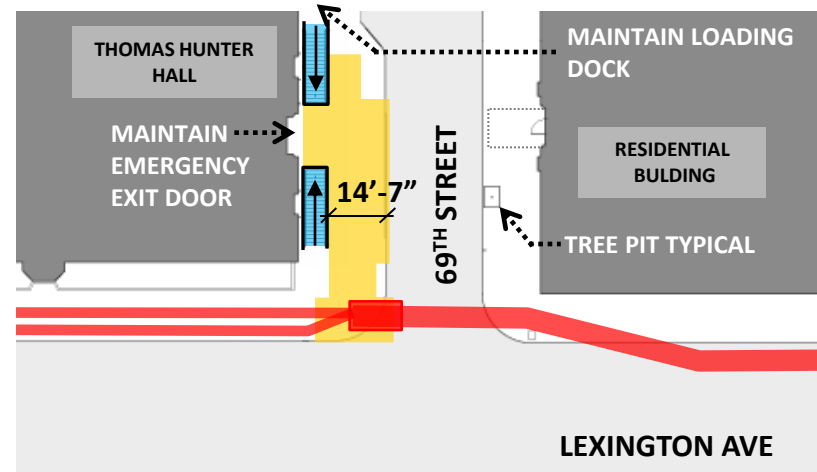

# 69TH STREET ENTRANCE STUDY - ALTERNATIVE W3

## SW CORNER

- **9' Wide stair**
- **8' Curb extension of Lex Ave required to accommodate stair**
- **Bus lane interference due to curb extension**
- **Stair interferes with ECS duct bank below**
- **4 Parking spaces removed**
- **1 Tree removed**
- **Additional construction cost and duration**

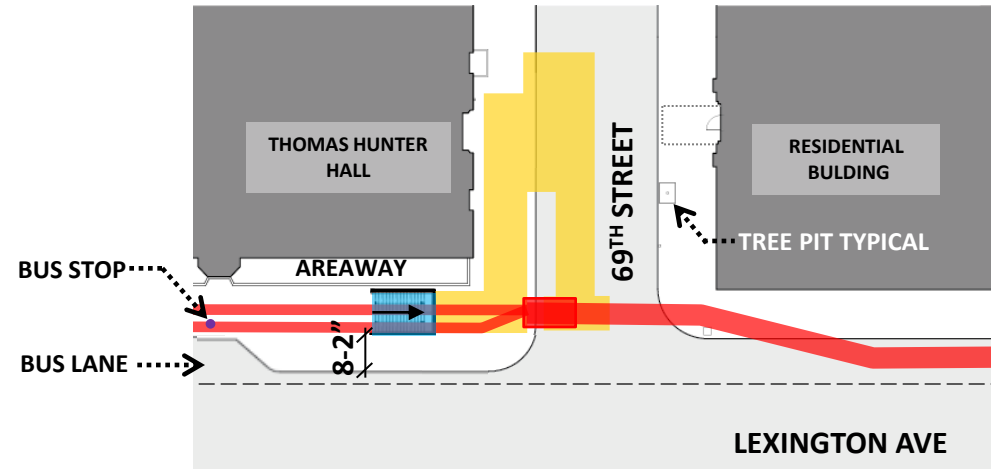

# 69TH STREET ENTRANCE STUDY - ALTERNATIVE W4

## NW CORNER

- **9' Wide stair**
- **8' Curb extension of Lex Ave required to accommodate stair**
- **Bus lane interference due to curb extension**
- **Stair interferes with ECS duct bank below**
- **4 Parking spaces removed**
- **1 Tree removed**
- **Additional construction cost and duration**

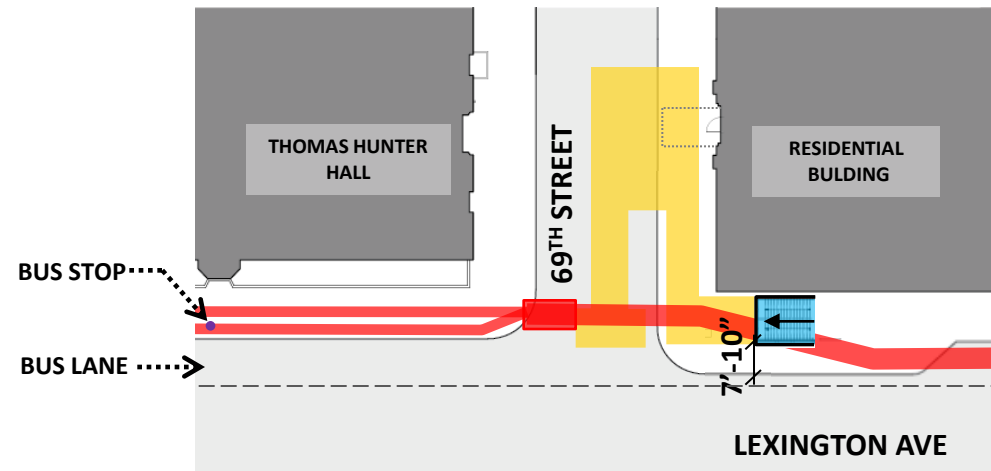



# 69TH STREET ENTRANCE STUDY - ALTERNATIVE W5

## NW/SW CORNER

- **Two 5' wide stairs**
- **8' Curb extension of Lex Ave required to accommodate stair**
- **Bus lane interference due to curb extension**
- **Stair interferes with ECS duct bank below**
- **8 Parking spaces removed**
- **2 Trees removed**
- **Additional construction cost and duration**

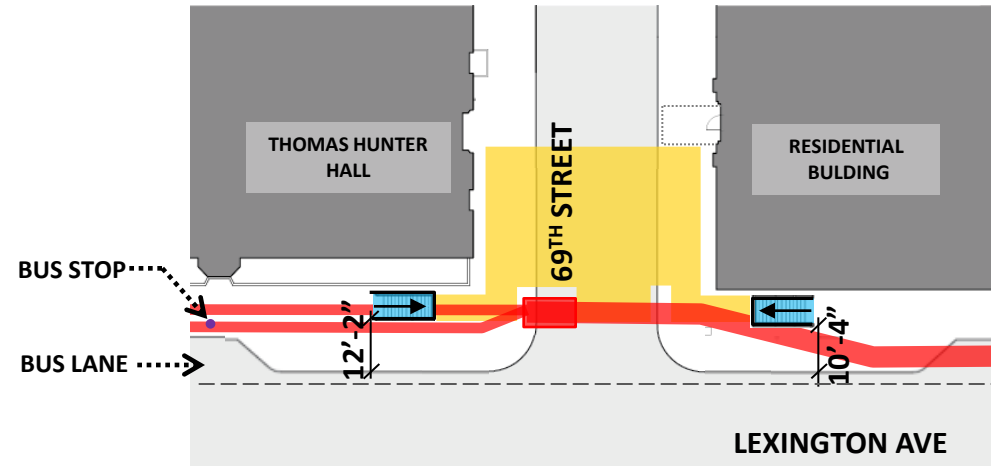

# 69TH STREET ENTRANCE STUDY - ALTERNATIVE W6

## NW CORNER

- **Two 5' wide stairs**
- **Stair clears ECS duct bank**
- **5 Parking spaces removed**
- **2 Trees removed**

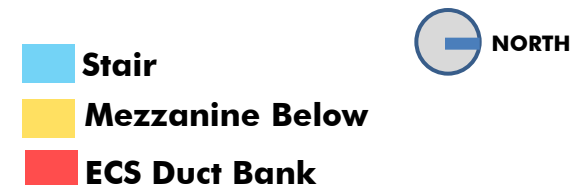
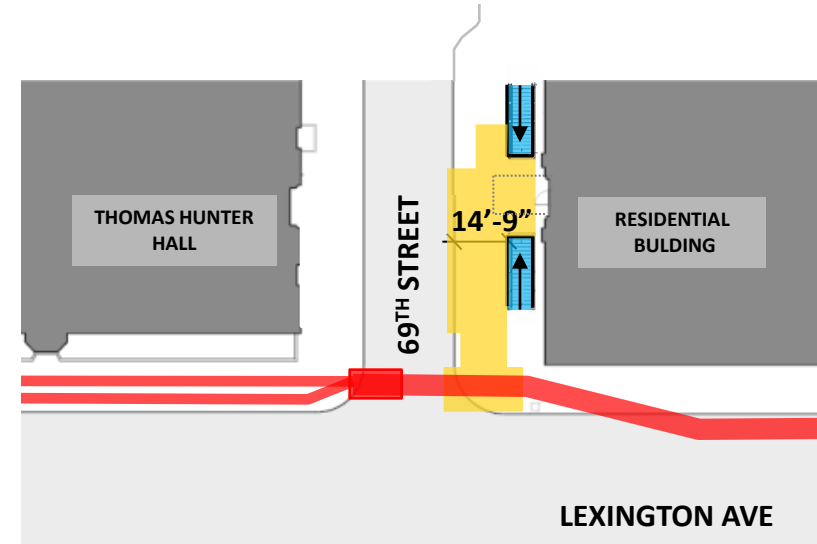

# 69TH STREET ENTRANCE STUDY - ALTERNATIVE W7

## NW CORNER

- 9' Wide stair
- Stair clears ECS duct bank
- 4 Parking spaces removed
- 1 Tree removed

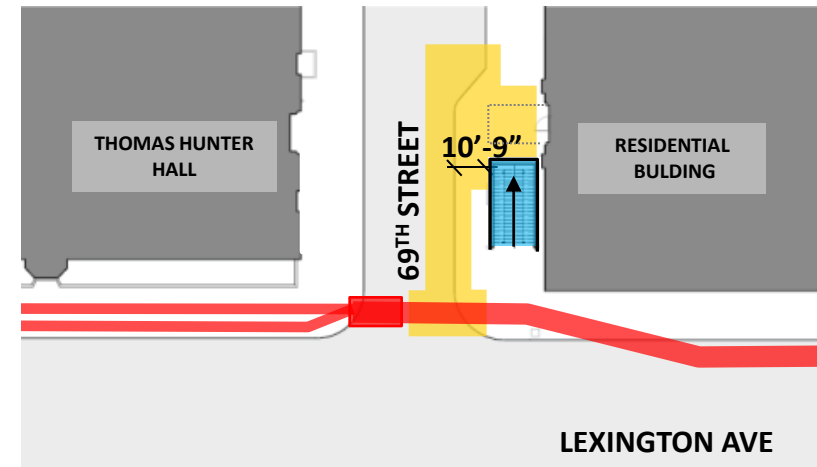

# 69TH STREET ENTRANCE STUDY - ALTERNATIVE W8

## SW/NW CORNER

- **Two 5' wide stairs**
- **Stair clears ECS duct bank**
- **4 Parking spaces removed**
- **3 Trees removed**
- **Inadequate sidewalk clearance on NW 69<sup>th</sup> Street after maximizing neck down**
- **Additional construction cost and duration**

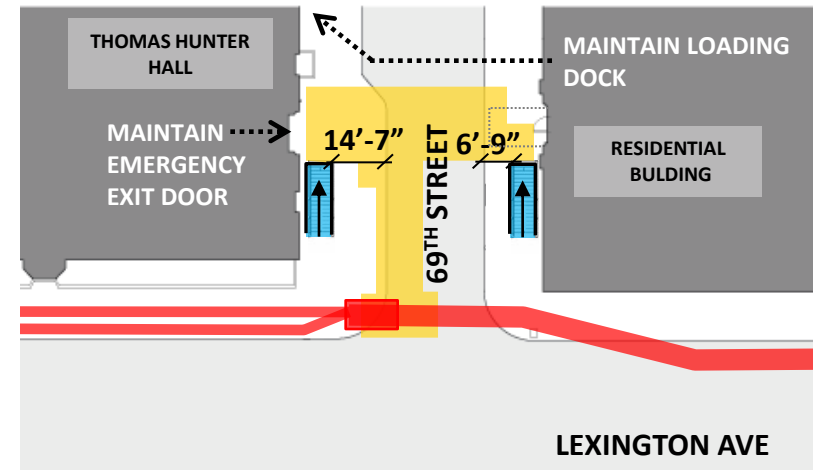



# 69TH STREET ENTRANCE STUDY - ALTERNATIVE W9

## SW CORNER

- **Two 5' wide stairs**
- **8' Curb extension of Lex Ave required to accommodate stair**
- **Bus lane interference due to curb extension**
- **Stair interferes with ECS duct bank below**
- **8 Parking spaces removed**
- **2 Trees removed**
- **Additional construction cost and duration**

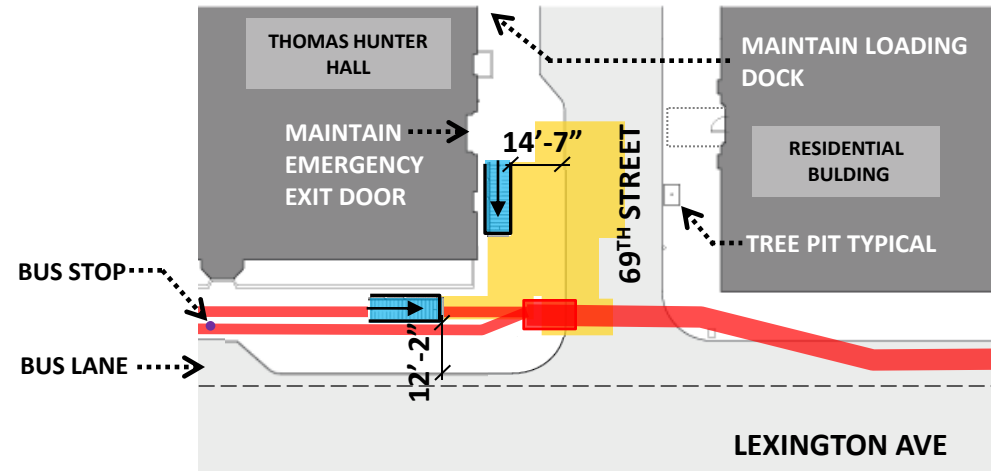

# STAIR ALTERNATIVES – WEST OF LEXINGTON AVE

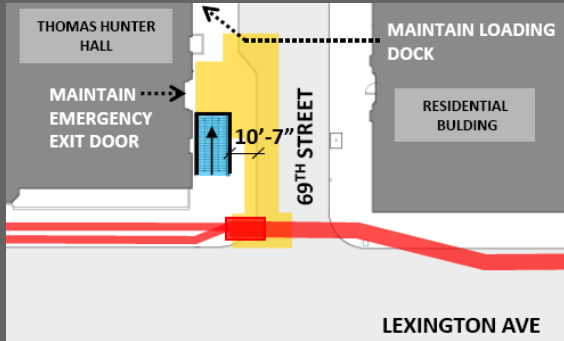

W1

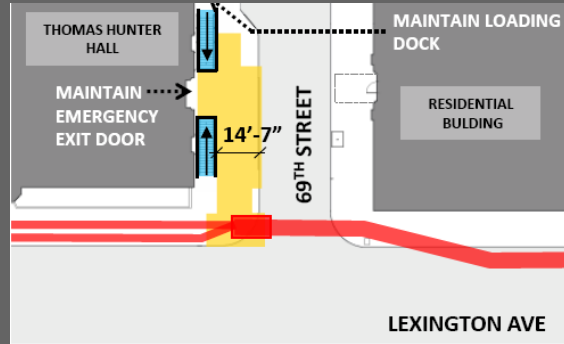

W2

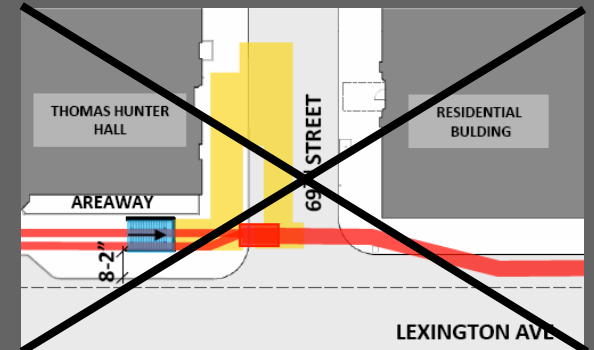

W3

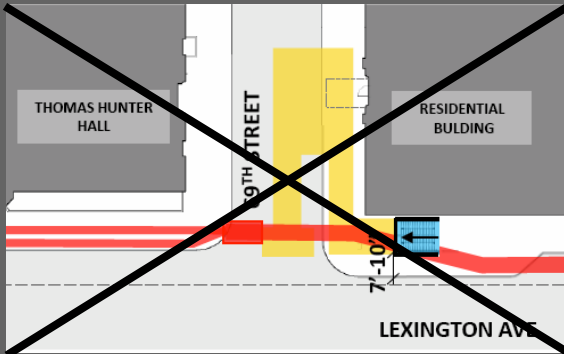

W4

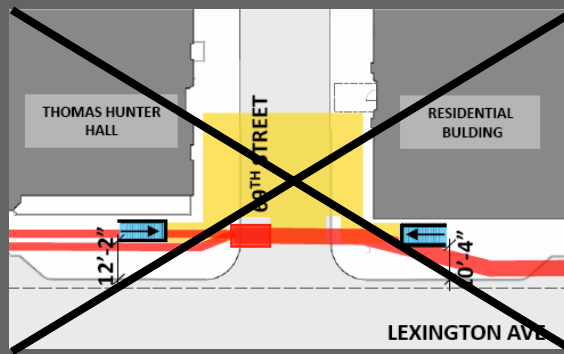

W5

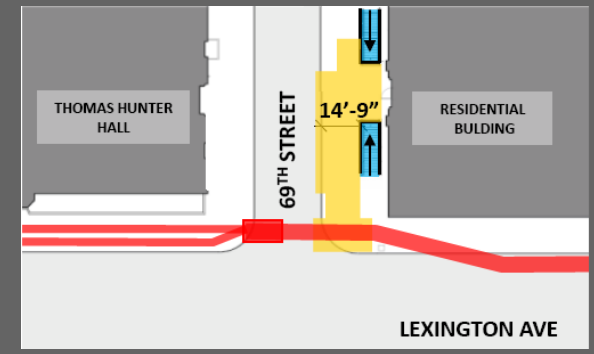

W6

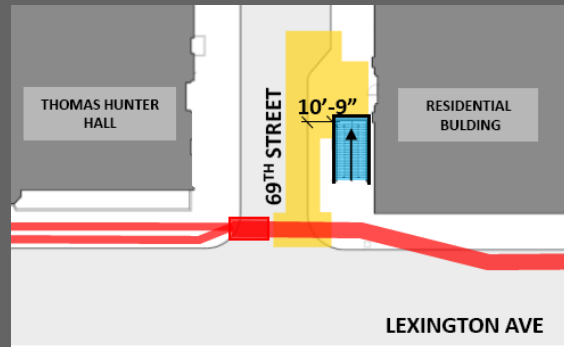

W7

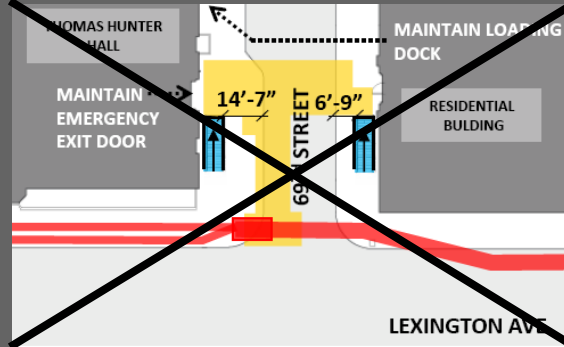

W8

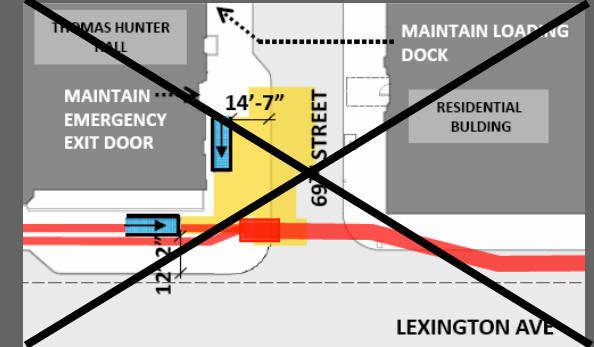

W9

# ENTRANCE STUDY ALTERNATIVES AT EAST SIDE OF 69<sup>TH</sup> STREET

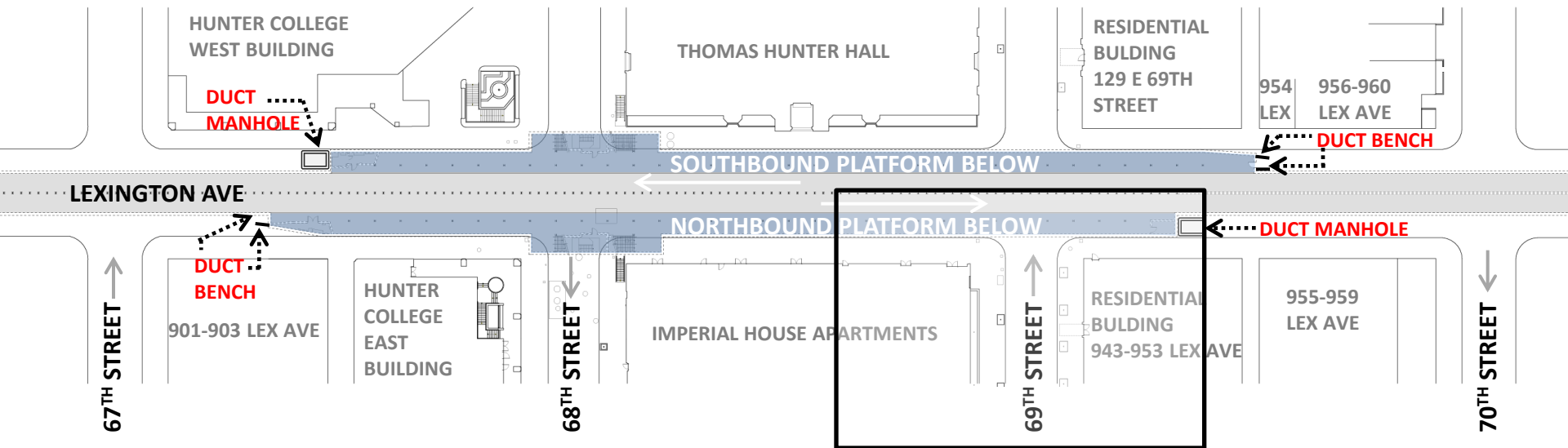

## 69TH STREET ENTRANCE STUDY - ALTERNATIVE E1

## SE CORNER

- **9' Wide stair**
- **Access to Imperial House drop off maintained**
- **Stair clears ECS duct bank**
- **5 Parking spaces removed**
- **2 Trees removed**

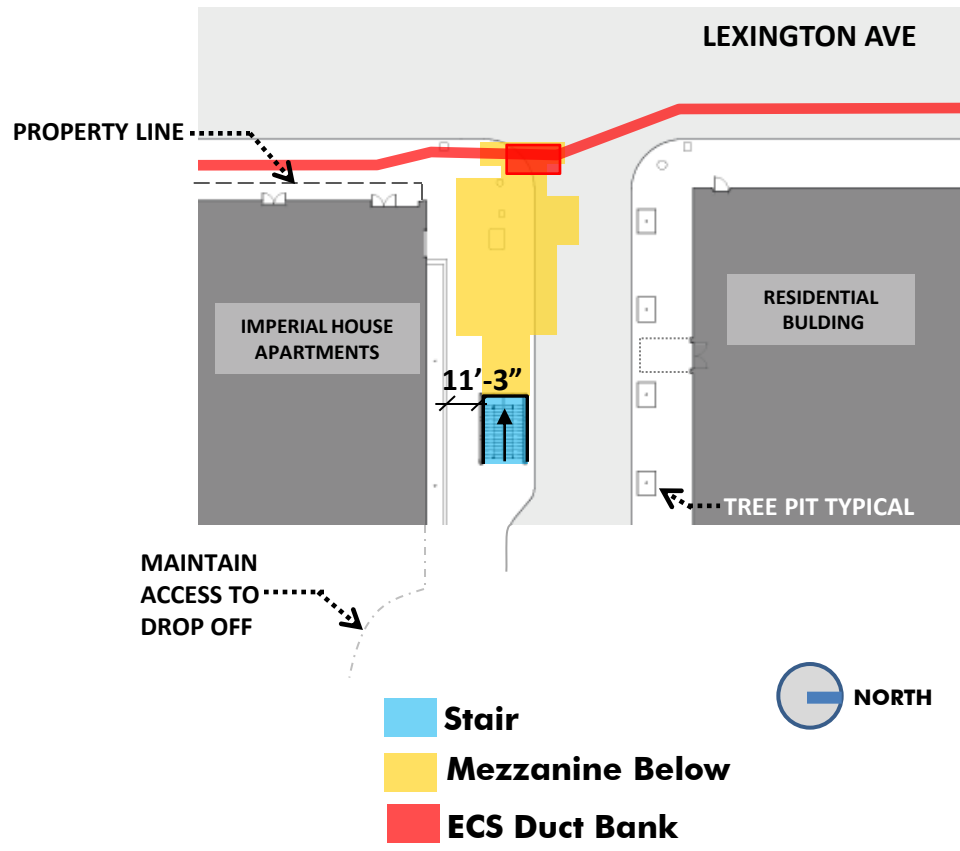



# 69TH STREET ENTRANCE STUDY - ALTERNATIVE E2

## SE CORNER

- 9' Wide stair
- Stair clears ECS duct bank
- 4 Parking spaces removed
- 1 Tree removed

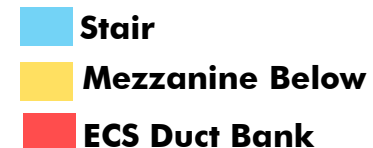
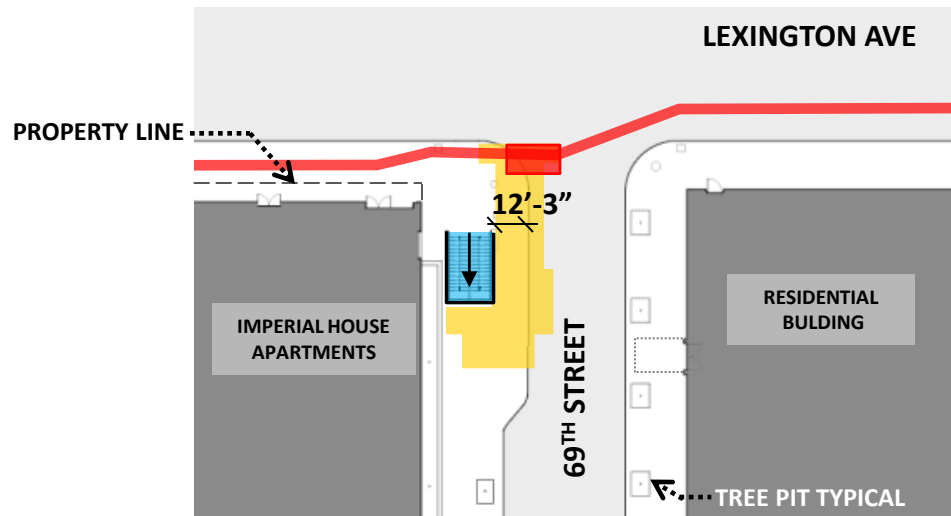

# NEW 69TH STREET LEVEL PLAN - ALTERNATIVE E3

## SE CORNER

- **Two 5' wide stairs**
- **Access to Imperial House drop off maintained**
- **Stair clears ECS duct bank**
- **No loss of parking space**
- **2 Trees removed**

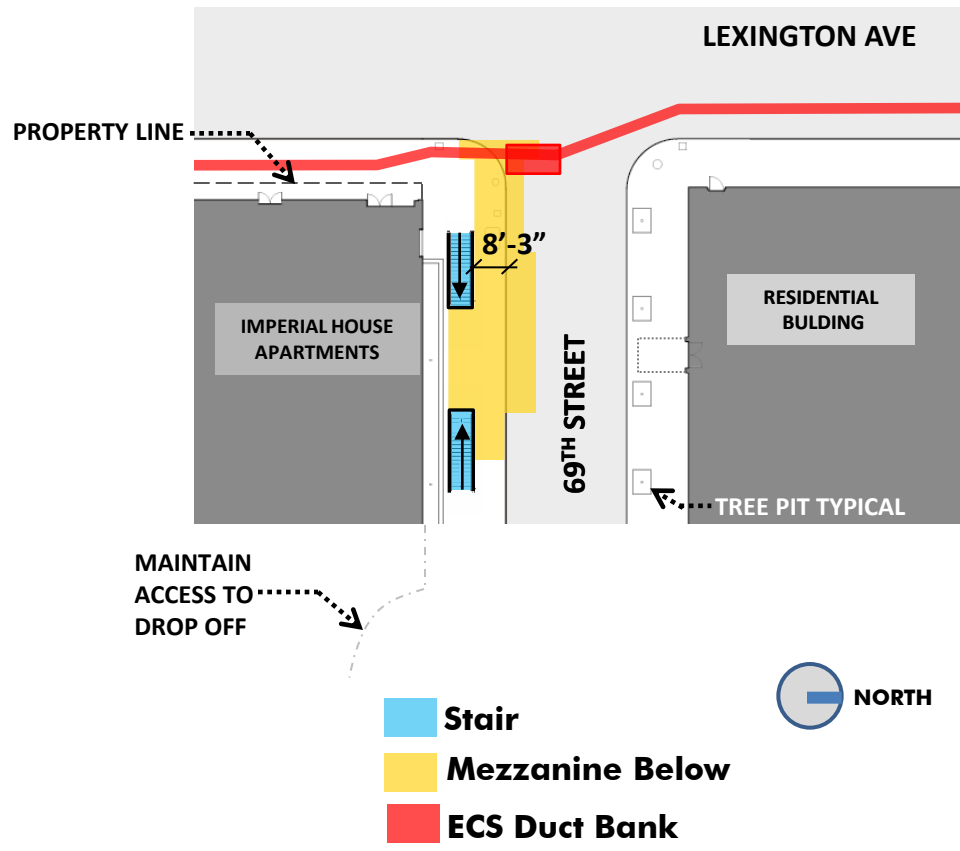

# 69TH STREET ENTRANCE STUDY - ALTERNATIVE E4

## SE CORNER

- **9' Wide stair**
- **8' Curb extension of Lex Ave required to accommodate stair**
- **Stair interferes with ECS duct bank below**
- **4 Parking spaces removed**
- **1 Tree removed**
- **Additional construction cost and duration**

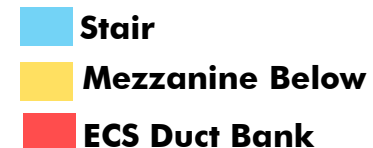
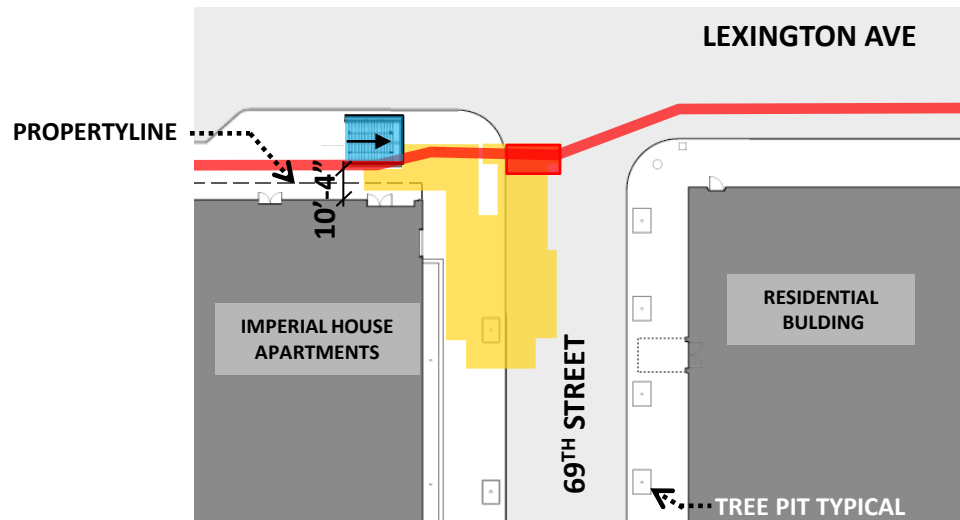

# 69TH STREET ENTRANCE STUDY - ALTERNATIVE E5

## NE CORNER

- 9' Wide stair
- Stair clears ECS duct bank
- 8' Curb extension of Lex Ave required to accommodate stair
- 4 Parking spaces removed
- 2 Trees removed
- Additional construction cost and duration

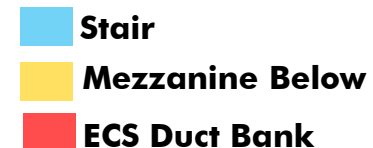
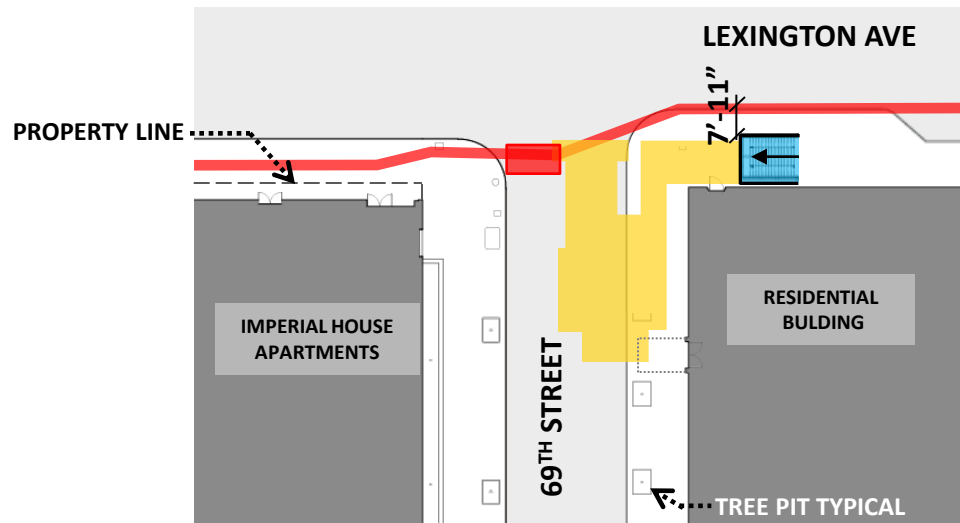

# 69TH STREET ENTRANCE STUDY - ALTERNATIVE E6

## NE/SE CORNER

- **Two 5' wide stairs**
- **8' Curb extension of Lex Ave required to accommodate stair**
- **Stair interferes with ECS duct bank below**
- **8 Parking spaces removed**
- **2 Trees removed**
- **Additional construction cost and duration**

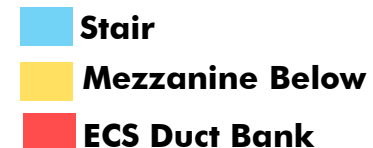
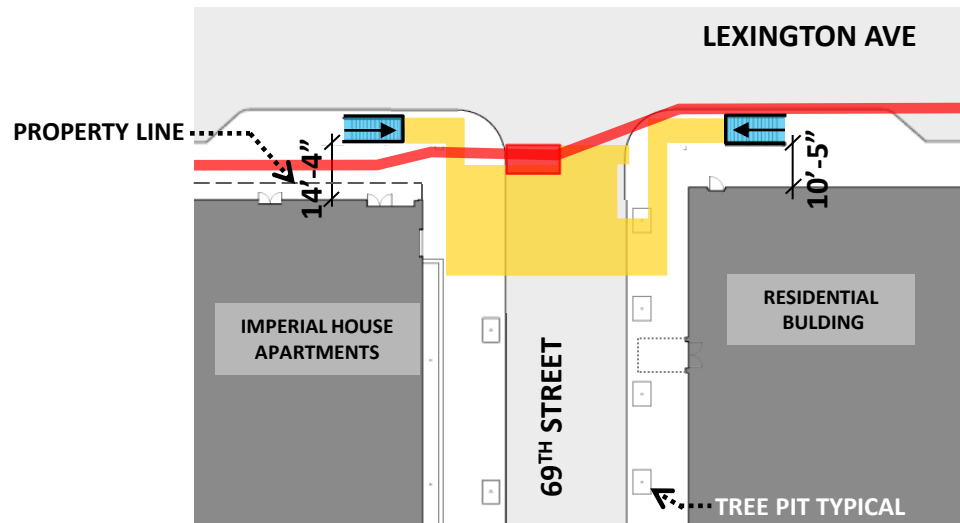

# 69TH STREET ENTRANCE STUDY - ALTERNATIVE E7

## NE CORNER

- 9' Wide stair
- Stair clears ECS duct bank
- 4 Parking spaces removed
- 2 Trees removed

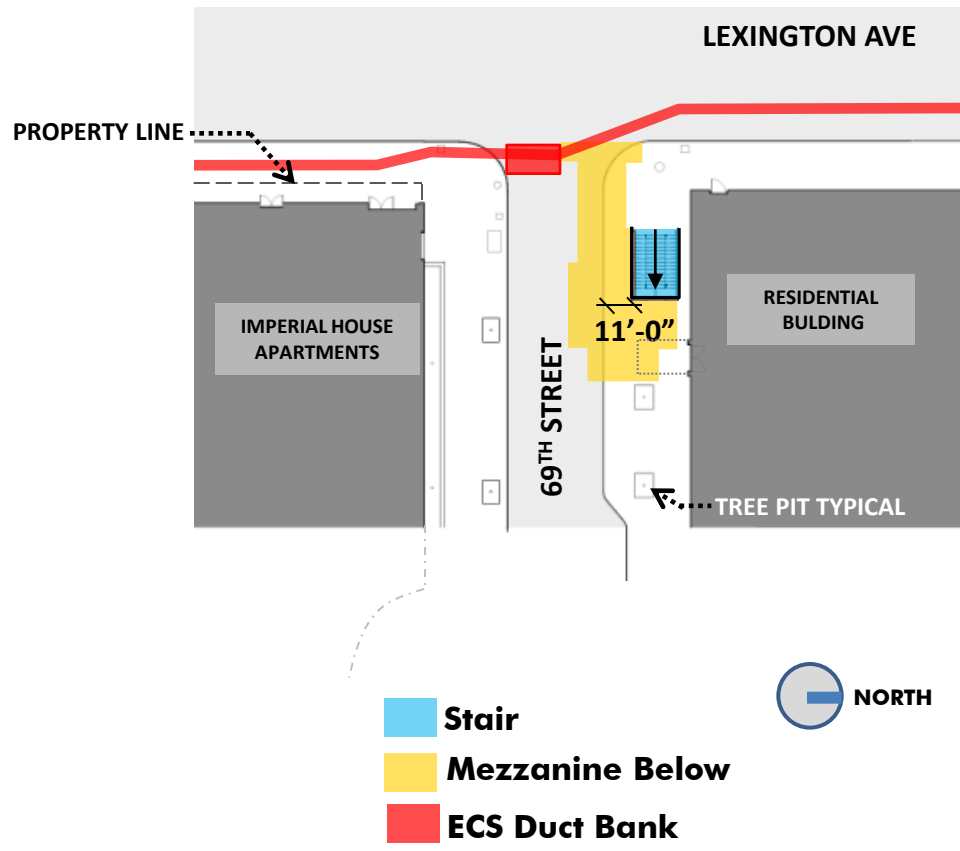

# 69TH STREET ENTRANCE STUDY - ALTERNATIVE E8

## NE CORNER

- 9' Wide stair
- Stair clears ECS duct bank
- 5 Parking spaces removed
- 3 Trees removed

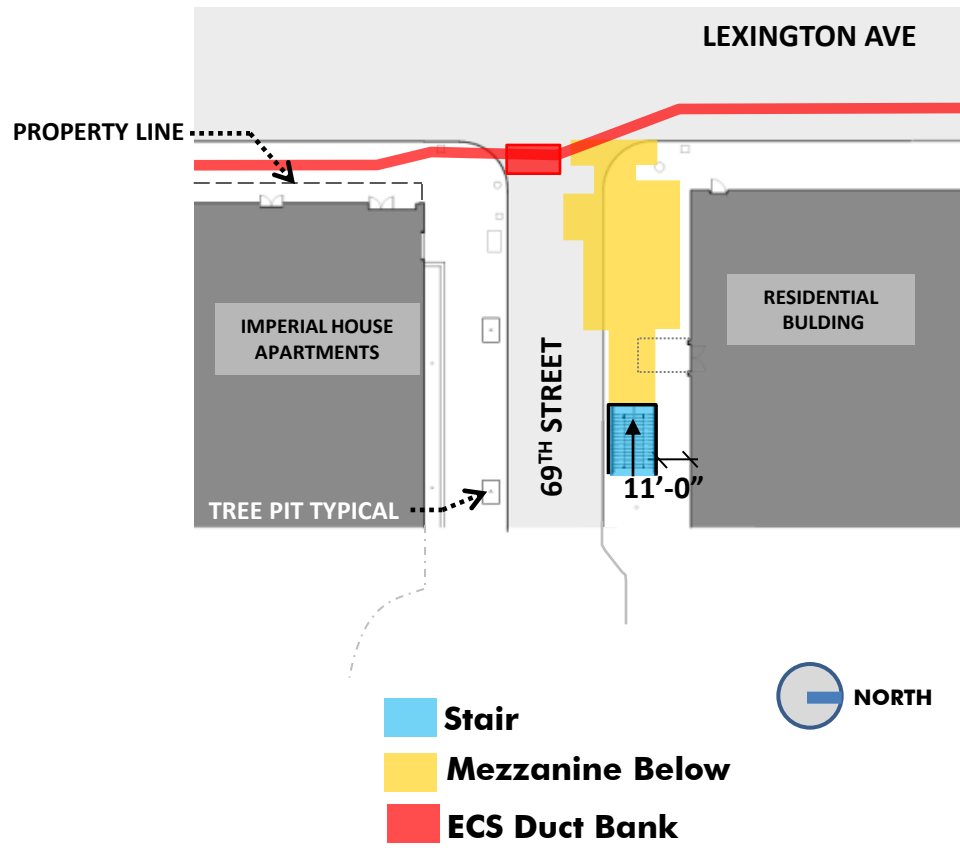

# 69TH STREET ENTRANCE STUDY - ALTERNATIVE E9

## NE CORNER

- Two 5' wide stairs
- Stair clears ECS duct bank
- 5 Parking spaces removed
- 3 Trees removed

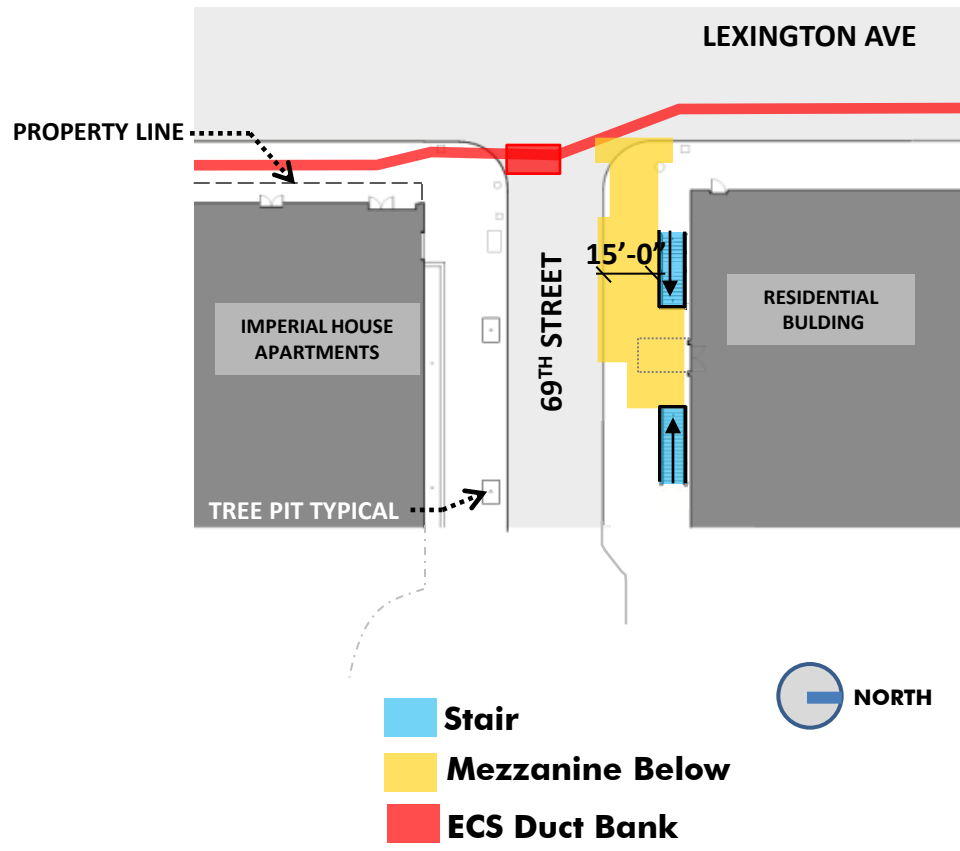



# STAIR ALTERNATIVES – EAST OF LEXINGTON AVE

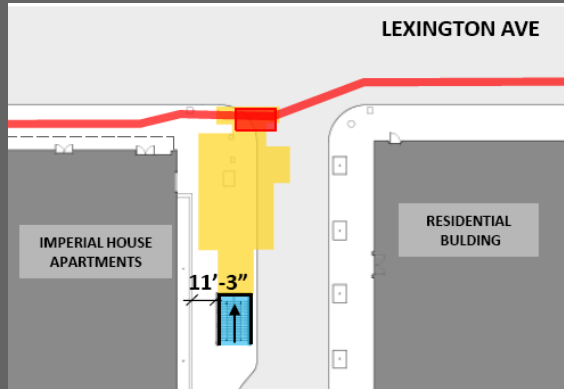

E1

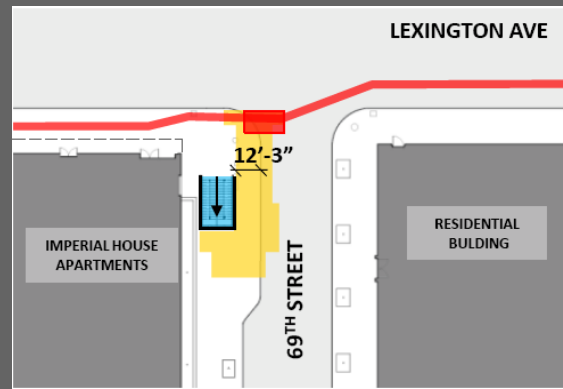

E2

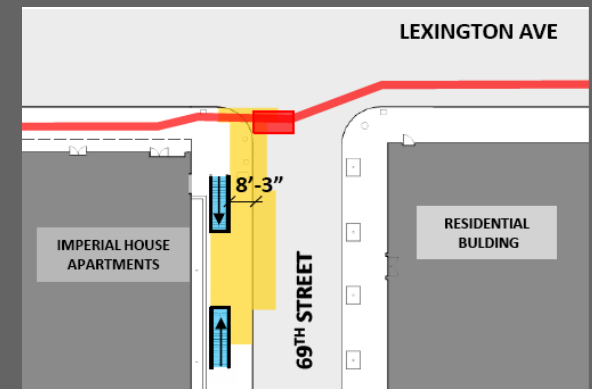

E3

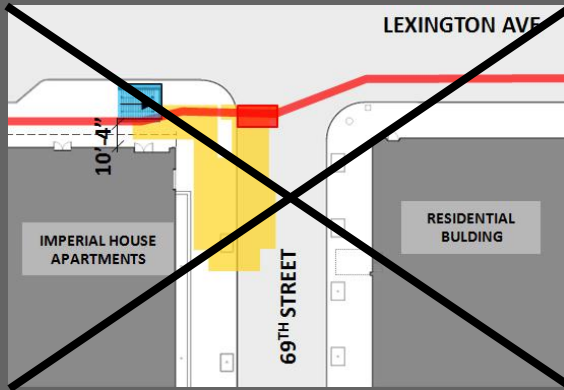

E4

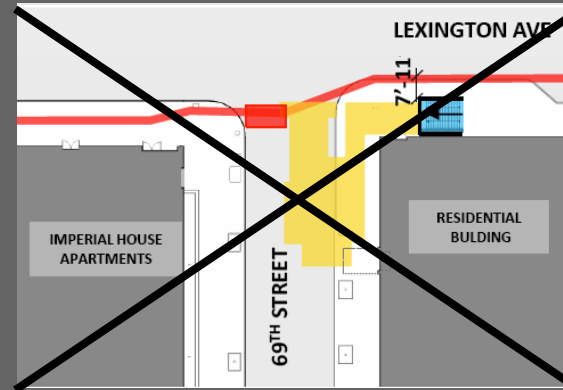

E5

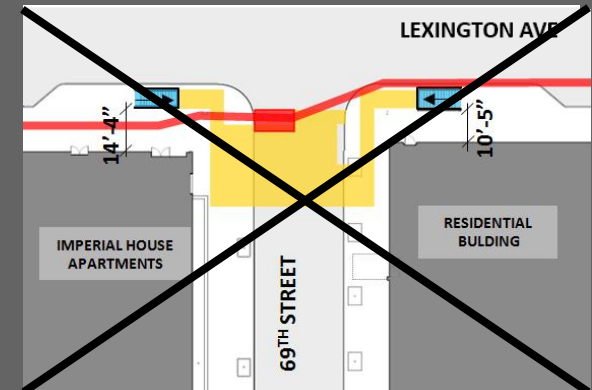

E6

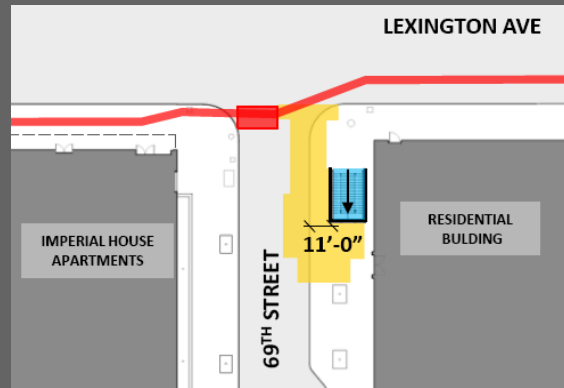

E7

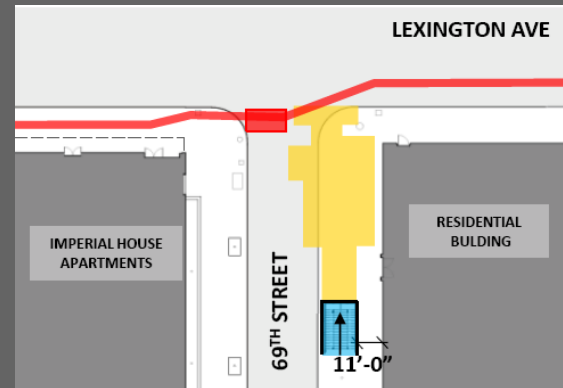

E8

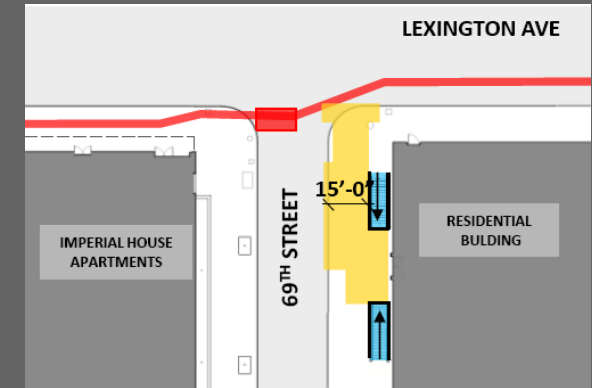

E9

# ENTRANCE STUDY ALTERNATIVE AT 70<sup>TH</sup> STREET

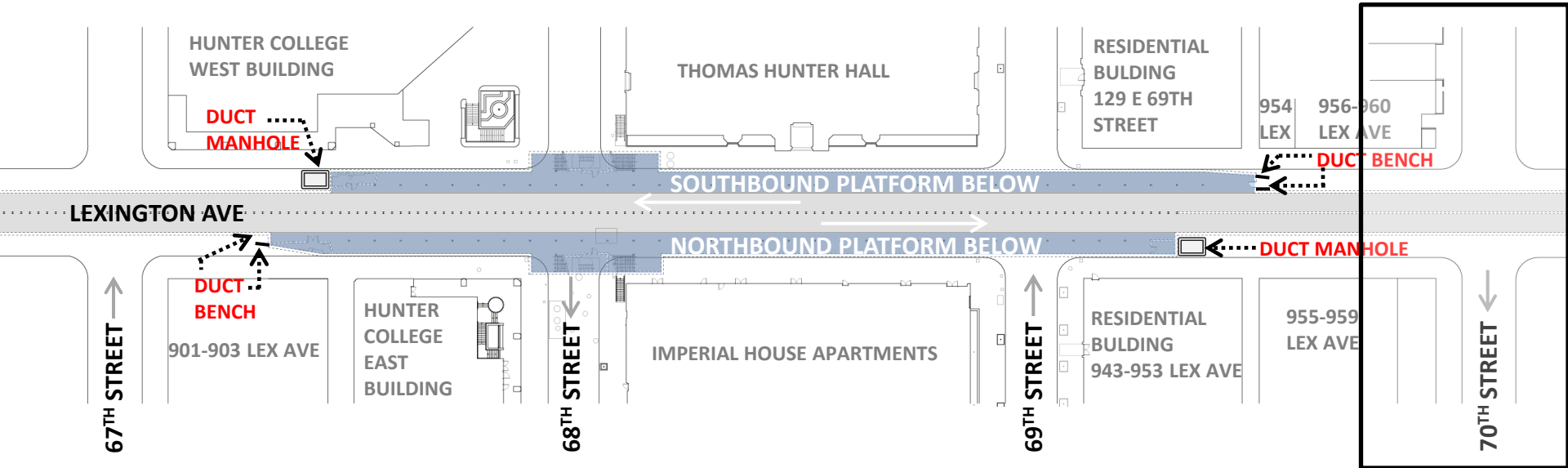

# ENTRANCE STUDY ALTERNATIVE AT 70<sup>TH</sup> STREET

## 70<sup>TH</sup> STREET

- **Two 9' wide stairs**
- **Clears ECS duct bank**
- **No access to platform possible**
- **Utility Interference: Subway duct manhole and duct bench**
- **9 Parking spaces removed on both sides of Lexington Ave**

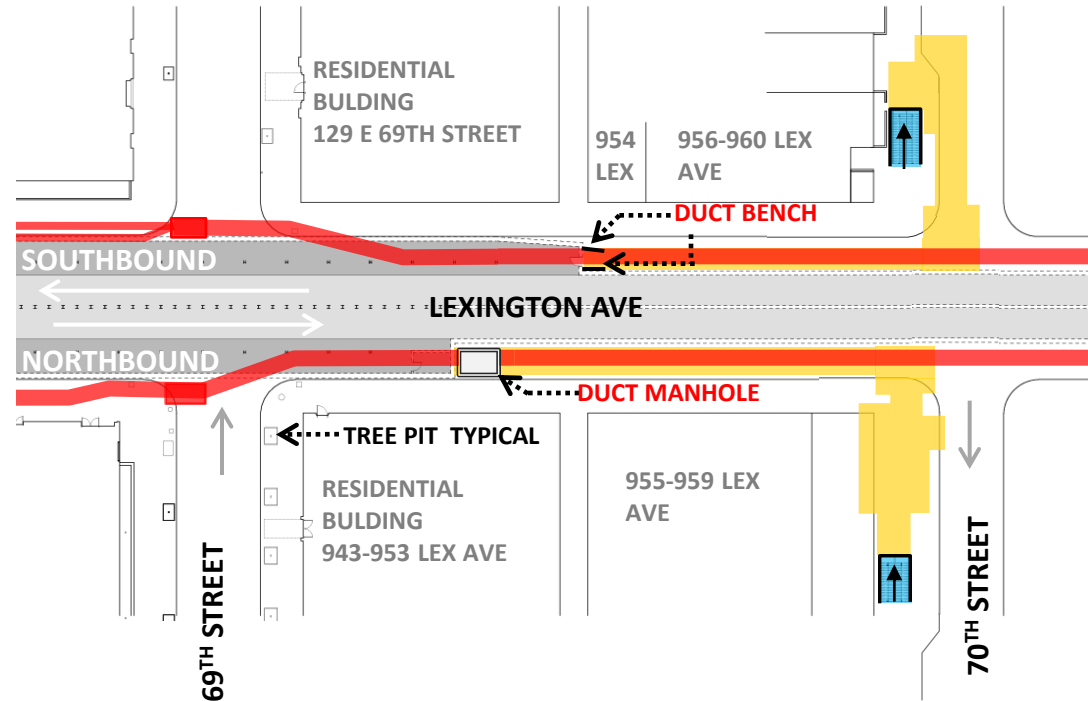

# **NEXT STEP: Environmental Assessment**

- **Pedestrian Analysis**
- **Examination of Potential Impacts:**
  - » **Historic Resources**
  - » **Construction**
  - » **Community Character**
  - » **Noise and Other Potential Impacts**
- **Identification of Preferred Alternative**
- **Public Hearing and Comment Period**

# **SCHEDULE**

- **Target Award: 4<sup>th</sup> Quarter of 2012**
- **Construction Duration: 38 Months**
- **Project Cost: \$57 Million**



# **ADA ELEVATORS AT 68TH STREET STATION**

LEXINGTON AVENUE LINE (IRT)  
BOROUGH OF MANHATTAN